

ROUTE NO.	SECTION	COUNTY	TOTAL SHEETS	SHEET NO.
FAP 627	1 BR	LaSALLE	46	13

ILLINOIS
CONTRACT NO. 66364

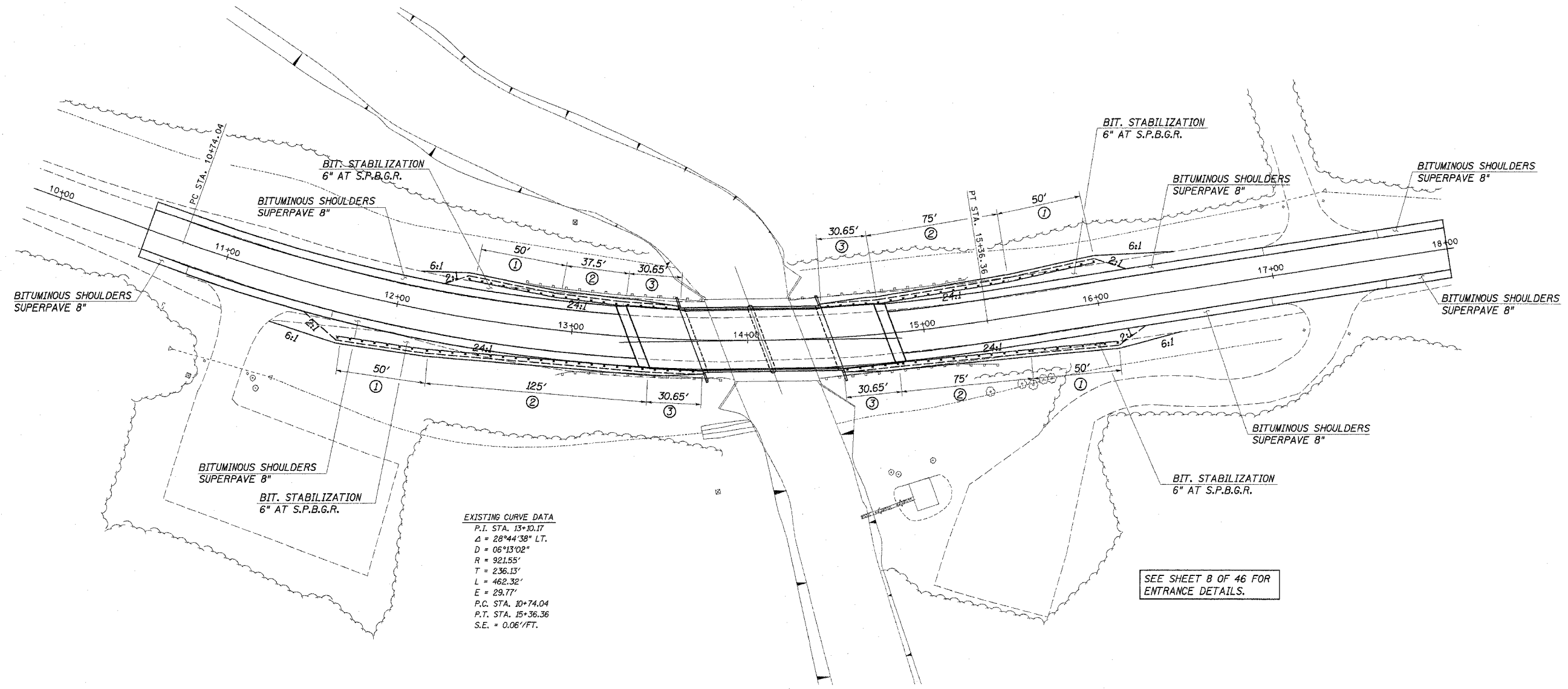
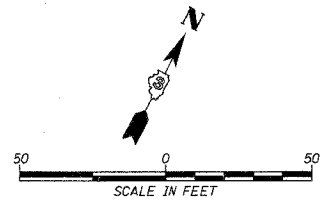

EXISTING CURVE DATA
 P.I. STA. 13+10.17
 $\Delta = 28^{\circ}44'38''$ LT.
 $D = 06^{\circ}13'02''$
 $R = 921.55'$
 $T = 236.13'$
 $L = 462.32'$
 $E = 29.77'$
 P.C. STA. 10+74.04
 P.T. STA. 15+36.36
 $S.E. = 0.06'/FT.$

LEGEND

- ① TRAFFIC BARRIER TERMINAL, TYPE 1 SPECIAL (TANGENT)
(USE APPLICABLE PORTIONS OF STD. 630301 FOR SHOULDER WIDENING.)
- ② STEEL PLATE BEAM GUARDRAIL, TYPE A
- ③ TRAFFIC BARRIER TERMINAL, TYPE 6

**GUARDRAIL AND SHOULDER
 WIDENING DETAIL**
 IL. RTE. 71 OVER UNNAMED STREAM
 F.A.P. RTE. 627 - SECTION 1BR
 LaSALLE COUNTY
 STA. 14+08.00
 STR. NO. 050-0244

4440 ASH GROVE SPRINGFIELD, IL. 62707 (217) 793-8600 oasinc@famvid.com	OZYURT AND STONE, INC. CONSULTING ENGINEERS	JOB NO.: 0306.4 FILE: GR-SHLDR.DGN DATE: 07-20-05
---	---	---