

F.A.S. RTE	SECTION	COUNTY	TOTAL SHEETS	SHEET NO.
1317	109 BRN	KANKAKEE	58	13
STA.		TO STA.		
FED. ROAD DIST. NO. ILLINOIS		FED. AID PROJECT		

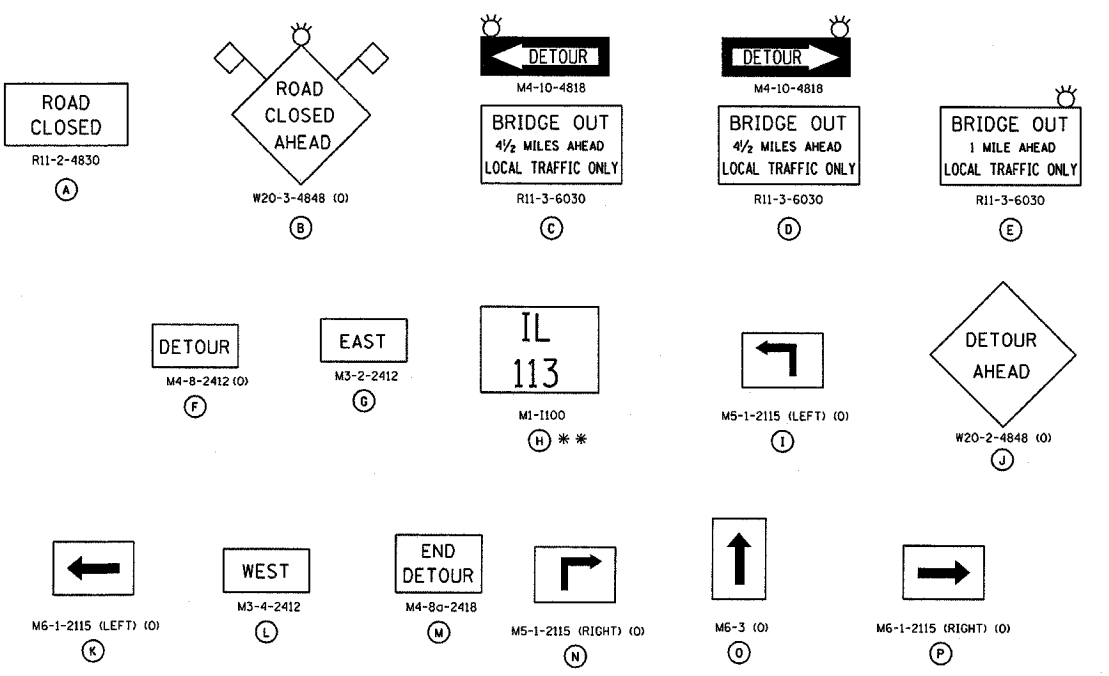
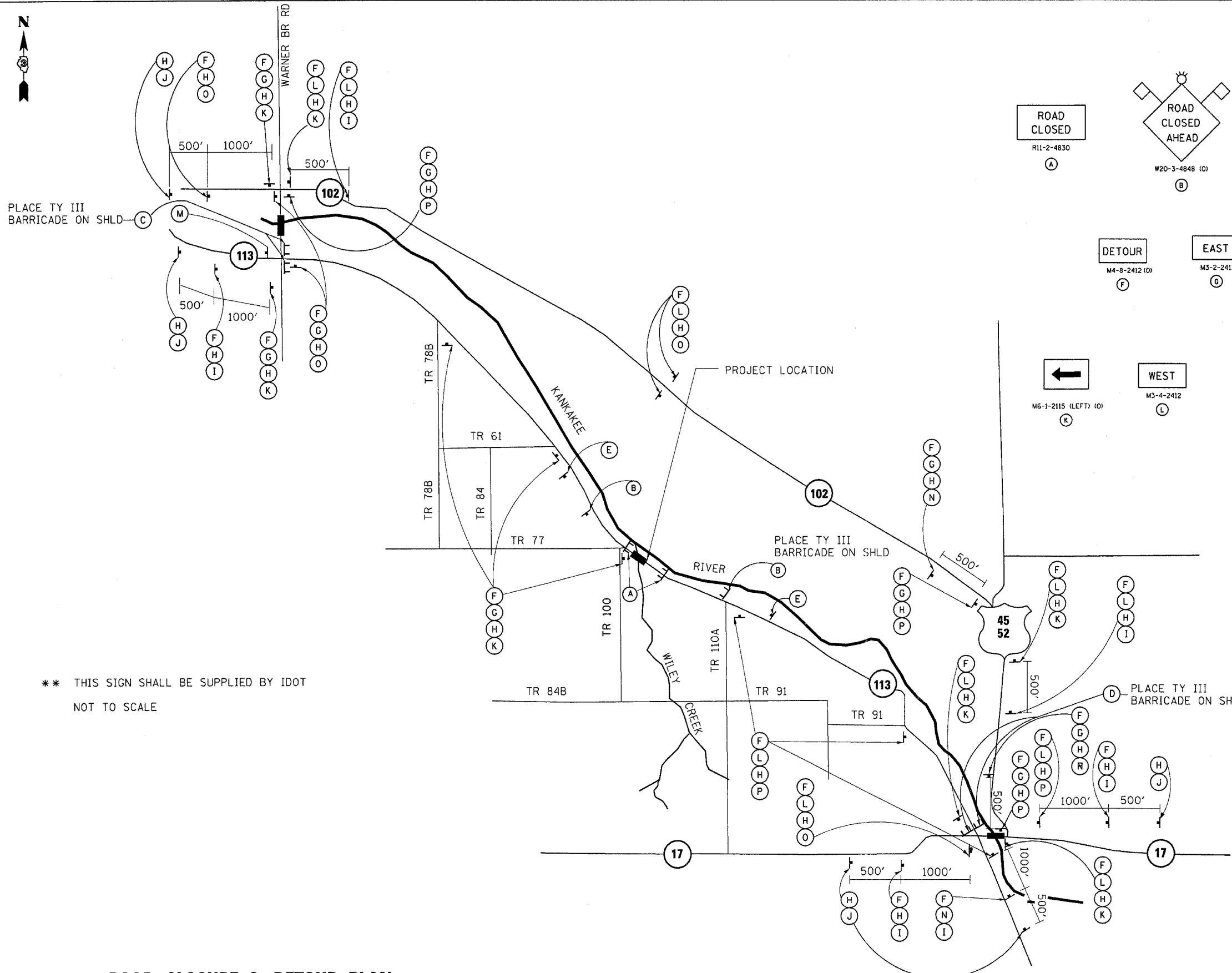

- LEGEND**
- TT TYPE III BARRICADES CONFORMING TO STD. 702001 "ROAD CLOSED TO ALL TRAFFIC" WITH 2 FLASHING LIGHTS PER BARRICADE
  - SIGNS ON PERMANENT SUPPORTS
  - ⚡ FLASHING LIGHT ABOVE SIGN
  - ◇ 18"x18" ORANGE FLAG

- GENERAL NOTES**
1. ALL TRAFFIC CONTROL DEVICES SHALL BE FURNISHED, ERECTED AND MAINTAINED BY THE CONTRACTOR.
  2. ALL SIGNS NOT ATTACHED TO BARRICADES SHALL BE POST MOUNTED, UNLESS NOTED OTHERWISE.
  3. LOCATIONS OF TRAFFIC CONTROL DEVICES MAY BE ADJUSTED BY THE ENGINEER.
  4. ALL TRAFFIC CONTROL SHOWN ON THIS SHEET SHALL BE PAID FOR PER LUMP SUM FOR TRAFFIC CONTROL AND PROTECTION FOR TEMPORARY DETOUR OTHER ITEMS REQUIRED BY THE ENGINEER AND NOT SHOWN ON THIS DRAWING SHALL BE INCLUDED IN THE PAY ITEM AND NO ADDITIONAL COMPENSATION WILL BE ALLOWED.
  5. THE ILLINOIS DEPARTMENT OF TRANSPORTATION WILL SUPPLY ALL IL 113 SIGNS FOR THIS DETOUR. THE CONTRACTOR SHALL NOTIFY DISTRICT 3 BUREAU OF OPERATIONS 14 CALENDAR DAYS PRIOR TO PLACING THE DETOUR.

\*\*\* THIS SIGN SHALL BE SUPPLIED BY IDOT  
NOT TO SCALE

**ROAD CLOSURE & DETOUR PLAN**

REVISIONS	
NAME	DATE

ILLINOIS DEPARTMENT OF TRANSPORTATION  
**TRAFFIC CONTROL & PROTECTION FOR TEMPORARY DETOUR**  
SCALE: VERT. \_\_\_\_\_  
DATE \_\_\_\_\_ HORIZ. \_\_\_\_\_  
DRAWN BY \_\_\_\_\_  
CHECKED BY \_\_\_\_\_