

ROUTES	SECTION	COUNTY	TOTAL SHEETS	SHEET NO.
FAI 55 & FAP 673	D-3 BRIDGE PAINTING 2005-2	LIVINGSTON	17	10
ILLINOIS				

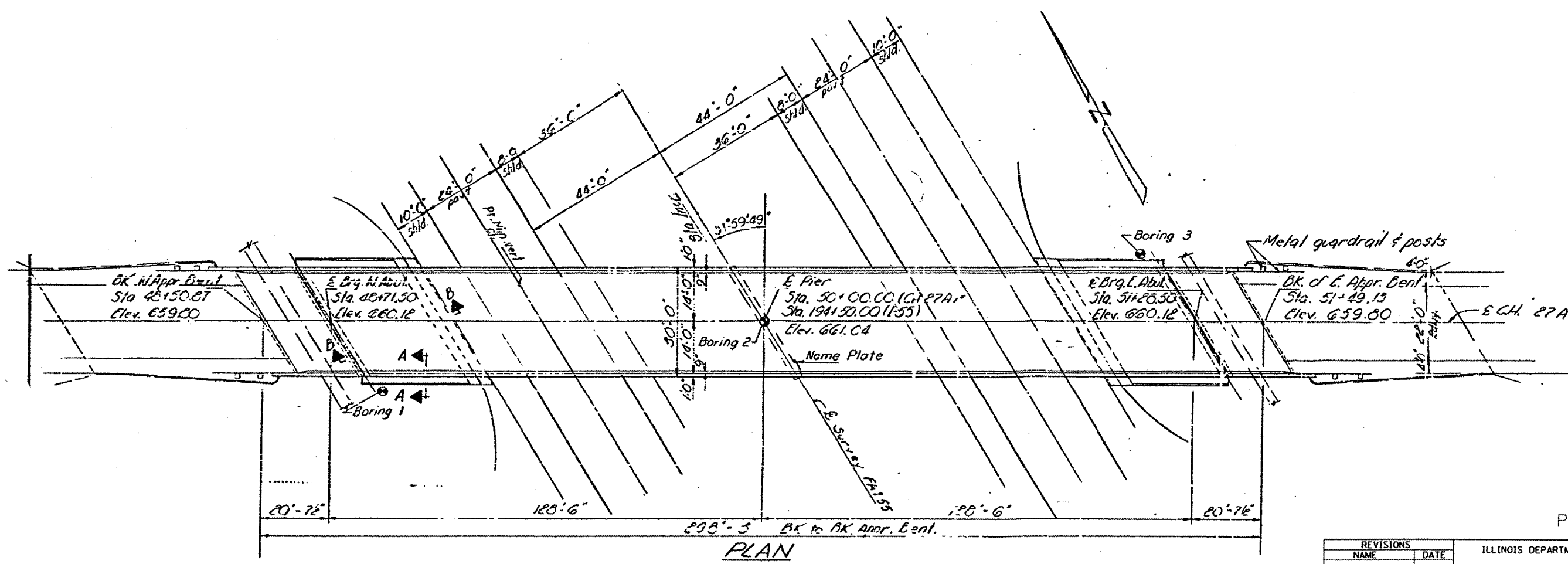
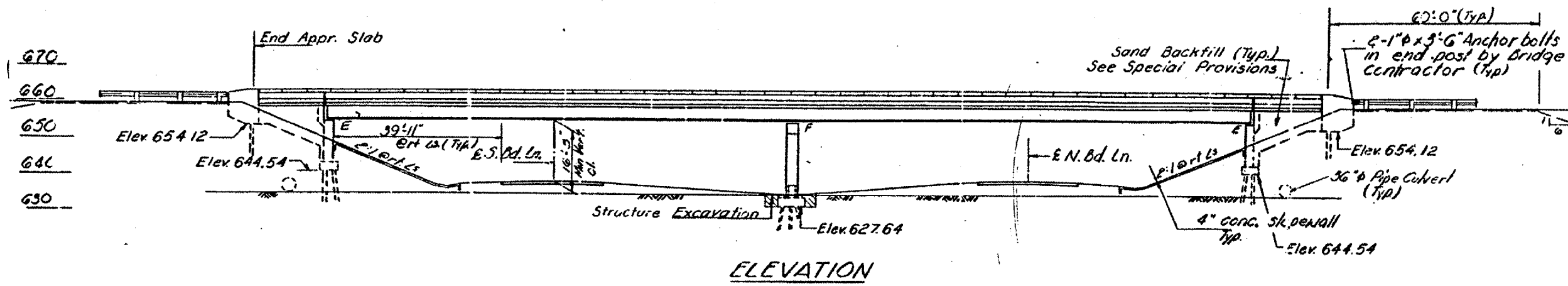

Date: 03/23/05
 c:\projects\bridgepaint\05\bp2005-2\details.dgn

FOR INFORMATION ONLY

REVISIONS	
NAME	DATE

ILLINOIS DEPARTMENT OF TRANSPORTATION
**EXISTING STRUCTURE
 LOCATION #2
 S.N. 053-0130**