

| F.A.S. RTE. | SECTION | COUNTY | TOTAL SHEETS | SHEET NO. |
|---------------------|--------------|---------------------------|--------------|-----------|
| 1774 | 113(B-5,B-6) | LOGAN | 60 | 17 |
| STA. | | TO STA. | | |
| FED. ROAD DIST. NO. | | ILLINOIS FED. AID PROJECT | | |

STA 1723+50
 TOTAL STRUCTURE REPLACEMENT
 EXISTING SN 054-0019
 PROPOSED SN 054-0505

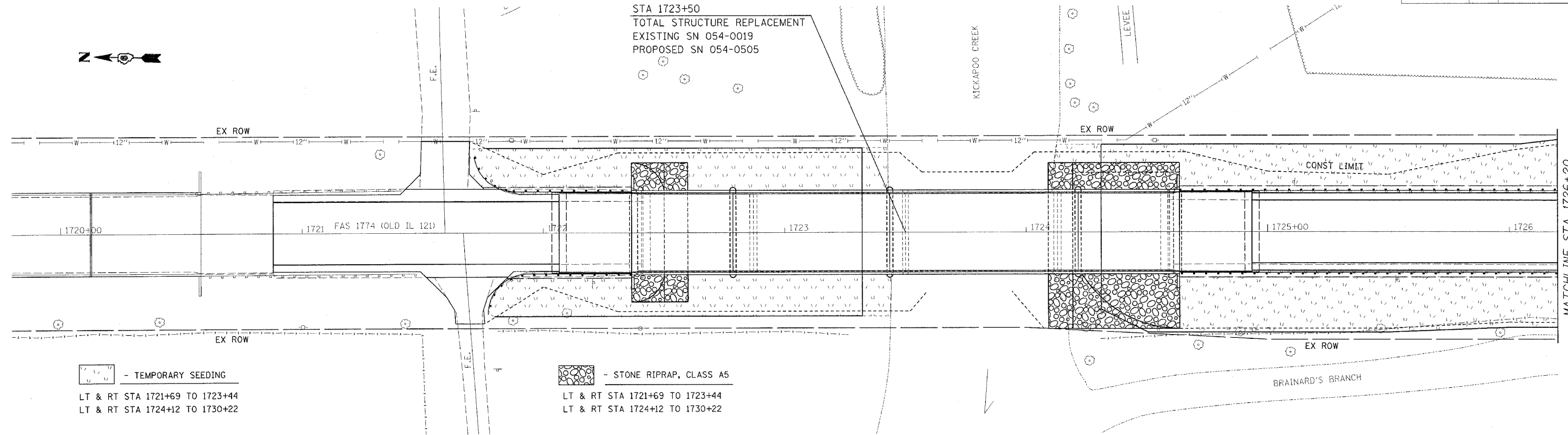

- TEMPORARY SEEDING
 LT & RT STA 1721+69 TO 1723+44
 LT & RT STA 1724+12 TO 1730+22

- STONE RIPRAP, CLASS A5
 LT & RT STA 1721+69 TO 1723+44
 LT & RT STA 1724+12 TO 1730+22

STA 1723+50
 EXISTING SN 054-2013
 PROPOSED SN 054-2506

- STONE RIPRAP, CLASS A4
 LT & RT STA 1727+67 TO 1728+07

- PERIMETER EROSION BARRIER
 LT & RT STA 1721+76 TO 1723+32
 LT & RT STA 1724+31 TO 1730+22

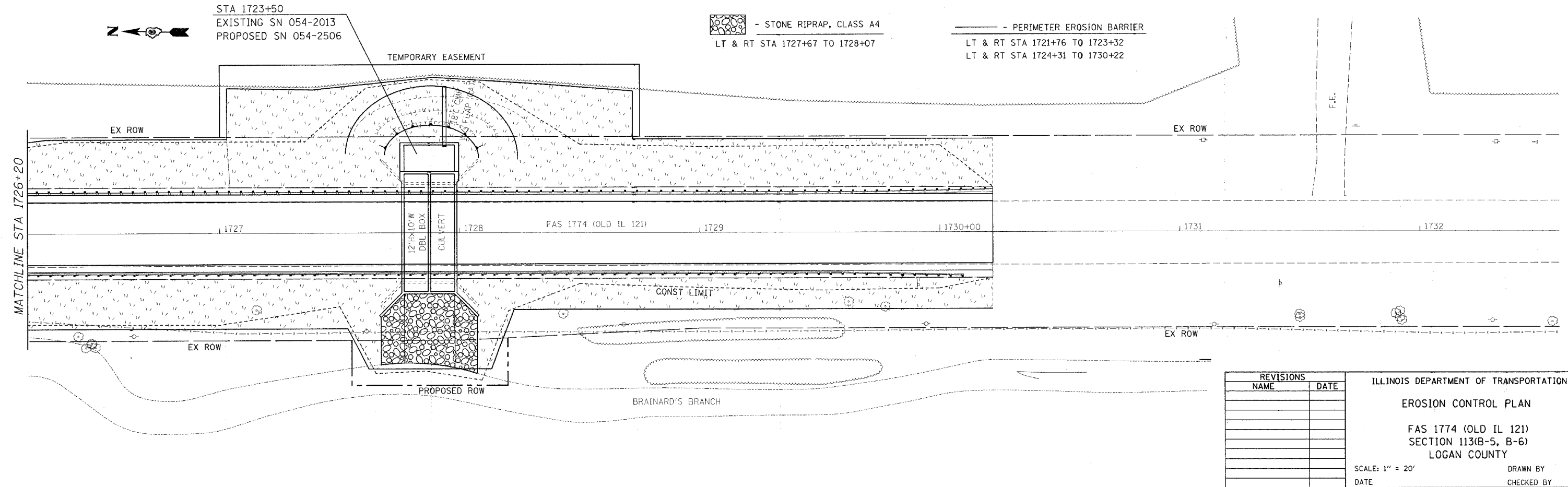

TEMPORARY EASEMENT

12'x10'w
 DBL BOX
 CULVERT

| REVISIONS | |
|-----------|------|
| NAME | DATE |
| | |
| | |
| | |
| | |
| | |
| | |
| | |
| | |
| | |
| | |

ILLINOIS DEPARTMENT OF TRANSPORTATION
 EROSION CONTROL PLAN
 FAS 1774 (OLD IL 121)
 SECTION 113(B-5, B-6)
 LOGAN COUNTY
 SCALE: 1" = 20'
 DATE _____ DRAWN BY _____
 CHECKED BY _____

PLOT DATE = 9/2/2005
 FILE NAME = c:\projects\113(B-5,B-6)\erosion.dgn
 PLOT SCALE = 20.0000 1/1 IN.
 USER NAME = ccorne