

F.A.I. RTE.	SECTION	COUNTY	TOTAL SHEETS	SHEET NO.
70	82-(L,2)T-17	ST. CLAIR	77	5
FED. ROAD DIST. NO.		ILLINOIS	FED. AID PROJECT	

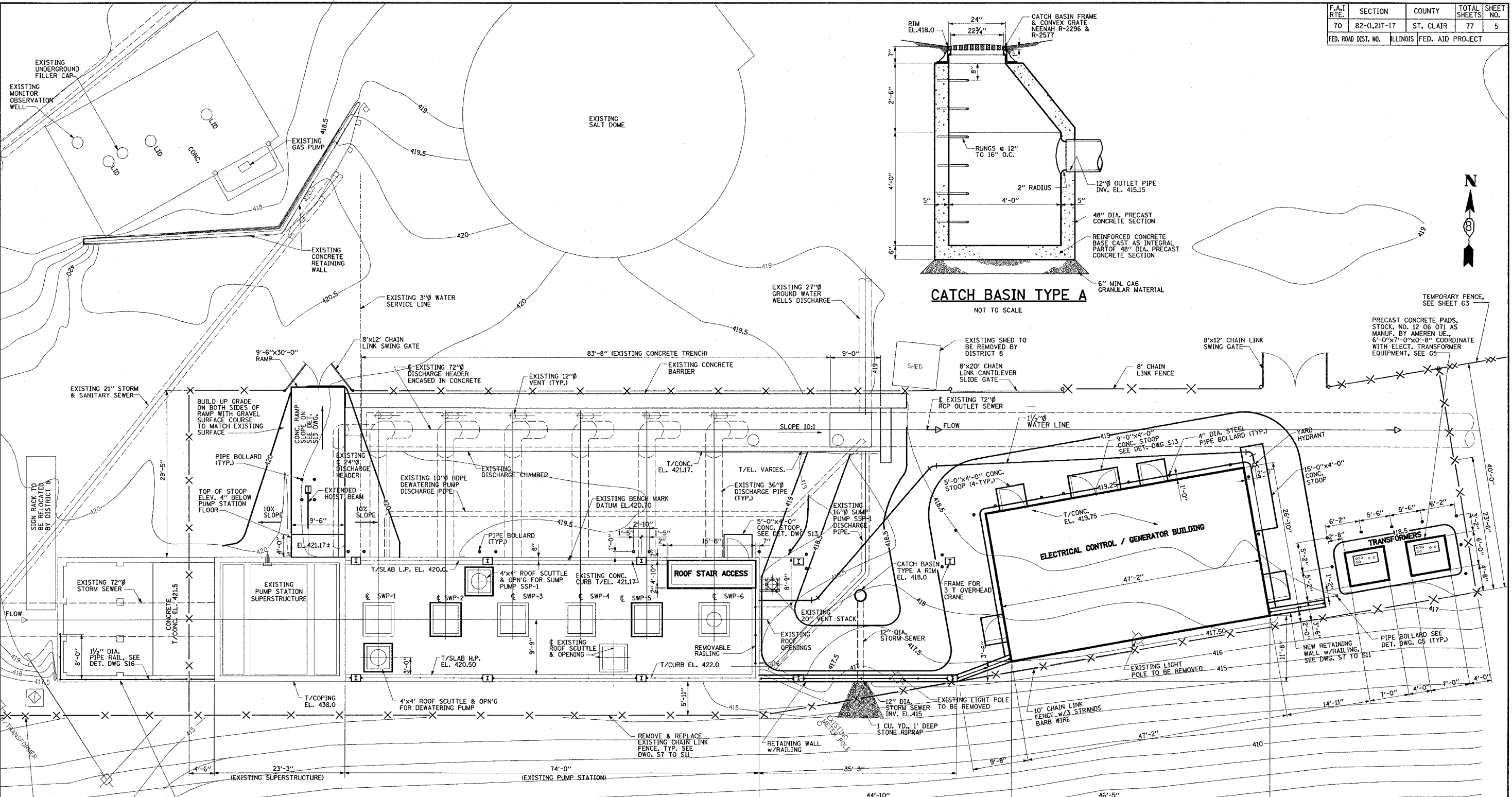

ENLARGED SITE PLAN-EL. 422.0

NOTES:

- FOR STRUCTURAL & MECHANICAL DEMOLITION PLAN, SEE DM1 THROUGH DM4 DWG.
- FOR ELECTRICAL DEMOLITION PLANS, SEE DM3 AND E3 THRU E6 DWGS.
- CONTOUR ELEVATIONS AND NEW BUILDING ELEVATIONS ARE BASED ON BENCH MARK DATUM.
- EXISTING PUMP STATION AND DISCHARGE CHAMBER ELEVATIONS ARE BASED ON ORIGINAL DESIGN DRAWING ELEVATIONS. SUBTRACT 0.47 FEET FROM PUMP STATION STRUCTURE ELEVATIONS TO CONVERT TO BENCH MARK DATUM ELEVATION. THE PROPOSED ELEVATIONS, SUCH AS CONTOUR LINE AND FINISHED FLOOR ELEVATION OF ELECTRICAL CONTROL GENERATOR BUILDING ARE TAKEN FROM BENCH MARK ELEVATION 420.70.
- FOR YARD HYDRANT DETAIL, SEE DWG. G5
- FOR TRANSFORMER FOUNDATION DETAIL, SEE DWG. G5
- FOR CONCRETE RAMP AND STOOP, SEE DWG S13 AND A2.
- FOR BOLLARD LOCATION SEE DWG A2 AND S7.

LEGEND:

- X- NEW CHAIN LINK FENCE
- XX- TEMPORARY CHAIN LINK FENCE
- - - - NEW WATER LINE

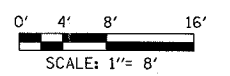

BENCH MARK:

A BRONZE DISK BENCH MARK IS LOCATED 40 FEET EAST OF THE NORTHEAST CORNER OF THE EXISTING PUMP STATION BUILDING ALONG THE NORTH WALL OF THE PUMP STATION. THIS BENCH MARK HAS DATUM ELEVATION OF 420.70.

ALVORD, BURDICK & HOWSON, L.L.C.
ENGINEERS CHICAGO

G4

REVISIONS	
NAME	DATE

ILLINOIS DEPARTMENT OF TRANSPORTATION
BOWMAN AVENUE PUMP STATION
REHABILITATION
PROPOSED SITE PLAN

SCALE: AS SHOWN
DATE: 09-12-05

DRAWN BY: CTM
CHECKED BY: KC

PLOT DATE: *DATE-TIME*

PLAN	BY	DATE
NO.		
1		
2		
3		
4		
5		
6		
7		
8		
9		
10		
11		
12		
13		
14		
15		
16		
17		
18		
19		
20		