

SECTION	COUNTY	TOTAL SHEETS	SHEET NO.
02-00034-00-BT	DUPAGE	108	17
STA.	TO STA.		
IDOT PROJECT NO. M-8003(216)			
SALT CREEK GREENWAY TRAIL			

CONTRACT NO. 83714

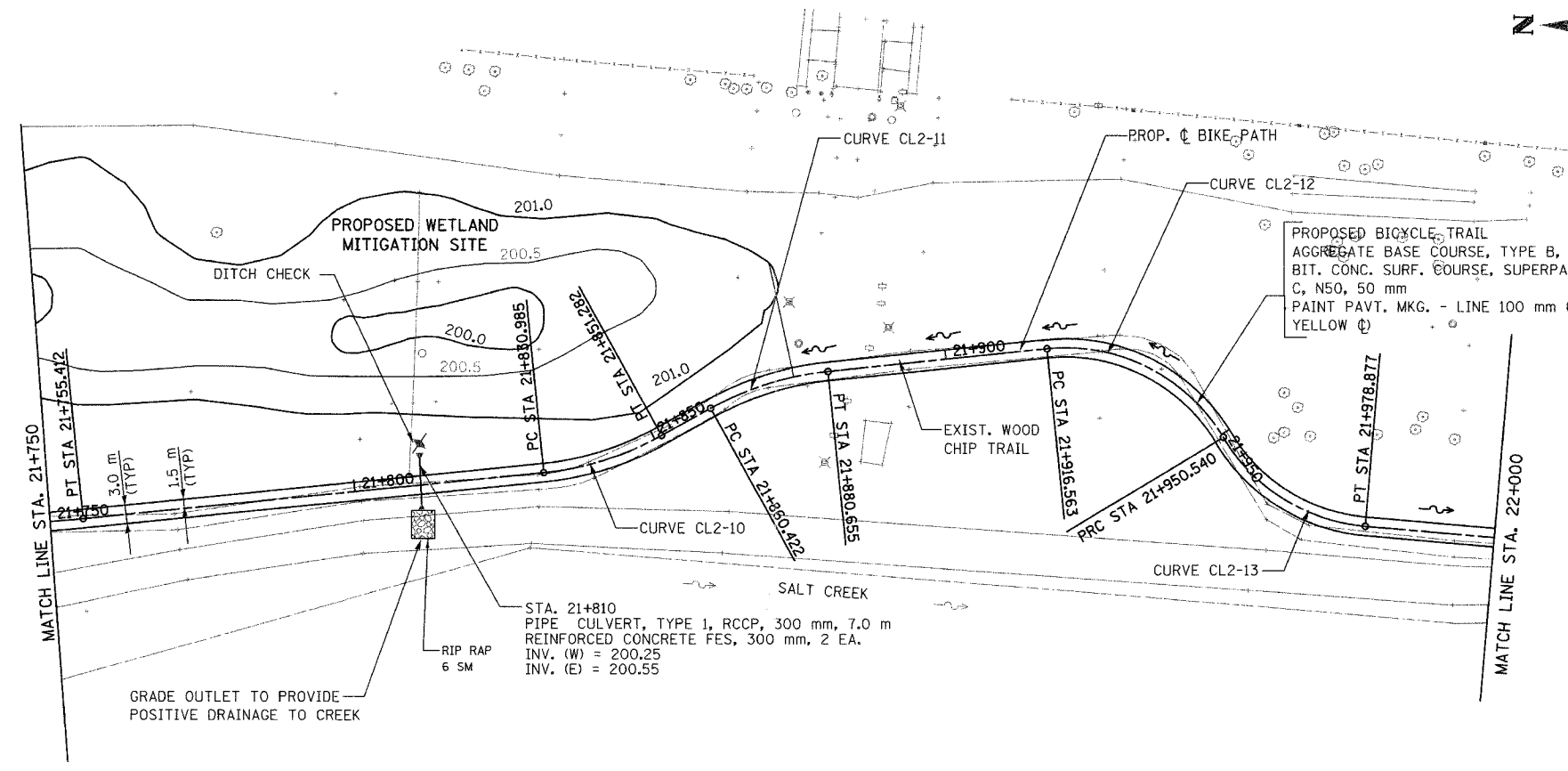

PROP. CURVE CL2-10	PROP. CURVE CL2-11
PI STA = 21+841.275	PI STA = 21+870.679
N = 42,346.754	N = 42,321.097
E = 7,681.745	E = 7,696.679
Δ = 23° 15' 34" (LT)	Δ = 23° 11' 05" (RT)
R = 50.000 m	R = 50.000 m
T = 10.291 m	T = 10.257 m
L = 20.298 m	L = 20.233 m
E = 1.048 m	E = 1.041 m

PROP. CURVE CL2-12	PROP. CURVE CL2-13
PI STA = 21+935.635	PI STA = 21+965.865
N = 42,256.348	N = 42,238.057
E = 7,704.647	E = 7,675.516
Δ = 64° 53' 29" (RT)	Δ = 54° 07' 05" (LT)
R = 30.000 m	R = 30.000 m
T = 19.072 m	T = 15.325 m
L = 33.977 m	L = 28.336 m
E = 5.549 m	E = 3.687 m

STA. 21+810
PIPE CULVERT, TYPE 1, RCCP, 300 mm, 7.0 m
REINFORCED CONCRETE FES, 300 mm, 2 EA.
INV. (W) = 200.25
INV. (E) = 200.55

RIP RAP
6 SM

GRADE OUTLET TO PROVIDE POSITIVE DRAINAGE TO CREEK

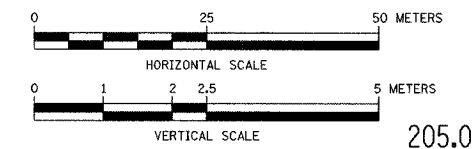

FOR LEGEND SEE SHEET NO. 15

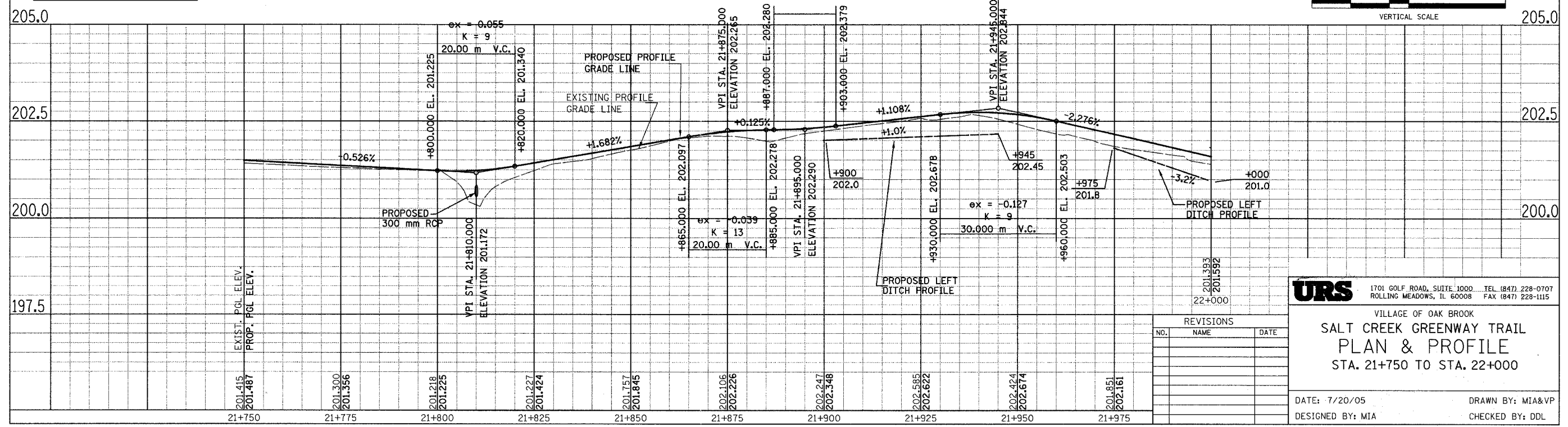

URS 1701 GOLF ROAD, SUITE 1000 TEL (847) 228-0707
ROLLING MEADOWS, IL 60008 FAX (847) 228-1115

VILLAGE OF OAK BROOK
**SALT CREEK GREENWAY TRAIL
PLAN & PROFILE**
STA. 21+750 TO STA. 22+000

REVISIONS		
NO.	NAME	DATE

DATE: 7/20/05
DESIGNED BY: MIA
DRAWN BY: MIA&VP
CHECKED BY: DDL