

PROP. CURVE CL2-19
 PI STA = 22+315.434
 N = 41,903.903
 E = 7,716.918
 $\Delta = 28^\circ 18' 59''$ (RT)
 R = 30.000 m
 T = 7.568 m
 L = 14.826 m
 E = 0.940 m

PROP. CURVE CL2-20
 PI STA = 22+346.506
 N = 41,876.354
 E = 7,731.945
 $\Delta = 41^\circ 11' 36''$ (RT)
 R = 30.000 m
 T = 11.274 m
 L = 21.569 m
 E = 2.049 m

SECTION	COUNTY	TOTAL SHEETS	SHEET NO.
02-00034-00-BT	DUPAGE	108	19
STA. TO STA.			
IDOT PROJECT NO. M-8003(216)			
SALT CREEK GREENWAY TRAIL			
CONTRACT NO. 83714			

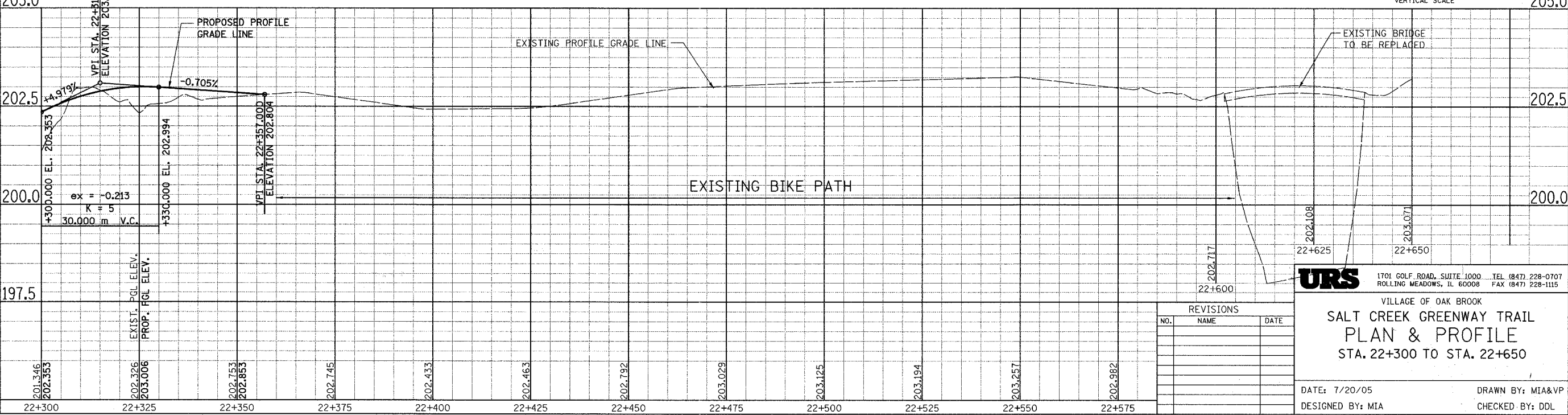
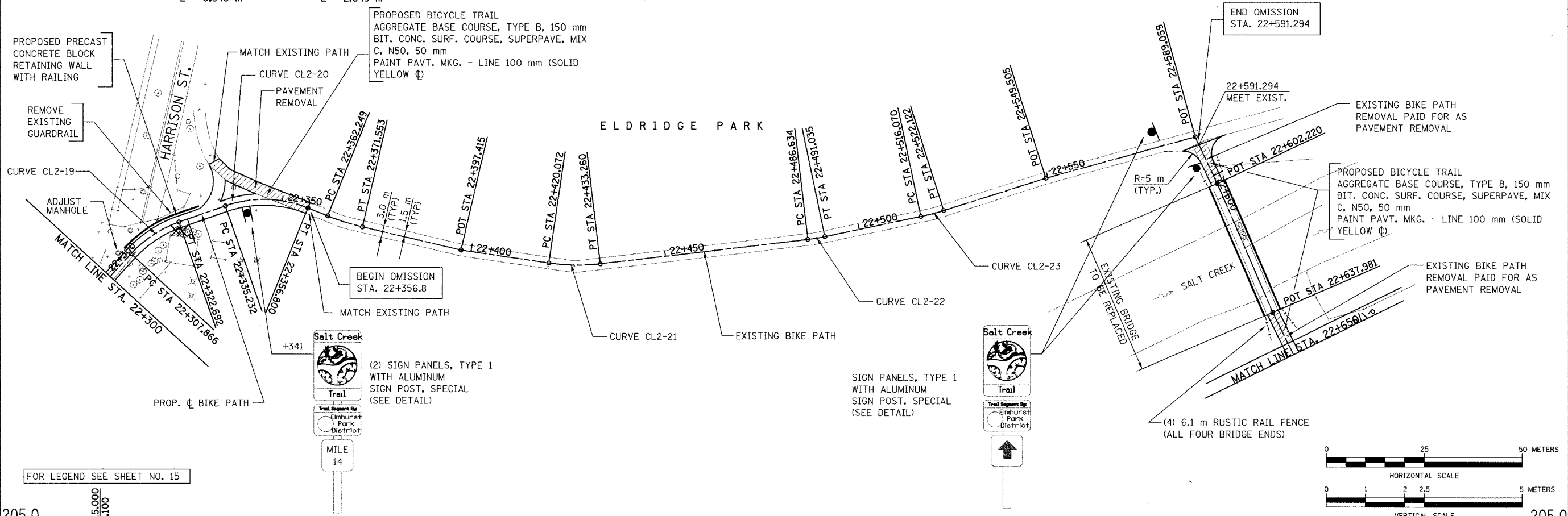

FOR LEGEND SEE SHEET NO. 15

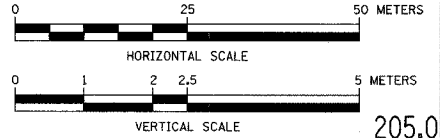

REVISIONS		
NO.	NAME	DATE

URS
 1701 GOLF ROAD, SUITE 1000 TEL (847) 228-0707
 ROLLING MEADOWS, IL 60008 FAX (847) 228-1115
 VILLAGE OF OAK BROOK
SALT CREEK GREENWAY TRAIL
PLAN & PROFILE
 STA. 22+300 TO STA. 22+650
 DATE: 7/20/05
 DESIGNED BY: MIA
 DRAWN BY: MIA&VP
 CHECKED BY: DDL