

F.A.P. RTE.	SECTION	COUNTY	TOTAL SHEETS	SHEET NO.
309	7BR-P	Whiteside	21	5
STA.		TO STA.		
FED. ROAD DIST. NO.		ILLINOIS	FED. AID PROJECT	

TRAFFIC CONTROL PLAN

Refer to Traffic Control and Protection Standard 701316 for additional requirements

Plan for Iowa Approach Spans

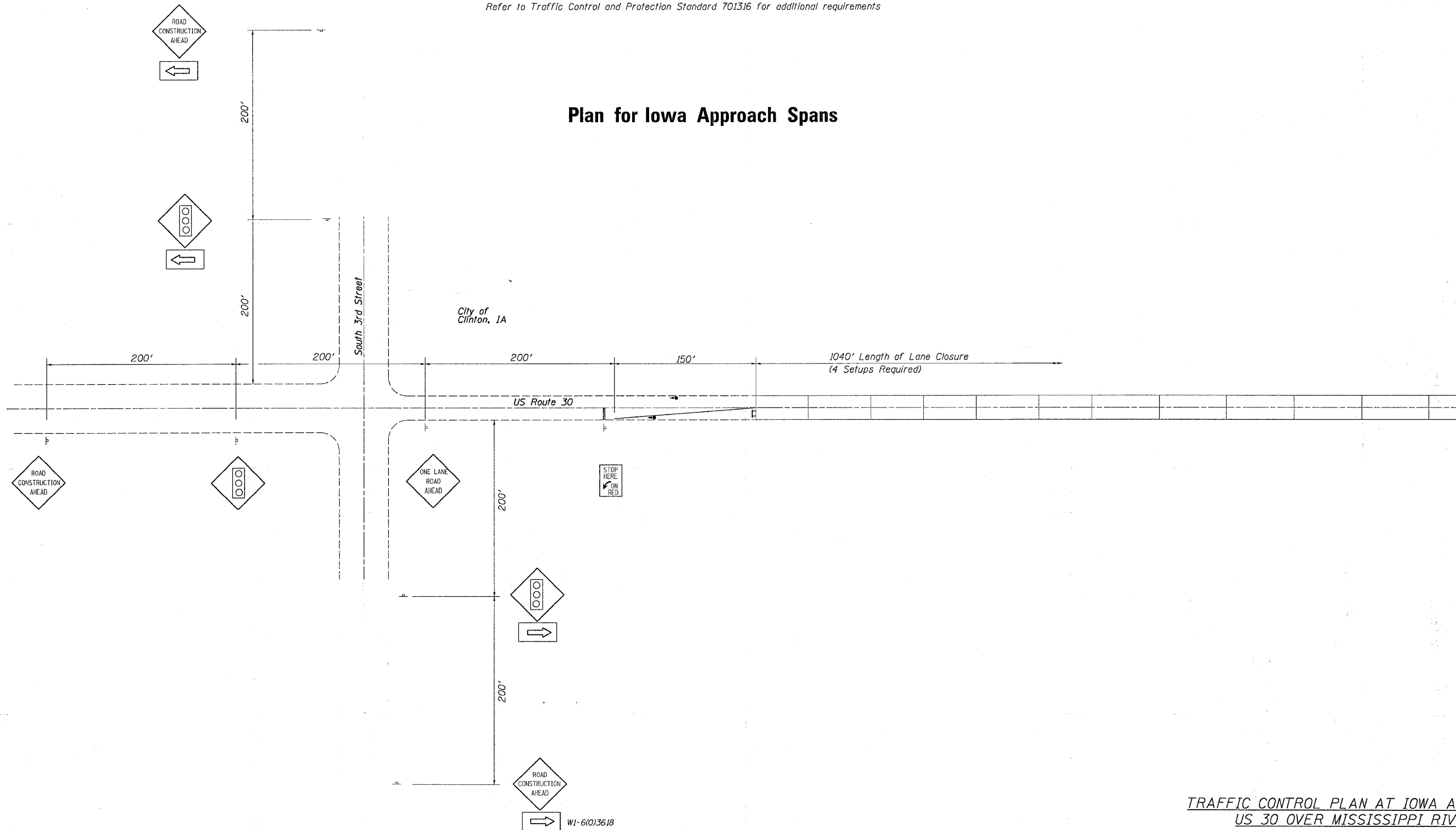

PLOT DATE = Tue Aug 30 07:57:37 2005
 FILE NAME = D:\BR\plans\Whiteside County\0986003.dgn
 PLOT SCALE = 50.0000 / 1 IN.
 USER NAME = ltracy

TRAFFIC CONTROL PLAN AT IOWA APPROACH
 US 30 OVER MISSISSIPPI RIVER
 FAP ROUTE 309 (US 30)
 SECTION 7BR-P
 WHITESIDE COUNTY
 STRUCTURE NUMBER 098-6003

WI-6(0)3618