

Contract 89841

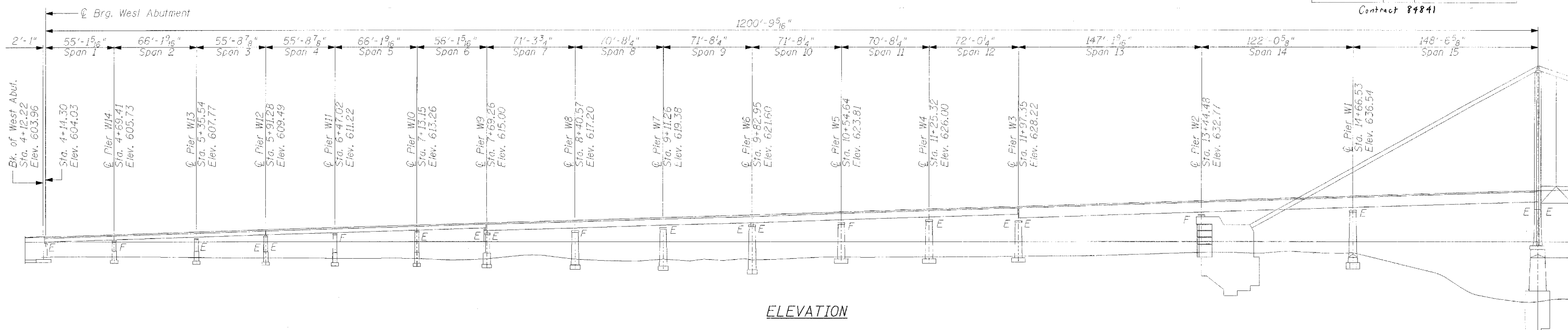

ELEVATION

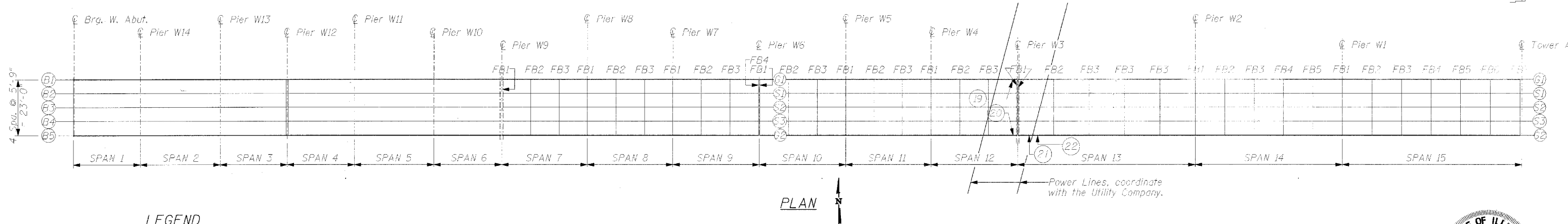

PLAN

LEGEND

(XX) = Indicates repair item, see description below.

19 & 20 = Replace the rusted thru bearing web plate, see S-7.

21 & 22 = Repair the rusted web stiffeners, see S-6.

DESIGN SPECIFICATIONS

2002 AASHTO

LOADING HS-20

DESIGN STRESSES

NEW CONSTRUCTION

$f_c = 4,500$ psi
 $f_y = 60,000$ psi (reinf.)
 $f_y = 50,000$ psi Structural Steel M270 Grade 50
 $f_y = 36,000$ psi Structural Steel M270 Grade 36

EXISTING STRUCTURE

$f_c = 1,000$ psi
 $f_s = 20,000$ psi (ASTM A305-50T) Reinforcement Steel
 $f_s = 18,000$ psi (ASTM A7-53T)
 $f_s = 24,000$ psi (ASTM A94-50T) (Silicon Steel)
 $f_s = 0.65 F_y = 21,450$ psi (ASTM A7-53T) Floorbeams only
 $f_s = 0.65 F_y = 28,000$ psi (ASTM A94-50T) (Silicon) Floorbeams only

TOTAL BILL OF MATERIAL

ITEM	UNIT	SUPER	SUB	TOTAL
Furnishing and Erecting Structural Steel	Pound	21,280		21,280
Structural Steel Repair	Pound	2,030		2,030
Jacking and Cribbing	L.S.	1		1
Formed Concrete Repair (Depth greater than 5 inch)	Sq. Ft.		32	32
Cleaning and Painting Steel Bridge	L.S.	1		1
Blasting Residue Containment and Disposal	L.S.	1		1
Bridge Cleaning and Painting Warranty	L.S.	1		1

For Cleaning and Painting requirements see special provisions.

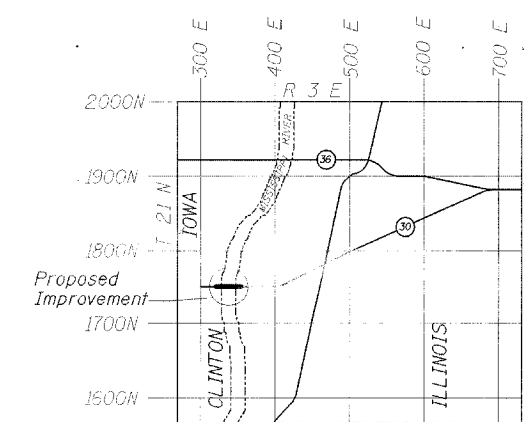

LOCATION SKETCH



Clark Dietz
 Structural Engineer
 Clark Dietz, Inc.
 DATE: 8/18/2005
 License Expires 11-30-06

GENERAL PLAN AND ELEVATION

CLINTON GATEWAY BRIDGE
 OVER MISSISSIPPI RIVER
 F.A. RTE. 309 (U.S. 30)
 SECTION (7B-1D) & 7BR
 WHITESIDE COUNTY
 STRUCTURE NUMBER 098-6003

CHAMPAIGN, ILLINOIS
 CHICAGO, ILLINOIS
 EVANSVILLE, INDIANA
 INDIANAPOLIS, INDIANA
 KENOSHA, WISCONSIN
 SPRING GREEN, WISCONSIN

Clark Dietz

REVISIONS	NAME	DATE

NOTICE: DIMENSIONAL DATA IS NOT TO BE OBTAINED BY SCALING ANY PORTION OF THIS DRAWING.

PROJECT NO. 1P2209

DRAWING NUMBER