

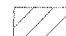





F.A.U. RTE.	SECTION	COUNTY	TOTAL SHEETS	SHEET NO.
6371	93-00295-02-PV	MCLEAN	117	23
STA.		TO STA.		
		ILLINOIS		
CONTRACT NO. 87267				

**LEGEND**

-  CONSTRUCTION WORK ZONE
-  LIMITS OF PROPOSED CONSTRUCTION
-  TEMPORARY BITUMINOUS PAVEMENT
-  TEMPORARY AGGREGATE ENTRANCE, PATCH, OR ACCESS ROAD
-  BARRICADE OR DRUM
-  DIRECTION OF TRAFFIC
-  SIGN

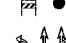
**WORK ZONE PAVEMENT MARKING LEGEND**

- (A) PAVEMENT MARKING TAPE, TYPE III 4" - WHITE
- (B) PAVEMENT MARKING TAPE, TYPE III 4" - YELLOW
- (C) PAVEMENT MARKING TAPE, TYPE III 24" - WHITE

NOTE:  
 THE ADDITIONAL TRAFFIC CONTROL DEVICES SHOWN FOR THIS STAGE SHALL BE INCLUDED IN THE CONTRACT LUMP SUM PRICE FOR TRAFFIC CONTROL AND PROTECTION, STANDARD 701606. SPECIAL UNLESS OTHERWISE NOTED, THE TRAFFIC CONTROL DEVICES AND PAVEMENT MARKING SHOWN FOR THIS STAGE SHALL REMAIN IN PLACE DURING STAGE IV.

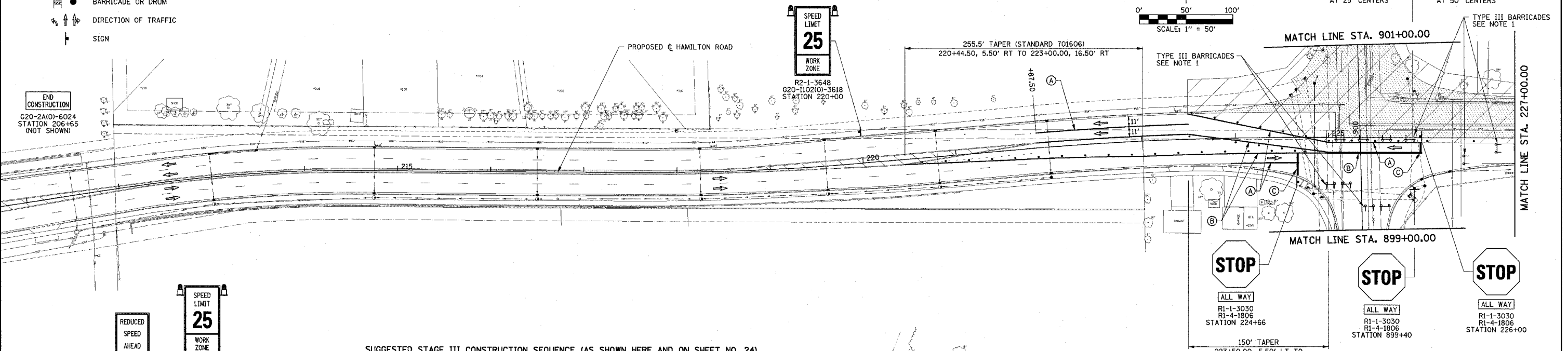
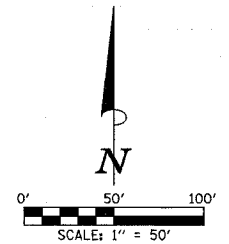

**SUGGESTED STAGE III CONSTRUCTION SEQUENCE (AS SHOWN HERE AND ON SHEET NO. 24)**  
 SEE SHEET NO. 24 FOR THE STAGE III CONSTRUCTION SEQUENCE.

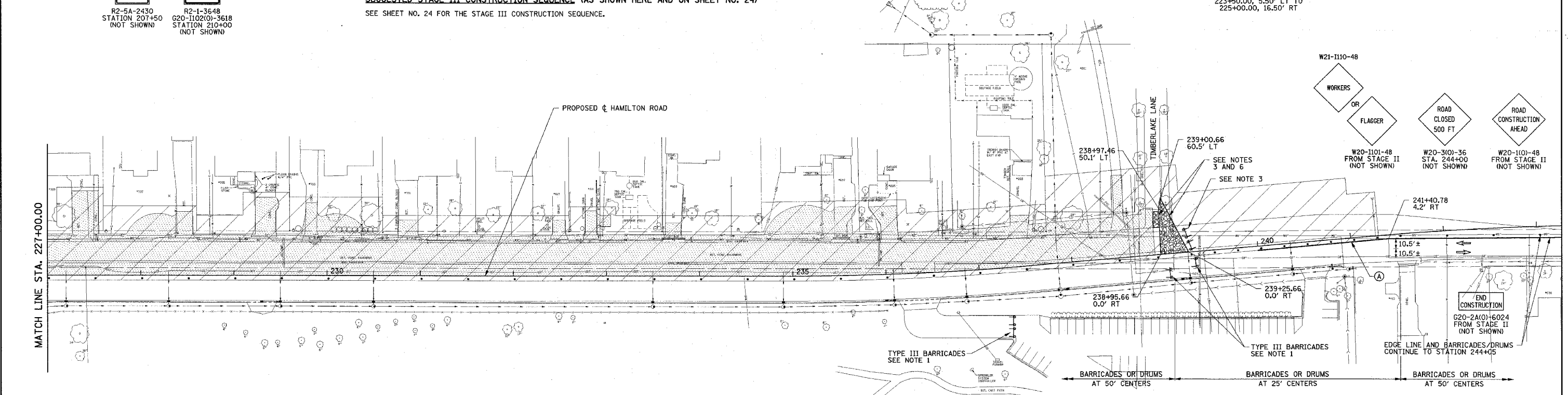

ILLINOIS DEPARTMENT OF TRANSPORTATION  
**STAGE CONSTRUCTION AND MAINTENANCE OF TRAFFIC PLAN**  
 STAGE III

DATE : 3-05  
 DRAWN BY : J.A.J.  
 CHECKED BY : R.L.H.

SCALE : 1"=50'