

F.A.U. RTE.	SECTION	COUNTY	TOTAL SHEETS	SHEET NO.
6371	93-00295-02-PV	MCLEAN	117	24
STA.		TO STA.		
		ILLINOIS		
CONTRACT NO. 87267				

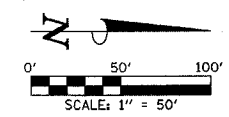

- LEGEND**
- CONSTRUCTION WORK ZONE
 - LIMITS OF PROPOSED CONSTRUCTION
 - TEMPORARY BITUMINOUS PAVEMENT
 - TEMPORARY AGGREGATE ENTRANCE, PATCH, OR ACCESS ROAD
 - BARRICADE OR DRUM
 - DIRECTION OF TRAFFIC
 - SIGN

NOTE:
 THE ADDITIONAL TRAFFIC CONTROL DEVICES SHOWN FOR THIS STAGE SHALL BE INCLUDED IN THE CONTRACT LUMP SUM PRICE FOR TRAFFIC CONTROL AND PROTECTION, STANDARD 701606, SPECIAL UNLESS OTHERWISE NOTED. THE TRAFFIC CONTROL DEVICES AND PAVEMENT MARKING SHOWN FOR THIS STAGE SHALL REMAIN IN PLACE DURING STAGE IV.

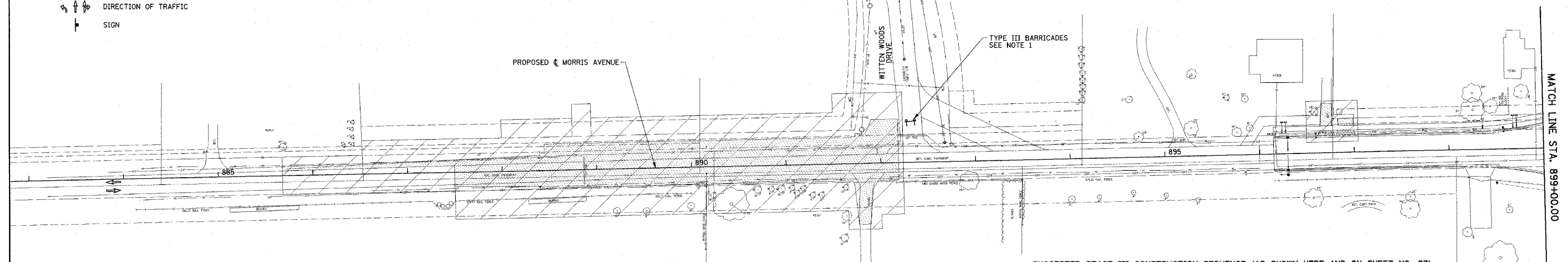

SUGGESTED STAGE III CONSTRUCTION SEQUENCE (AS SHOWN HERE AND ON SHEET NO. 23)

1. CLOSE HAMILTON ROAD TO ALL THRU TRAFFIC EAST OF THE INTERSECTION OF GREENWOOD AVENUE AT STATION 206+50 AND AT STATION 239+30 IN ACCORDANCE WITH STANDARD BLR 22. AT STATION 220+44.50, EASTBOUND TRAFFIC ON HAMILTON ROAD SHALL BE REDUCED TO ONE LANE IN ACCORDANCE WITH STANDARD 701606. CLOSE THE ENTRANCE TO THE PRAIRIE VISTA GOLF COURSE CLUB HOUSE PARKING LOT AT RT. STATION 237+30. CLOSE EXISTING MORRIS AVENUE TO ALL TRAFFIC AT STATIONS 885+50, 892+90 AND 904+65 IN ACCORDANCE WITH STANDARD BLR 21. CLOSE EXISTING WITTEN WOODS DRIVE AT LT. STATION 892+23 AND MORRIS AVENUE AT STATION 900+00 WITH TYPE III BARRICADES AS SHOWN ON THE TRAFFIC CONTROL PLANS AND IN ACCORDANCE WITH THE "ROAD CLOSED TO ALL TRAFFIC" DETAIL ON STANDARD 702001. THE ADDITIONAL TYPE III BARRICADES SHALL BE INCLUDED IN THE CONTRACT LUMP SUM PRICE FOR TRAFFIC CONTROL AND PROTECTION, STANDARD BLR 21, SPECIAL. CLOSE THE PREVIOUSLY CONSTRUCTED SECTION OF MORRIS AVENUE TO ALL THRU TRAFFIC AT STATION 899+50 AS SHOWN ON THE TRAFFIC CONTROL PLANS AND IN ACCORDANCE WITH THE "ROAD CLOSED TO THRU TRAFFIC" DETAIL ON STANDARD 702001. THE ADDITIONAL TYPE III BARRICADES SHALL BE INCLUDED IN THE CONTRACT LUMP SUM PRICE FOR TRAFFIC CONTROL AND PROTECTION, STANDARD BLR 22, SPECIAL.
2. THE RESIDENTS AT LT. STATIONS 227+40.4, 228+47.6, 229+32.4, 229+83.4, 230+87.3, 232+49.2, 232+83.6, 233+72.0, 235+52.7, 236+05.4, 237+44.0, AND 238+50.0 SHOULD PARK ON THE NEWLY CONSTRUCTED PAVEMENT BETWEEN STATION 228+00 AND STATION 238+00 DURING THIS STAGE. THE RESIDENTS AT RT. STATION 891+82.2 SHOULD PARK ON THE EAST SHOULDER AT STATION 893+10 DURING THIS STAGE. THE RESIDENTS USING WITTEN WOODS DRIVE SHALL HAVE ACCESS USING THE TEMPORARY ACCESS ROAD PREVIOUSLY CONSTRUCTED IN STAGE II. THE RESIDENTS AT RT. STATIONS 901+59.4, 903+09.0, AND 906+70.2 SHOULD PARK ALONG THE WEST SIDE OF MORRIS AVENUE BETWEEN STATIONS 905+00 AND 906+00 DURING THIS STAGE.
3. PLACE AGGREGATE FOR TEMPORARY ACCESS AT THE EAST HALF OF THE HAMILTON ROAD/TIMBERLAKE LANE INTERSECTION AS SHOWN ON THE TRAFFIC CONTROL PLANS. CLOSE THE WEST HALF OF TIMBERLAKE LANE AT THE INTERSECTION IN ACCORDANCE WITH THE APPLICABLE PORTIONS OF STANDARD 701501. PLACE TYPE III BARRICADES AS SHOWN ON THE TRAFFIC CONTROL PLANS.
4. CONSTRUCT THE NORTH HALF OF HAMILTON ROAD BETWEEN STATIONS 225+07.50 AND 238+89.66. CONSTRUCT THE WEST HALF OF TIMBERLAKE LANE TO STATION 1000+50.74. CONSTRUCT MORRIS AVENUE BETWEEN STATIONS 885+73.00 AND 892+18.85. CONSTRUCT THE STORM SEWER FROM PROPOSED INLET NO. 84 TO PROPOSED INLET NO. 85. CONSTRUCT THE DRIVEWAYS AT LT. STATION 896+68.5 AND LT. STATION 896+91.4. CONSTRUCT MORRIS AVENUE BETWEEN STATIONS 900+27.51 AND 904+63.50. ON THE EAST SIDE OF MORRIS AVENUE, CONSTRUCT THE PROPOSED SIDEWALK AND DRIVEWAY IMPROVEMENTS TO RT. STATION 907+55.00. ON THE WEST SIDE OF MORRIS AVENUE, DO NOT CONSTRUCT THE PROPOSED SIDEWALK IMPROVEMENTS NORTH OF LT. STATION 903+46.00. SEE NOTES 5 THROUGH 9 FOR ADDITIONAL INFORMATION ON THE UTILITY IMPROVEMENTS. PROVIDE TRAFFIC CONTROL ON EXISTING MORRIS AVENUE NORTH OF HEATHERHILL ROAD IN ACCORDANCE WITH STANDARD 70101 FOR SHOULDER OPERATIONS.
5. CONSTRUCT THE PROPOSED SANITARY SEWER FROM MANHOLE NO. 4 TO MANHOLE NO. 9 AND FROM MANHOLE NO. 1 TO MANHOLE NO. 2. THE SANITARY SEWER CAN NOT BE PUT INTO SERVICE UNTIL THE NEW WATER MAIN IS IN SERVICE AND THE EXISTING WATER MAIN IS ABANDONED. PATCH THE EXISTING PAVEMENT AT STATION 905+05 WITH CLASS D PATCHES, 12" THICK. PROVIDE TRAFFIC CONTROL ON EXISTING MORRIS AVENUE IN ACCORDANCE WITH STANDARD 70101.
6. CONSTRUCT THE PROPOSED WATER MAIN FROM THE PROPOSED VALVE AT STATION 225+15.8 TO THE PROPOSED VALVE AT STATION 239+39.0. PATCH THE EXISTING PAVEMENT ON TIMBERLAKE LANE WITH AGGREGATE FOR TEMPORARY ACCESS. PROVIDE TRAFFIC CONTROL ON EXISTING TIMBERLAKE LANE IN ACCORDANCE WITH STANDARD 70101 AS REQUIRED.
7. CONSTRUCT THE PROPOSED WATER MAIN FROM THE PROPOSED VALVE AT STATION 888+36.0 TO STATION 892+60.0 AND FROM THE PROPOSED TEE AT STATION 900+35.0 (225+52.6) TO THE PROPOSED CONNECTION AT STATION 905+14.0. TEMPORARILY CAP THE WATER MAIN AT STATION 892+60.0 UNTIL STAGE IV WHEN IT WILL BE COMPLETED. PATCH THE EXISTING PAVEMENT AT RT. STATION 904+75 WITH CLASS D PATCHES, 12" THICK. PROVIDE TRAFFIC CONTROL ON EXISTING HEATHERHILL ROAD IN ACCORDANCE WITH STANDARD 70101.
8. CONSTRUCT THE PROPOSED WATER MAIN AT STATION 227+00.0 TO THE PROPOSED TEE 35.6' LEFT OF THE CENTERLINE.
9. CONSTRUCT THE REMAINING DRAINAGE IMPROVEMENTS WITHIN THE LIMITS OF THIS STAGE.
10. PLACE THE PROPOSED PAVEMENT MARKING ON THE NORTH HALF OF HAMILTON ROAD BETWEEN STATIONS 225+81.00 AND 238+80.00. PLACE THE PROPOSED PAVEMENT MARKING ON MORRIS AVENUE BETWEEN STATIONS 885+73.00 AND 892+18.85 AND BETWEEN STATIONS 900+57.50 AND 904+30.00.
11. CLOSE THE NEWLY CONSTRUCTED SIDEWALK ON MORRIS AVENUE AT LT. STATIONS 900+70 AND 903+20 AND RT. STATIONS 900+70 AND 904+40 IN ACCORDANCE WITH STANDARD 701801. THE SIDEWALK CLOSURES SHALL REMAIN IN PLACE UNTIL THE END OF STAGE IV.

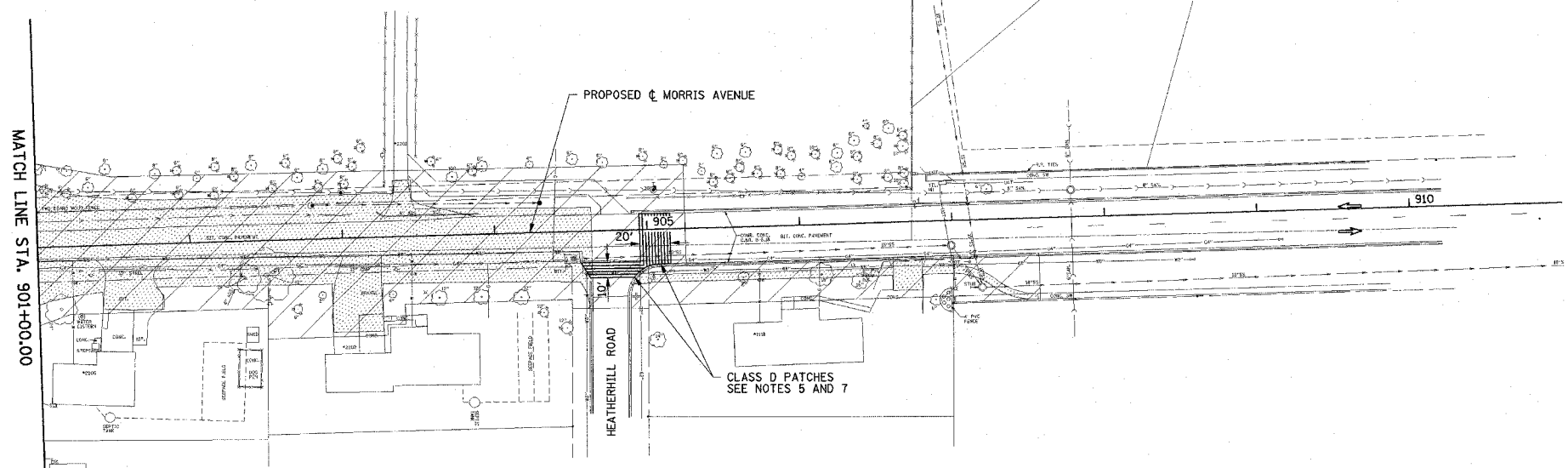

ILLINOIS DEPARTMENT OF TRANSPORTATION
STAGE CONSTRUCTION AND MAINTENANCE OF TRAFFIC PLAN
 STAGE III

DATE : 3-05
 DRAWN BY : J.A.J.
 CHECKED BY : R.L.H.

SCALE : 1" = 50'