

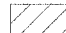





F.A.J. RTE.	SECTION	COUNTY	TOTAL SHEETS	SHEET NO.
6371	93-00295-02-PV	MCLEAN	117	25
STA.		TO STA.		ILLINOIS
CONTRACT NO. 87267				

LEGEND

-  CONSTRUCTION WORK ZONE
-  LIMITS OF PROPOSED CONSTRUCTION
-  TEMPORARY BITUMINOUS PAVEMENT
-  TEMPORARY AGGREGATE ENTRANCE, PATCH, OR ACCESS ROAD
-  BARRICADE OR DRUM
-  DIRECTION OF TRAFFIC
-  SIGN

NOTE:
THE ADDITIONAL TRAFFIC CONTROL DEVICES SHOWN FOR THIS STAGE SHALL BE INCLUDED IN THE CONTRACT LUMP SUM PRICE FOR TRAFFIC CONTROL AND PROTECTION, STANDARD 701606, SPECIAL UNLESS OTHERWISE NOTED.

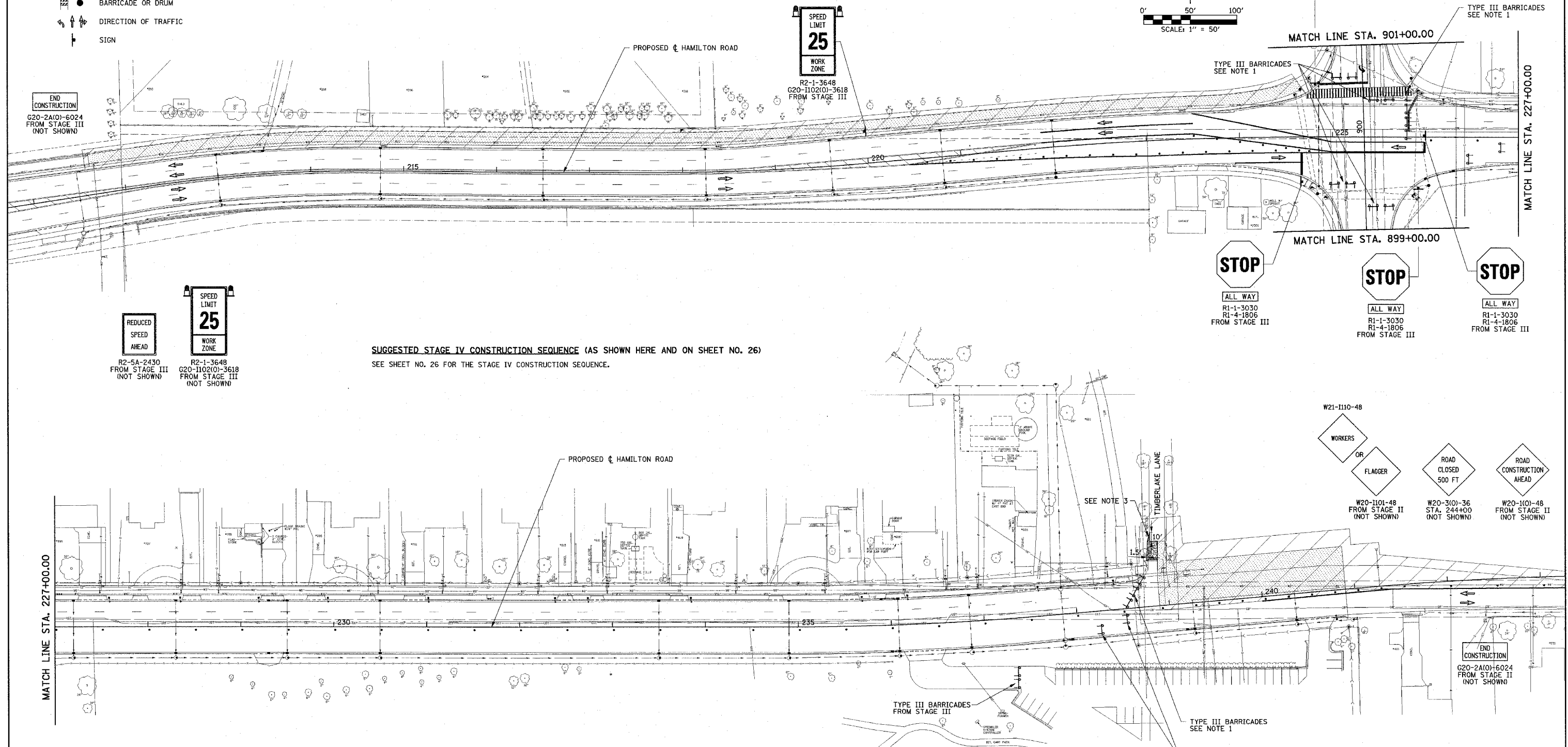
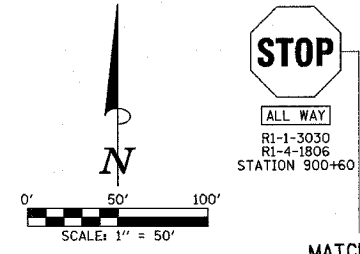

SUGGESTED STAGE IV CONSTRUCTION SEQUENCE (AS SHOWN HERE AND ON SHEET NO. 26)
SEE SHEET NO. 26 FOR THE STAGE IV CONSTRUCTION SEQUENCE.

ILLINOIS DEPARTMENT OF TRANSPORTATION
STAGE CONSTRUCTION AND MAINTENANCE OF TRAFFIC PLAN
STAGE IV

DATE : 3-05
DRAWN BY : J.A.J.
CHECKED BY : R.L.H.

SCALE : 1"=50'