

F.A.U. RTE.	SECTION	COUNTY	TOTAL SHEETS	SHEET NO.
6371	93-00295-02-PV	MCLEAN	117	26
STA.	TO STA.		ILLINOIS	
			CONTRACT NO. 87267	

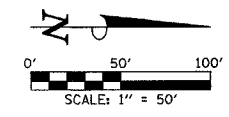

- LEGEND**
- CONSTRUCTION WORK ZONE
 - LIMITS OF PROPOSED CONSTRUCTION
 - TEMPORARY BITUMINOUS PAVEMENT
 - TEMPORARY AGGREGATE ENTRANCE, PATCH, OR ACCESS ROAD
 - BARRICADE OR DRUM
 - DIRECTION OF TRAFFIC
 - SIGN

NOTE:
THE ADDITIONAL TRAFFIC CONTROL DEVICES SHOWN FOR THIS STAGE SHALL BE INCLUDED IN THE CONTRACT LUMP SUM PRICE FOR TRAFFIC CONTROL AND PROTECTION STANDARD T01606, SPECIAL UNLESS OTHERWISE NOTED.

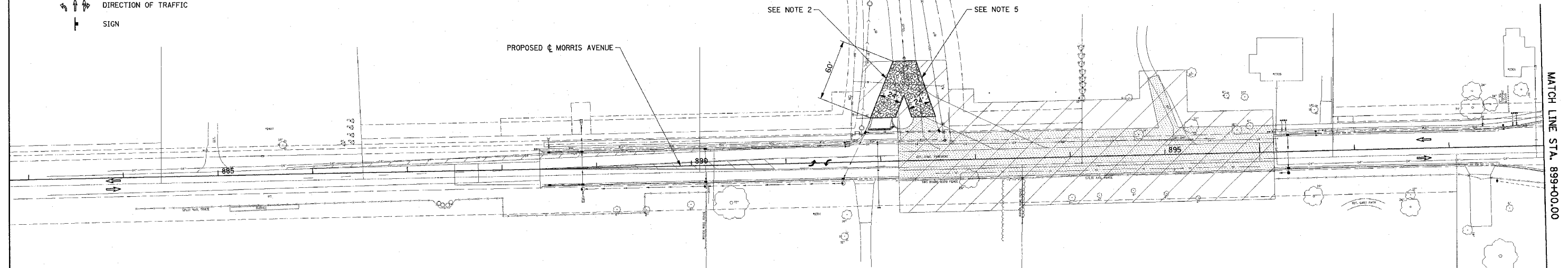

SUGGESTED STAGE IV CONSTRUCTION SEQUENCE (AS SHOWN HERE AND ON SHEET NO. 25)

1. EXISTING MORRIS AVENUE SHALL REMAIN CLOSED TO ALL TRAFFIC AT STATIONS 892+15, 896+50 AND 904+65 IN ACCORDANCE WITH STANDARD BLR 21. CLOSE THE PREVIOUSLY CONSTRUCTED SECTION OF MORRIS AVENUE NORTH OF HAMILTON ROAD TO ALL THRU TRAFFIC AT STATIONS 899+50 AND 900+40 AS SHOWN ON THE TRAFFIC CONTROL PLANS AND IN ACCORDANCE WITH THE "ROAD CLOSED TO THRU TRAFFIC" DETAIL ON STANDARD T02001. THE ADDITIONAL TYPE III BARRICADES SHALL BE INCLUDED IN THE CONTRACT LUMP SUM PRICE FOR TRAFFIC CONTROL AND PROTECTION, STANDARD BLR 22, SPECIAL. CLOSE THE PREVIOUSLY CONSTRUCTED SECTION OF MORRIS AVENUE NORTH OF HAMILTON ROAD TO ALL TRAFFIC AT STATION 903+00 IN ACCORDANCE WITH STANDARD BLR 21. THE PREVIOUSLY CONSTRUCTED SECTIONS OF HAMILTON ROAD SHALL REMAIN OPEN TO THRU TRAFFIC USING THE TRAFFIC CONTROL DEVICES AND TEMPORARY PAVEMENT MARKING PLACED DURING STAGE III. MODIFICATIONS TO THE TRAFFIC CONTROL FROM STAGE III ARE SHOWN. CLOSE THE NORTH HALF OF HAMILTON ROAD BETWEEN MORRIS AVENUE AND TIMBERLAKE LANE WITH TYPE III BARRICADES AS SHOWN ON THE TRAFFIC CONTROL PLANS AND IN ACCORDANCE WITH THE "ROAD CLOSED TO ALL TRAFFIC" DETAIL ON STANDARD T02001. THE PREVIOUSLY CONSTRUCTED SECTION OF MORRIS AVENUE SOUTH OF STATION 892+18.85 SHALL BE OPEN TO TRAFFIC TO PROVIDE ACCESS TO WITTEN WOODS DRIVE.
2. PLACE AGGREGATE FOR TEMPORARY ACCESS AT THE SOUTH ENTRANCE TO WITTEN WOODS DRIVE AS SHOWN ON THE TRAFFIC CONTROL PLANS.
3. PLACE AGGREGATE FOR TEMPORARY ACCESS AT THE WEST HALF OF THE HAMILTON ROAD/TIMBERLAKE LANE INTERSECTION AS SHOWN ON THE TRAFFIC CONTROL PLANS. CLOSE THE EAST HALF OF TIMBERLAKE LANE AT THE INTERSECTION IN ACCORDANCE WITH THE APPLICABLE PORTIONS OF STANDARD T01501.
4. CONSTRUCT THE NORTH HALF OF HAMILTON ROAD BETWEEN STATIONS 238+89.66 AND 240+90.00. CONSTRUCT THE PROPOSED WATER MAIN AT STATION 239+42.0 TO THE PROPOSED TEE 35.6' LEFT OF THE CENTERLINE. CONSTRUCT THE PROPOSED WATER MAIN FROM THE PROPOSED VALVE AT STATION 239+39.0 TO THE PROPOSED VALVE AT STATION 241+19.0. DO NOT CONNECT TO THE EXISTING WATER MAIN AT STATION 241+15.0 UNTIL ALL OTHER CONNECTIONS TO THE EXISTING WATER MAIN HAVE BEEN MADE AND ALL SERVICE LINES HAVE BEEN CONNECTED TO THE PROPOSED WATER MAIN. CONSTRUCT THE EAST HALF OF TIMBERLAKE LANE TO STATION 1000+50.74. REMOVE THE REMAINING TEMPORARY PAVEMENT AND RECONSTRUCT THE AGGREGATE SHOULDER ON THE NORTH SIDE OF EXISTING HAMILTON ROAD. PROVIDE TRAFFIC CONTROL ON EXISTING HAMILTON ROAD IN ACCORDANCE WITH STANDARD T01701 FOR SHOULDER OPERATIONS.
5. CONSTRUCT MORRIS AVENUE BETWEEN STATIONS 892+18.85 AND 896+15. CONSTRUCT THE PROPOSED WATER MAIN FROM STATION 892+60.0 TO THE PROPOSED VALVE AT STATION 896+10.0. PLACE AGGREGATE FOR TEMPORARY ACCESS AT THE NORTH ENTRANCE TO WITTEN WOODS DRIVE. REMOVE THE TEMPORARY AGGREGATE ACCESS ROAD AND CONSTRUCT THE PROPOSED SIDEWALK ON THE WEST SIDE OF MORRIS AVENUE BETWEEN STATIONS 903+46.00 AND 907+30.00. CONSTRUCT THE REMAINING CURB AND GUTTER AND CONCRETE PAVEMENT ON THE WEST SIDE OF MORRIS AVENUE BETWEEN STATIONS 904+63.50 AND 906+10.00. PROVIDE TRAFFIC CONTROL ON EXISTING MORRIS AVENUE IN ACCORDANCE WITH STANDARD T01701 FOR SHOULDER OPERATIONS.
6. MILL THE EXISTING PAVEMENT ON MORRIS AVENUE BETWEEN STATIONS 904+63.50 AND 910+15.00 AND ON TIMBERLAKE LANE BETWEEN STATIONS 1000+60.00 AND 1000+70.00. CONSTRUCT TEMPORARY BITUMINOUS RAMPS ON MORRIS AVENUE AT STATION 910+15.00, ON HEATHERHILL ROAD AT MORRIS AVENUE, AND ON TIMBERLAKE LANE AT STATION 1000+70.00. PLACE ADDITIONAL AGGREGATE FOR TEMPORARY ACCESS AT THE EAST HALF OF THE HAMILTON ROAD/TIMBERLAKE LANE INTERSECTION AS REQUIRED. PROVIDE TRAFFIC CONTROL ON MORRIS AVENUE, HEATHERHILL ROAD, AND TIMBERLAKE LANE IN ACCORDANCE WITH STANDARD T01501 AS REQUIRED. HEATHERHILL ROAD SHALL REMAIN OPEN TO TRAFFIC AT ALL TIMES WITH ACCESS BEING CONTROLLED BY FLAGGERS DURING CONSTRUCTION OPERATIONS.
7. CONSTRUCT THE PROPOSED BITUMINOUS SURFACE ON MORRIS AVENUE BETWEEN STATIONS 904+63.50 AND 910+15.00 AND ON TIMBERLAKE LANE BETWEEN STATIONS 1000+50.74 AND 1000+70.00. REMOVE ALL TEMPORARY BITUMINOUS RAMPS AND AGGREGATE FOR TEMPORARY ACCESS. PLACE THE PROPOSED PAVEMENT MARKING ON MORRIS AVENUE BETWEEN STATIONS 892+18.85 AND 896+15 AND STATIONS 905+10.00 AND 910+15.00. PROVIDE TRAFFIC CONTROL ON MORRIS AVENUE, HEATHERHILL ROAD, AND TIMBERLAKE LANE IN ACCORDANCE WITH STANDARDS T01311 AND T01501 AS REQUIRED.
8. CONSTRUCT THE BITUMINOUS SURFACE COURSE FOR THE PEDESTRIAN TRAIL ALONG THE NORTH SIDE OF HAMILTON ROAD BETWEEN STATIONS 211+65.00 AND 224+63.02. PROVIDE TRAFFIC CONTROL ON HAMILTON ROAD AND MORRIS AVENUE IN ACCORDANCE WITH STANDARD T01701 FOR SHOULDER OPERATIONS AS REQUIRED.
9. PLACE THE REMAINING PROPOSED PAVEMENT MARKING ON HAMILTON ROAD. PROVIDE TRAFFIC CONTROL ON HAMILTON ROAD IN ACCORDANCE WITH STANDARDS T01311, T01606, AND T01701 AS REQUIRED. OPEN ALL PREVIOUSLY CONSTRUCTED SECTIONS OF HAMILTON ROAD AND MORRIS AVENUE TO TRAFFIC. ACTIVATE THE PROPOSED SIGNALS AT THE HAMILTON ROAD/MORRIS AVENUE INTERSECTION.

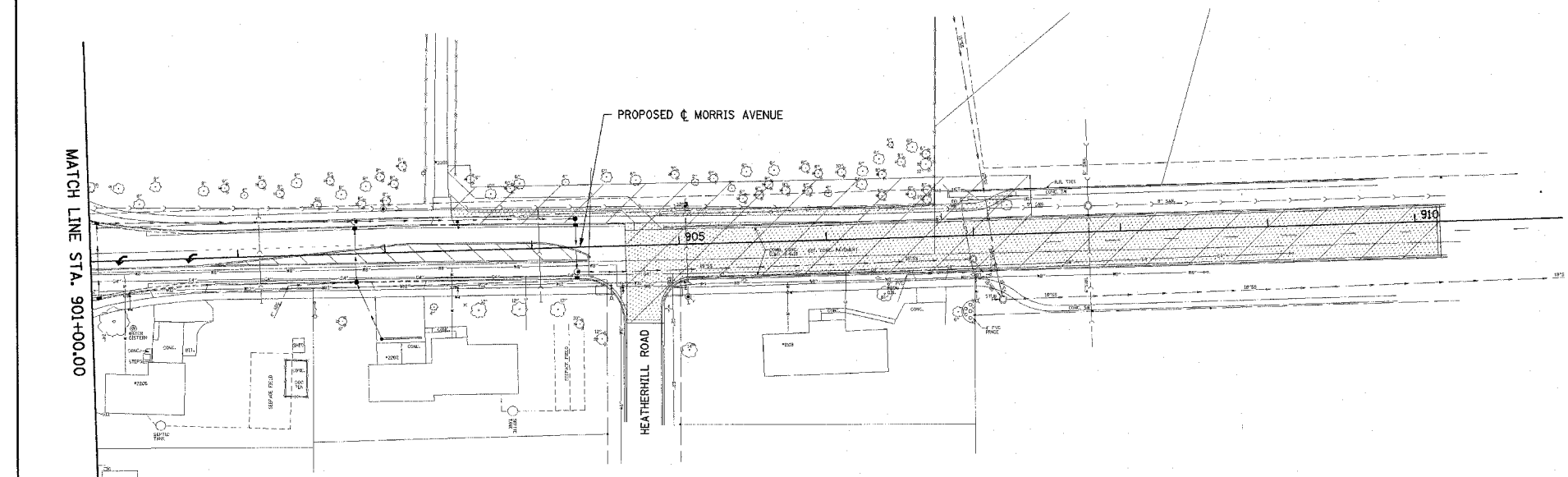

ILLINOIS DEPARTMENT OF TRANSPORTATION
STAGE CONSTRUCTION AND MAINTENANCE OF TRAFFIC PLAN
STAGE IV

DATE : 3-05
DRAWN BY : J.A.J.
CHECKED BY : R.L.H.
SCALE : 1"=50'