

SEC. 17, T.23 N., R.2 E., 3rd P.M.
MCLEAN COUNTY, ILLINOIS

F.A.U. RTE.	SECTION	COUNTY	TOTAL SHEETS	SHEET NO.
6371	93-00295-02-PV	MCLEAN	117	37
STA. 223+80.00		TO STA. 228+20.00		
ILLINOIS				
CONTRACT NO. 87267				

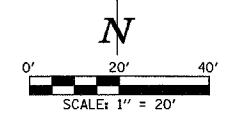

PROPOSED HAMILTON RD. CURVE DATA
 P.I. STA. 223+20.04
 $\Delta = 51^{\circ}00'$
 $D = 1^{\circ}47'26''$
 $T = 144.38'$
 $R = 3200.0'$
 $L = 288.56'$
 $E = 3.26'$
 P.C. STA. 221+75.66
 P.T. STA. 224+64.22
 S.E. = TO MATCH MORRIS AVE. P.G.L.
 (SEE S.E. TRANSITION TABLES)

- LEGEND**
- [Hatched Box] - PROPOSED SIDEWALK RAMP (SEE DETAIL)
 - [Hatched Box] - PROPOSED PCC DRIVEWAY PAVEMENT (6" FOR P.E. - 8" FOR C.E.)

FOR REMOVAL/RELOCATION PLAN IN THIS AREA SEE SHEET NO'S. 28, 29, & 32.

SEE HORIZONTAL ALIGNMENT LAYOUT AND CONTROL SHEETS FOR ADDITIONAL INFORMATION.

SEE SCHEDULE OF QUANTITIES FOR TYPICAL SECTION PAVEMENT PAY ITEMS AND THEIR LOCATIONS.

SEE PAVEMENT JOINTS, INTERSECTION DETAILS, WATER MAIN, AND SANITARY SEWER PLAN AND PROFILE SHEETS FOR ADDITIONAL INFORMATION.

SEE THE STAGE CONSTRUCTION AND MAINTENANCE OF TRAFFIC PLANS FOR THE VARIOUS STAGES AND CONSTRUCTION SEQUENCES ON HAMILTON RD.

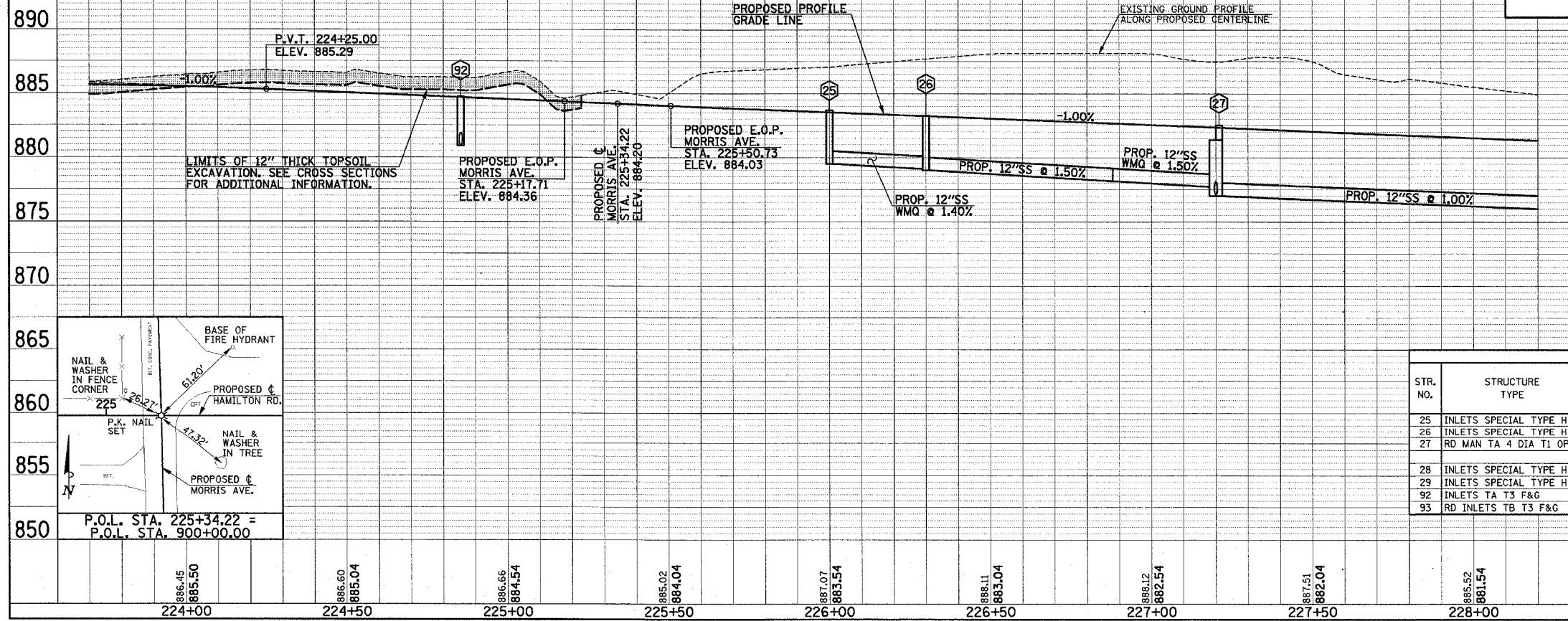
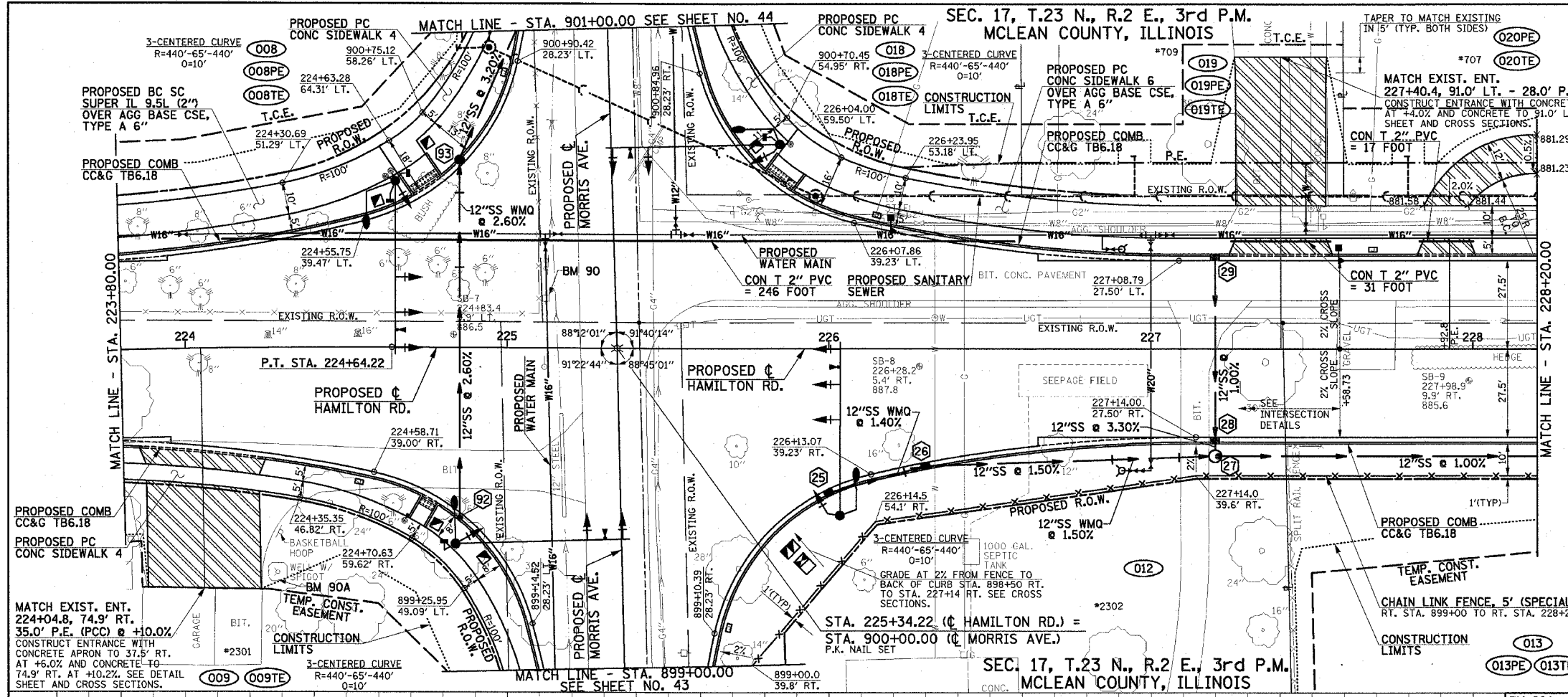

BM 90A - CHISELED "I" ON SOUTH SIDE OF CONCRETE PAD SURROUNDING WELL HYDRANT, STA. 224+30, 70' RT. ELEV. 889.60

BM 90 - RAILROAD SPIKE IN POWER POLE ON WEST SIDE OF MORRIS AVE. STA. 225+12, 16' LT. ELEV. 886.19

LOCATION STR. - STR. OR STA., O.S.	CONCRETE COLLAR (EACH)	SS 1 WMO 12 (FOOT)	SS 2 WMO 12 (FOOT)	STORM SEW CL A 1 12 (FOOT)	STORM SEW CL A 2 12 (FOOT)	GRADE %	TRENCH BACKFILL (CU YD)
25 - 26		29				1.40	5.7
26 - 27	1		30		57	1.50	20.2
27 - 28				3		3.30	0.7
28 - 29				56		1.00	11.1
27 - 30				106		1.00	
92 - 93	1	32		78		2.60	19.4
93 - 94				46		3.20	10.9

CONCRETE COLLARS SHALL BE USED TO CONNECT STORM SEWERS OF DIFFERENT MATERIAL TYPES

STR. NO.	STRUCTURE TYPE	OFF-SET SIDE	STA. OF C/L 2 FT. OPENING	OFFSET OF C/L 2 FT.	STA. OF C/L STR.	OFFSET OF C/L STR.	EX. T/O FRAME/GRATE ELEV.	PR. T/O FRAME/GRATE ELEV.	PR. T/O FLAT SLAB TOP ELEV.	INVERT IN ELEV.	U.S. STR. NO.	INVERT OUT ELEV.	D.S. STR. NO.
25	INLETS SPECIAL TYPE H	RT	226+00.00	45.05	226+00.00	45.05	883.70	883.29	879.09	25	879.00	26	
26	INLETS SPECIAL TYPE H	RT	226+30.00	36.70	226+30.00	36.70	883.29	882.49	881.39	26	877.00	27	
27	RD MAN TA 4 DIA T1 OPEN	RT	227+21.00	33.50	227+20.00	33.50	882.49	881.39	877.70	26	877.00	30	
28	INLETS SPECIAL TYPE H	RT	227+20.00	28.60	227+20.00	28.60	882.00	881.77	877.24	29	877.20	27	
29	INLETS SPECIAL TYPE H	LT	227+20.00	28.60	227+20.00	28.60	881.77	884.75	882.65	28	877.80	28	
92	INLETS TA T3 F&G	LT	899+48.00	50.05	899+48.00	50.05	884.75	882.65	881.55	92	880.90	93	
93	RD INLETS TB T3 F&G	LT	900+60.00	46.75	900+60.00	47.25	882.65	881.55	878.04	92	877.90	94	