

SEC. 17, T.23 N., R.2 E., 3rd P.M.
MCLEAN COUNTY, ILLINOIS

F.A.U. RTE.	SECTION	COUNTY	TOTAL SHEETS	SHEET NO.
6371	93-00295-02-PV	MCLEAN	117	61
STA. 210+80.00 TO STA. 215+00.00				
ILLINOIS				
CONTRACT NO. 87267				

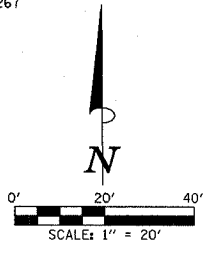

THE PROPOSED ELEVATIONS SHOWN FOR THE FIRE HYDRANTS AND THE WATER VALVES ARE THE FINISHED GRADE SURFACE ELEVATION ADJACENT TO THE HYDRANT OR THE VALVE.

*A MINIMUM OF 20 FEET OF RESTRAINED JOINT PIPE IS REQUIRED ON EACH SIDE OF 16" BUTTERFLY VALVES.

- NOTES
- ELEVATIONS ARE TOP OF PIPE FOR WATER MAIN.
 - IT WILL BE NECESSARY TO CONSTRUCT THE WATER MAIN IN VARIOUS STAGES. SEE THE TRAFFIC CONTROL AND MAINTENANCE OF TRAFFIC PLANS FOR STAGING PLAN.
 - ALL 16" BUTTERFLY VALVE OPERATORS SHALL BE PLACED ON SOUTH SIDE OF WATER MAIN TO AVOID PLACEMENT WITHIN THE PROPOSED BIKE TRAIL.
 - CONTRACTOR TO VERIFY DEPTH PRIOR TO CONSTRUCTION. WHEN CONNECTIONS ARE TO BE MADE TO EXISTING PIPING AND FITTINGS, THE LOCATION AND ELEVATION OF THE EXISTING PIPING SHALL BE FIELD DETERMINED AND THE APPROPRIATE ADJUSTMENTS MADE.
 - CONTRACTOR TO PROVIDE ALL PIPING & GASKETS, FITTINGS, AND HARDWARE NECESSARY TO CONNECT TO EXISTING WATER MAIN.
 - SEE REMOVAL/RELOCATION PLANS FOR REMOVAL OF EXISTING FIRE HYDRANT.
 - CONTRACTOR TO PROVIDE FOR FLUSHING AND SAMPLING TAPS EVERY 1200 FEET AND AT EVERY CONNECTION.

PLAN	DATE	BY
REVISION		
NO. 1		
NO. 2		
NO. 3		
NO. 4		
NO. 5		

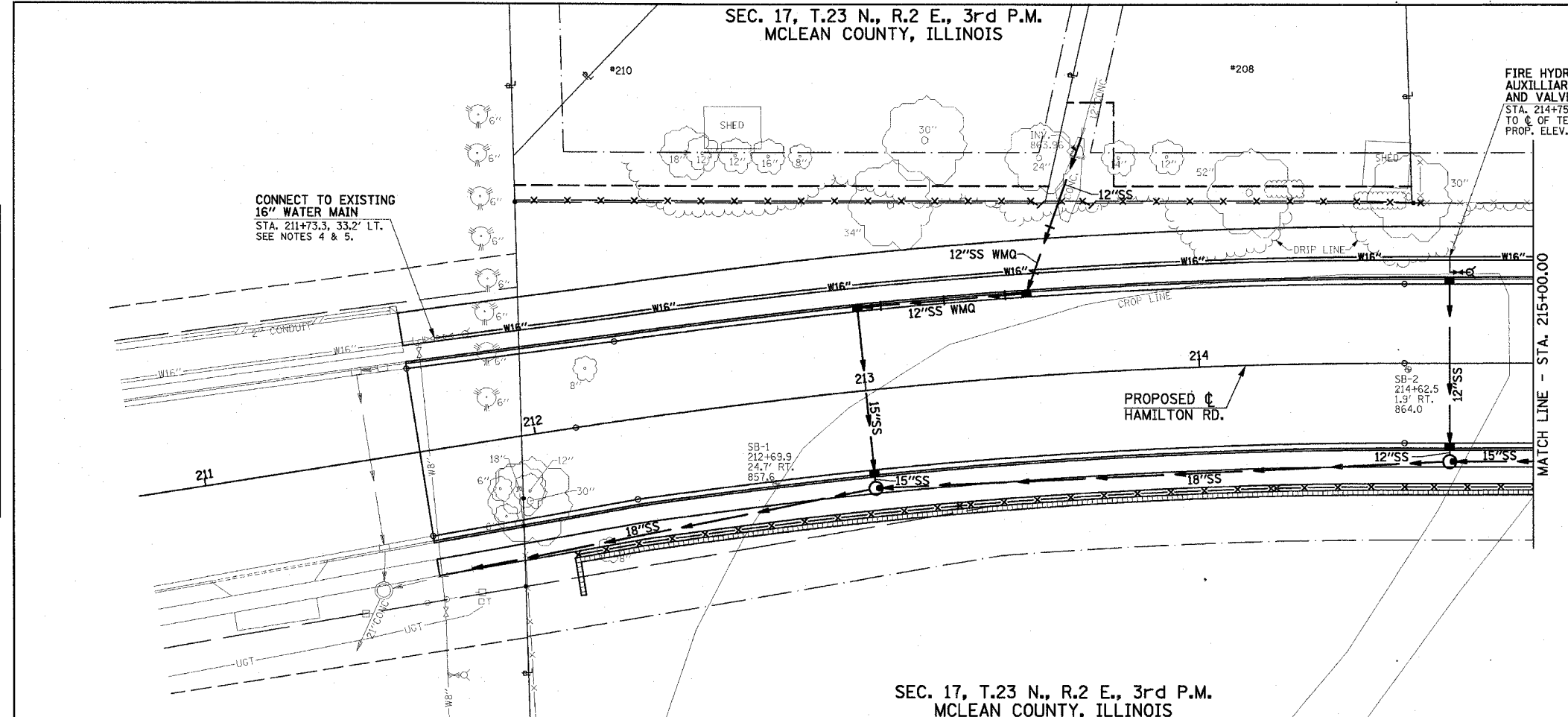

SEC. 17, T.23 N., R.2 E., 3rd P.M.
MCLEAN COUNTY, ILLINOIS

BM 202 - HIGH POINT ON CONCRETE FOUNDATION OF EAST GUY ANCHOR FOR RADIO TOWER
ELEV. 864.58

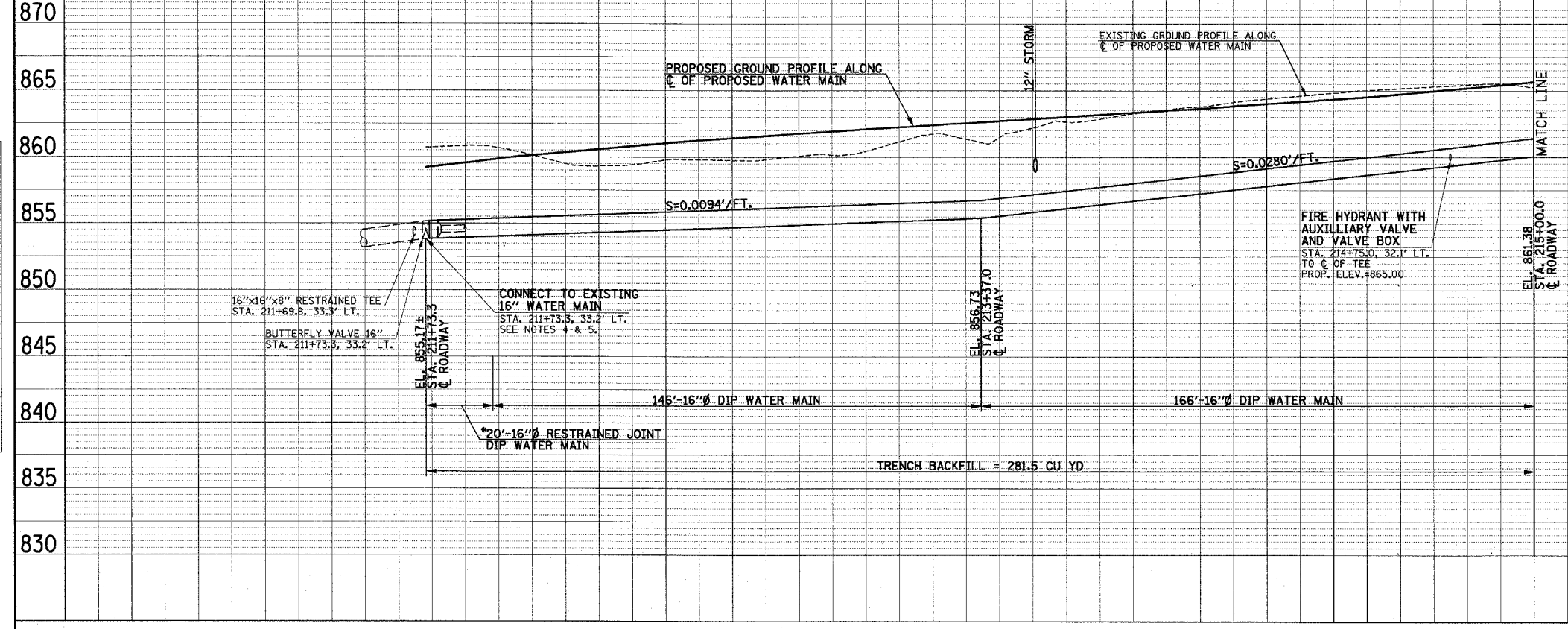

BILL OF MATERIALS				
ITEM	UNIT	TOTAL QUANTITY	HAMILTON ROAD	MORRIS AVENUE
DUCTILE IRON WATER MAIN 12"	FOOT	291	0	291
DUCTILE IRON WATER MAIN 16"	FOOT	3188	2388	800
WATER VALVES 1"	EACH	16	15	3
WATER VALVES 1 1/2"	EACH	4	0	4
WATER VALVES 6"	EACH	2	1	1
WATER VALVES 8"	EACH	2	2	0
WATER VALVES 12"	EACH	1	0	1
BUTTERFLY VALVES 16"	EACH	12	8	4
BUTTERFLY VALVES 20"	EACH	2	2	0
WATER SERVICE LINE 1"	FOOT	379	284	95
WATER SERVICE LINE 1 1/2"	FOOT	52	0	52
FIRE HYDRANT WITH AUXILIARY VALVE AND VALVE BOX	EACH	12	8	4
STEEL CASING 30"	FOOT	98	98	0
DUCTILE IRON WATER MAIN 6", RESTRAINED JOINT TYPE	FOOT	154	115	39
DUCTILE IRON WATER MAIN 8", RESTRAINED JOINT TYPE	FOOT	63	45	18
DUCTILE IRON WATER MAIN 12", RESTRAINED JOINT TYPE	FOOT	188	0	188
DUCTILE IRON WATER MAIN 16", RESTRAINED JOINT TYPE	FOOT	962	562	400
DUCTILE IRON WATER MAIN 20", RESTRAINED JOINT TYPE	FOOT	74	74	0

Robert A. Anderson
PROFESSIONAL ENGINEER
CLARK DIETZ, INC.
DATE: MAR 18, 2005
LICENSE EXPIRES 11-30-05