

F.A.U. RTE.	SECTION	COUNTY	TOTAL SHEETS	SHEET NO.
6371	93-00295-02-PV	MCLEAN	117	76
STA. 223+80.00		TO STA. 228+20.00		
ILLINOIS				
CONTRACT NO. 87267				

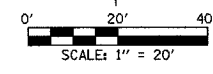

PROPOSED \bar{C} HAMILTON RD.
 CURVE DATA
 P.I. STA. 223+20.04
 $\Delta = 510'00''$
 $D = 1'47'26''$
 $T = 144.38'$
 $R = 3200.00'$
 $L = 288.56'$
 $E = 3.26'$
 P.C. STA. 221+75.66
 P.T. STA. 224+64.22
 S.E. = TO MATCH MORRIS AVE. P.G.L.
 (SEE S.E. TRANSITION TABLES)

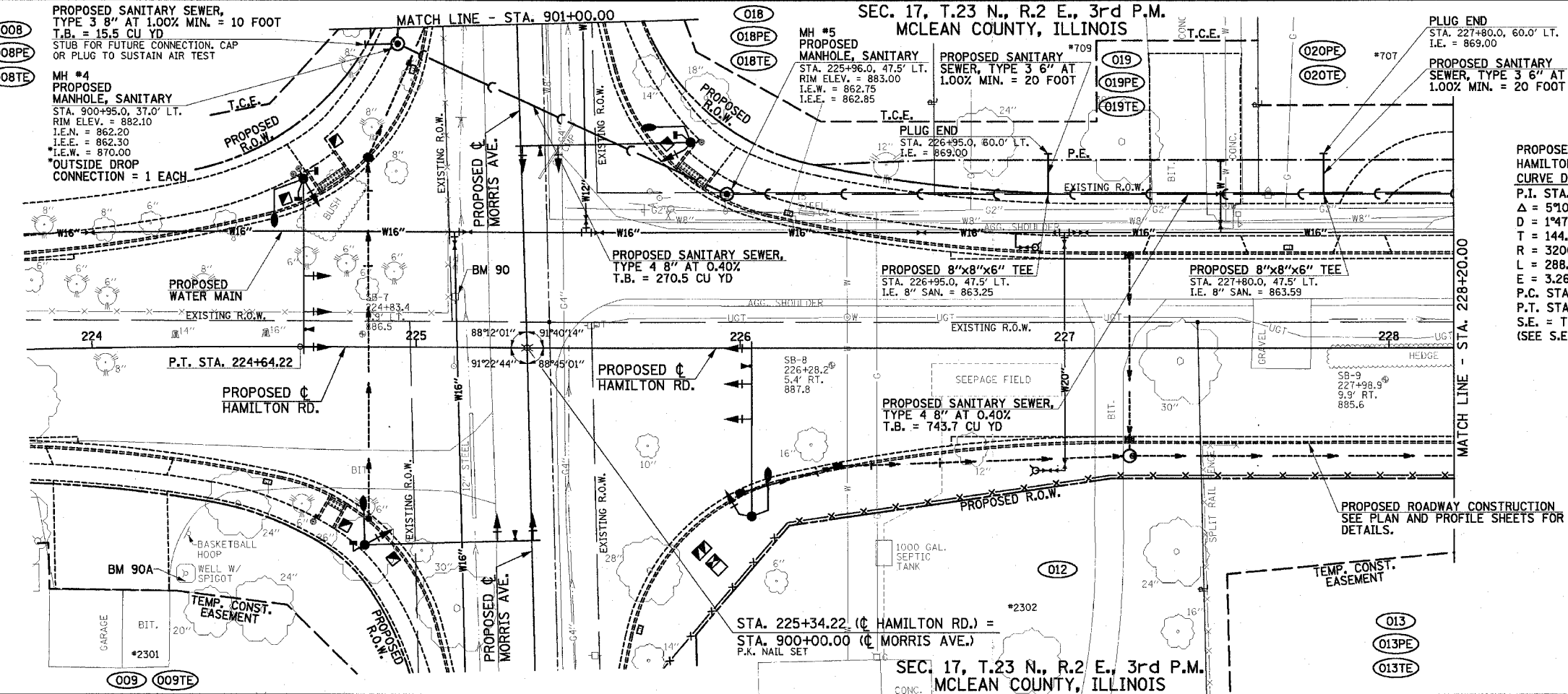

SEE SCHEDULE OF QUANTITIES FOR ADDITIONAL INFORMATION.

DATE: _____ BY: _____
 SURVEYED _____ PLOTTED _____
 PLAN NOTE BOOK _____ R.T. OF WAY CHECKED _____
 NO. _____

DATE: _____ BY: _____
 PROFILE SURVEYED _____ PLOTTED _____
 NO. _____

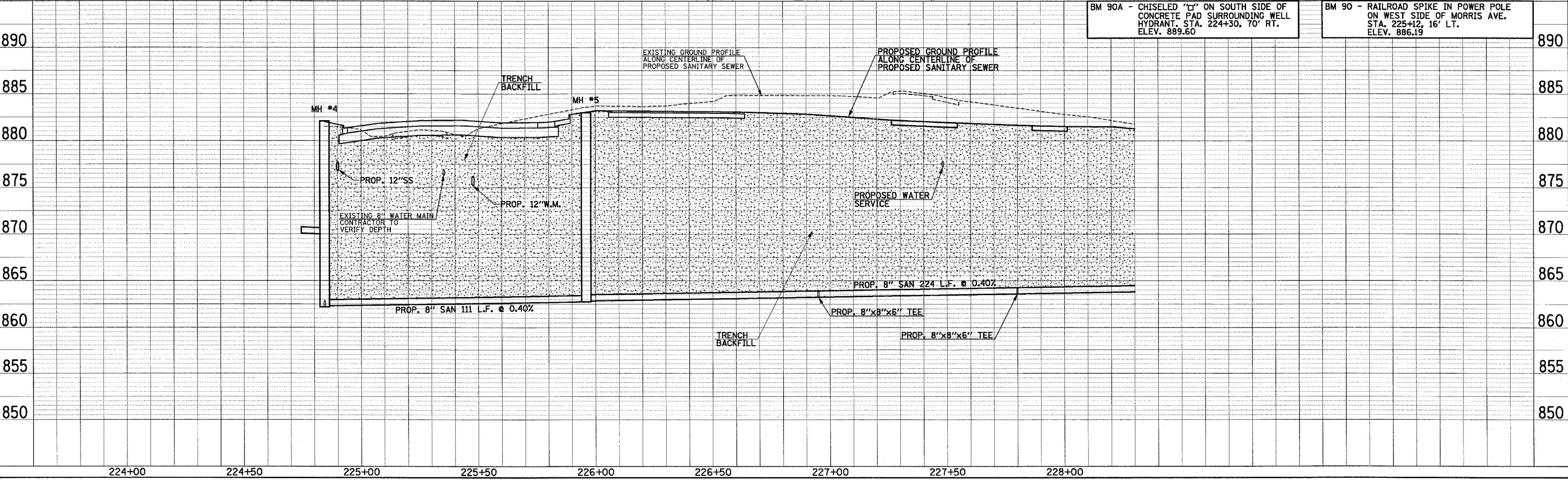

P:\B1091\GEOPAK\2FILES\SANPP3.DGN