

F.A.U. RTE.	SECTION	COUNTY	TOTAL SHEETS	SHEET NO.
6371	93-00295-02-PV	MCLEAN	117	78
STA. 233+00.00		TO STA. 237+00.00		
ILLINOIS				
CONTRACT NO. 87267				

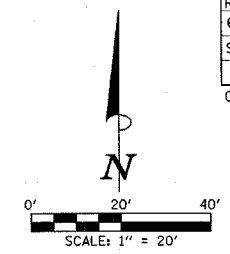

SEC. 17, T.23 N., R.2 E., 3rd P.M.
MCLEAN COUNTY, ILLINOIS

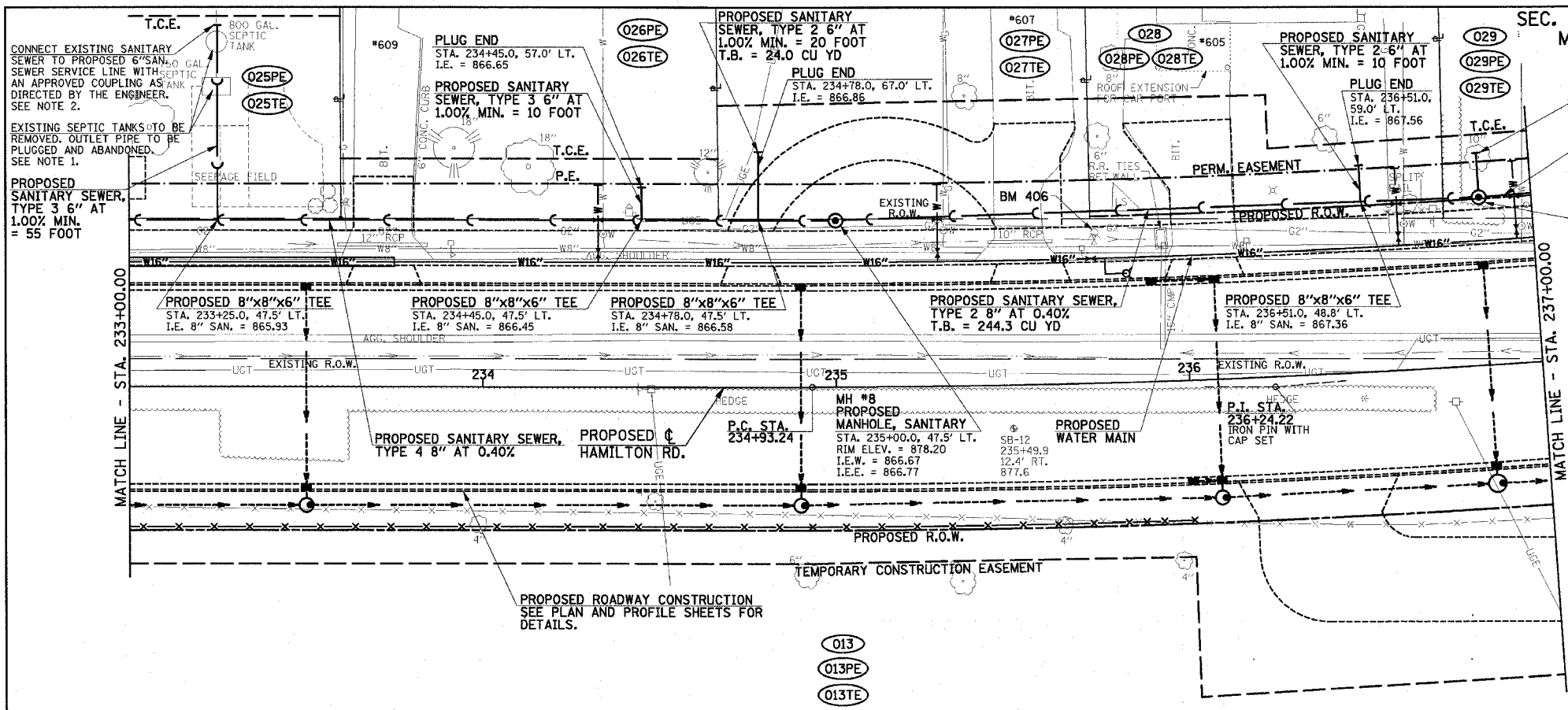

PROPOSED SANITARY SEWER, TYPE 2 6" AT 1.00% MIN. = 10 FOOT
STUB FOR FUTURE CONNECTION, CAP OR PLUG TO SUSTAIN AIR TEST

PROPOSED SANITARY SEWER, TYPE 3 8" AT 0.40% T.B. 250.8 CU YD

MH #9
PROPOSED MANHOLE, SANITARY
STA. 236+85.0, 48.0' LT.
RIM ELEV. = 877.70
I.E.W. = 867.50
I.E.E. = 867.60
I.E.N. = 867.80

PROPOSED HAMILTON RD. CURVE DATA
P.I. STA. 236+24.22
Δ = 5°00'00"
D = 154'35"
T = 130.98'
R = 3000.00'
L = 261.80'
E = 2.86'
P.C. STA. 234+93.24
P.T. STA. 237+55.04
S.E. = NONE

SEE SCHEDULE OF QUANTITIES FOR ADDITIONAL INFORMATION.

SEC. 17, T.23 N., R.2 E., 3rd P.M.
MCLEAN COUNTY, ILLINOIS

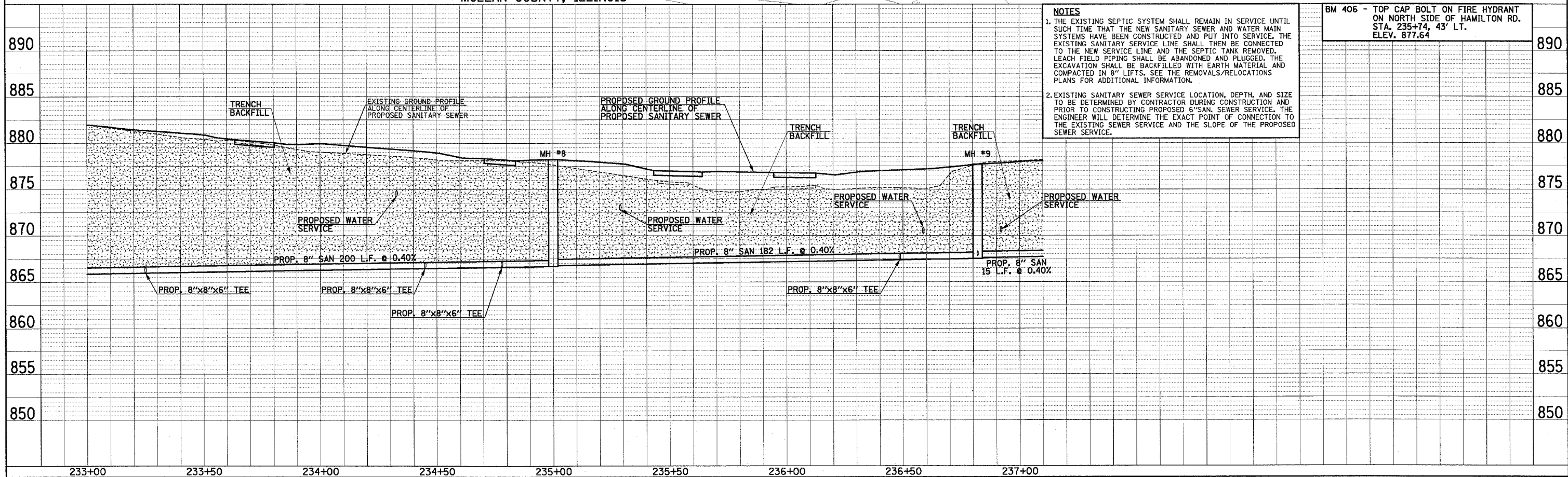

NOTES

1. THE EXISTING SEPTIC SYSTEM SHALL REMAIN IN SERVICE UNTIL SUCH TIME THAT THE NEW SANITARY SEWER AND WATER MAIN SYSTEMS HAVE BEEN CONSTRUCTED AND PUT INTO SERVICE. THE EXISTING SANITARY SERVICE LINE SHALL THEN BE CONNECTED TO THE NEW SERVICE LINE AND THE SEPTIC TANK REMOVED. LEACH FIELD PIPING SHALL BE ABANDONED AND PLUGGED. THE EXCAVATION SHALL BE BACKFILLED WITH EARTH MATERIAL AND COMPACTED IN 8" LIFTS. SEE THE REMOVALS/RELOCATIONS PLANS FOR ADDITIONAL INFORMATION.
2. EXISTING SANITARY SEWER SERVICE LOCATION, DEPTH, AND SIZE TO BE DETERMINED BY CONTRACTOR DURING CONSTRUCTION AND PRIOR TO CONSTRUCTING PROPOSED 6" SAN. SEWER SERVICE. THE ENGINEER WILL DETERMINE THE EXACT POINT OF CONNECTION TO THE EXISTING SEWER SERVICE AND THE SLOPE OF THE PROPOSED SEWER SERVICE.

BM 406 - TOP CAP BOLT ON FIRE HYDRANT ON NORTH SIDE OF HAMILTON RD. STA. 235+74, 43' LT. ELEV. 877.64

DATE	6/1/00
PLAN	
REVISIONS	
NO.	
DATE	
BY	
DESCRIPTION	

DATE	6/1/00
PROFILE	
REVISIONS	
NO.	
DATE	
BY	
DESCRIPTION	