

MINIMUM CLEAR ZONE FOR UNCURBED PAVEMENTS
NO SCALE

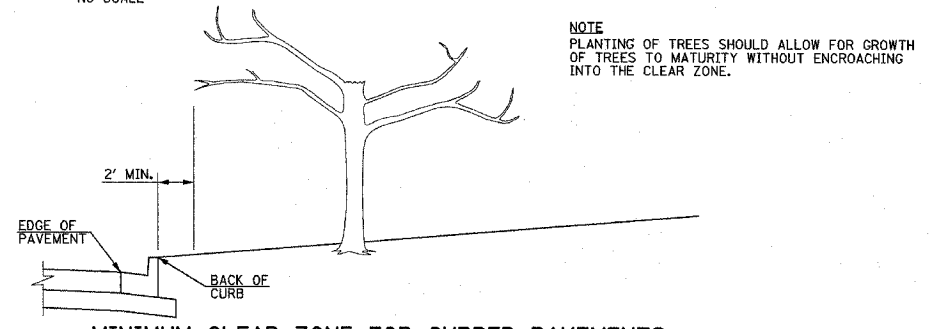

MINIMUM CLEAR ZONE FOR CURBED PAVEMENTS
NO SCALE

NOTE
PLANTING OF TREES SHOULD ALLOW FOR GROWTH OF TREES TO MATURITY WITHOUT ENCRDACHING INTO THE CLEAR ZONE.

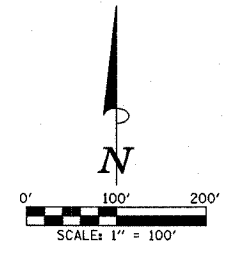

ABBREVIATION	TYPE	UNIT	QUANTITY
AB	TREE, ACER X FREEMANII AUTUMN BLAZE (AUTUMN BLAZE FREEMAN MAPLE), 2" CALIPER, BALLED AND BURLAPPED	EACH	8
TF	TREE, CORYLUS COLURNA (TURKISH FILBERT), 2" CALIPER, BALLED AND BURLAPPED	EACH	8
GB	TREE, GINKGO BILOBA (GINKGO), 2" CALIPER, BALLED AND BURLAPPED	EACH	9
HL	TREE, GLEDITSIA TRIACANTHOS INERMIS (THORNLESS COMMON HONEYLOCUST), 2" CALIPER, BALLED AND BURLAPPED	EACH	4
KC	TREE, GYMNOCLADUS DIOICUS (KENTUCKY COFFEETREE), 2" CALIPER, BALLED AND BURLAPPED	EACH	2
BG	TREE, NYSSA SYLVATICA (BLACK TUPELO), 2" CALIPER, BALLED AND BURLAPPED	EACH	3
AC	TREE, PHELLODENDRON AMURENSE (AMUR CORKTREE), 2" CALIPER, BALLED AND BURLAPPED	EACH	1
SO	TREE, QUERCUS BICOLOR (SWAMP WHITE OAK), 2" CALIPER, BALLED AND BURLAPPED	EACH	5
RO	TREE, QUERCUS RUBRA (RED OAK), 2" CALIPER, BALLED AND BURLAPPED	EACH	3
SL	TREE, TILIA TOMENTOSA STERLING (STERLING SILVER LINDEN), 2" CALIPER, BALLED AND BURLAPPED	EACH	5
LA	TREE, FRAXINUS PENNSYLVANICA LEPRECHAUN (LEPRECHAUN GREEN ASH), 2" CALIPER, BALLED AND BURLAPPED	EACH	2
HM	TREE, ACER CAMPESTRE (HEDGE MAPLE), 2" CALIPER, TREE FORM, BALLED AND BURLAPPED	EACH	1
PM	TREE, ACER GRISEUM (PAPERBARK MAPLE), 2" CALIPER, TREE FORM, BALLED AND BURLAPPED	EACH	2
SB	TREE, AMELANCHIER X GRANDIFLORA AUTUMN BRILLIANCE (AUTUMN BRILLIANCE SERVICE BERRY), 6' HEIGHT, SHRUB FORM, BALLED AND BURLAPPED	EACH	9
PD	TREE, CORNUS ALTERNIFOLIA (PAGODA DOG WOOD), 4' HEIGHT, CLUMP FORM, BALLED AND BURLAPPED	EACH	4
CH	TREE, CRATAEGUS CRUSGALLI INERMIS (THORNLESS COCKSPUR HAWTHORN), 2" CALIPER, TREE FORM, BALLED AND BURLAPPED	EACH	3
AD	TREE, MALUS ADIRONDACK (ADIRONDACK CRABAPPLE), 2" CALIPER, TREE FORM, BALLED AND BURLAPPED	EACH	3
HG	TREE, MALUS HARVEST GOLD (HARVEST GOLD CRABAPPLE), 2" CALIPER, TREE FORM, BALLED AND BURLAPPED	EACH	19
PF	TREE, MALUS PRAIRIFIRE (PRAIRIFIRE CRABAPPLE), 2" CALIPER, TREE FORM, BALLED AND BURLAPPED	EACH	3
ST	TREE, MALUS SUTYZAM (SUGAR TYME CRABAPPLE), 2" CALIPER, TREE FORM, BALLED AND BURLAPPED	EACH	2
IL	TREE, SYRINGA RETICULATA IVORY SILK (IVORY SILK JAPANESE TREE LILAC), 2" CALIPER, TREE FORM, BALLED AND BURLAPPED	EACH	6
WF	EVERGREEN, ABIES CONCOLOR (WHITE FIR), 4' HEIGHT, BALLED AND BURLAPPED	EACH	6
NS	EVERGREEN, PICEA ABIES (NORWAY SPRUCE), 4' HEIGHT, BALLED AND BURLAPPED	EACH	5
SS	EVERGREEN, PICEA OMORIKA (SERBIAN SPRUCE), 4' HEIGHT, BALLED AND BURLAPPED	EACH	6

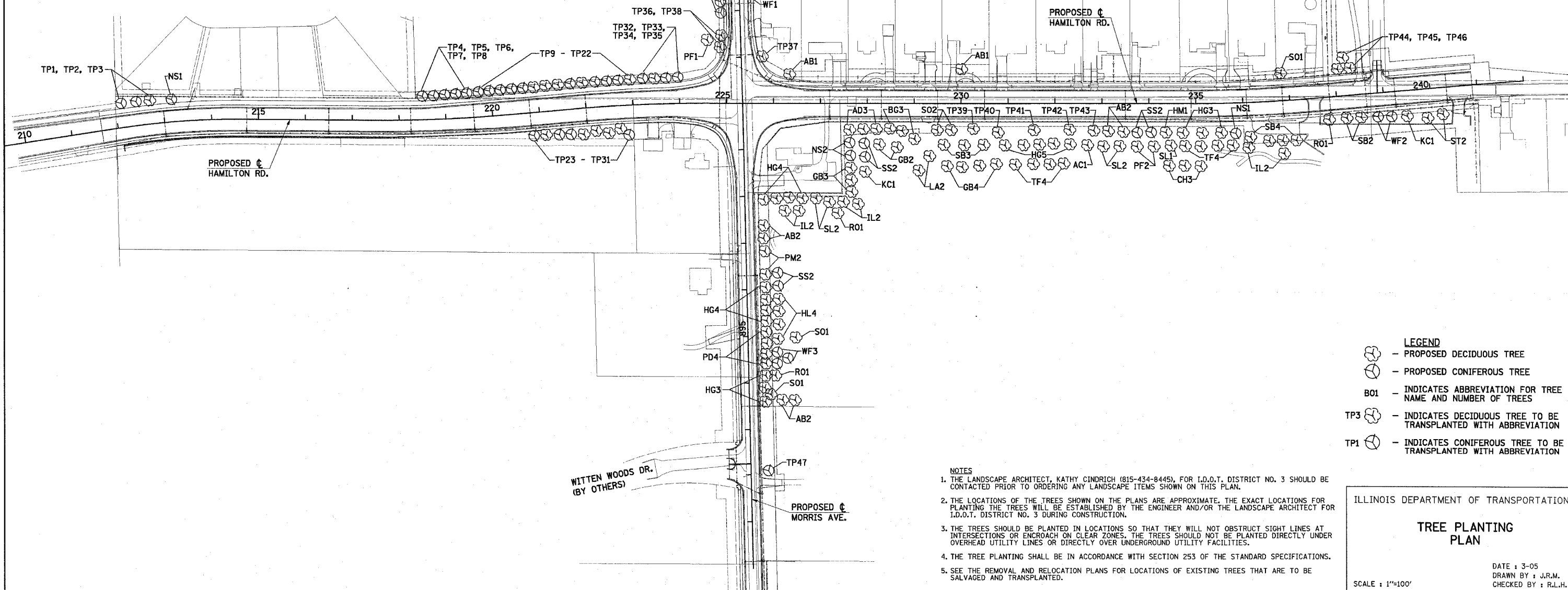

- LEGEND**
- PROPOSED DECIDUOUS TREE
 - PROPOSED CONIFEROUS TREE
 - B01 - INDICATES ABBREVIATION FOR TREE NAME AND NUMBER OF TREES
 - TP3 - INDICATES DECIDUOUS TREE TO BE TRANSPLANTED WITH ABBREVIATION
 - TP1 - INDICATES CONIFEROUS TREE TO BE TRANSPLANTED WITH ABBREVIATION

- NOTES**
1. THE LANDSCAPE ARCHITECT, KATHY CINDRICH (815-434-8445), FOR I.D.O.T. DISTRICT NO. 3 SHOULD BE CONTACTED PRIOR TO ORDERING ANY LANDSCAPE ITEMS SHOWN ON THIS PLAN.
 2. THE LOCATIONS OF THE TREES SHOWN ON THE PLANS ARE APPROXIMATE, THE EXACT LOCATIONS FOR PLANTING THE TREES WILL BE ESTABLISHED BY THE ENGINEER AND/OR THE LANDSCAPE ARCHITECT FOR I.D.O.T. DISTRICT NO. 3 DURING CONSTRUCTION.
 3. THE TREES SHOULD BE PLANTED IN LOCATIONS SO THAT THEY WILL NOT OBSTRUCT SIGHT LINES AT INTERSECTIONS OR ENCRDACH ON CLEAR ZONES. THE TREES SHOULD NOT BE PLANTED DIRECTLY UNDER OVERHEAD UTILITY LINES OR DIRECTLY OVER UNDERGROUND UTILITY FACILITIES.
 4. THE TREE PLANTING SHALL BE IN ACCORDANCE WITH SECTION 253 OF THE STANDARD SPECIFICATIONS.
 5. SEE THE REMOVAL AND RELOCATION PLANS FOR LOCATIONS OF EXISTING TREES THAT ARE TO BE SALVAGED AND TRANSPLANTED.

ILLINOIS DEPARTMENT OF TRANSPORTATION

TREE PLANTING PLAN

DATE : 3-05
DRAWN BY : J.R.M.
CHECKED BY : R.L.H.

SCALE : 1"=100'