

DATE	BY
SURVEYED	PLOTTED
REPLATE	AREAS CHECKED
NO.	

DATE	BY
SURVEYED	PLOTTED
REPLATE	AREAS CHECKED
NO.	

F.A.U. SECTION COUNTY TOTAL SHEET SHEETS NO.
6371 93-00295-02-PV MCLEAN 117 110
STA. 891+00.00 TO STA. 892+23.35
ILLINOIS

CONTRACT NO. 87267

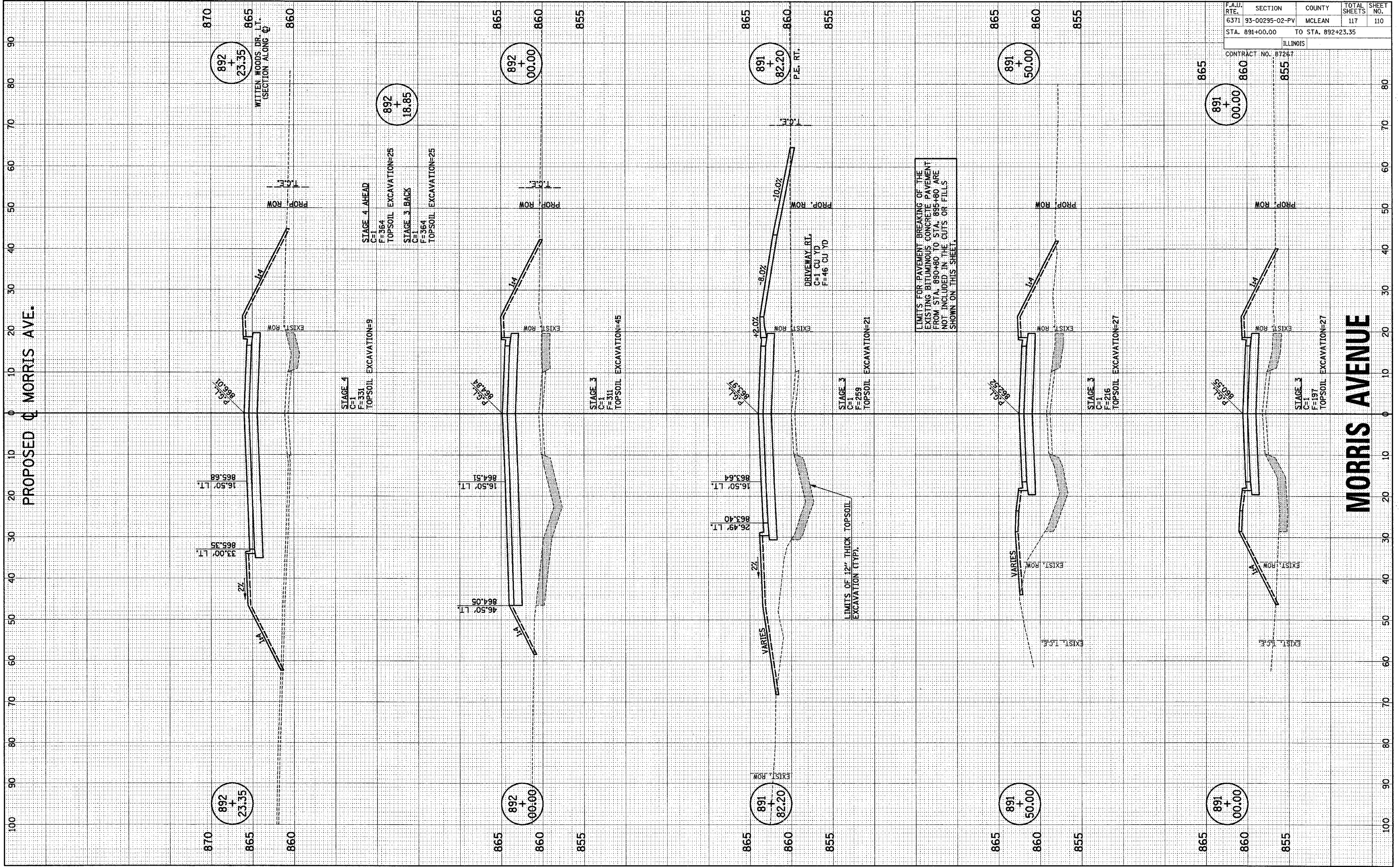

LIMITS FOR PAVEMENT BREAKING OF THE EXISTING BITUMINOUS CONCRETE PAVEMENT FROM STA. 890+80 TO STA. 895+80 ARE NOT INCLUDED IN THE CUTS OR FILLS SHOWN ON THIS SHEET.

LIMITS OF 12" THICK TOPSOIL EXCAVATION (TYP).

PROPOSED MORRIS AVE.

MORRIS AVENUE

P:\B11091\GEOPAK\2DFILES\MORRISXSHT.DGN