

F.A. RTE.	SECTION	COUNTY	TOTAL SHEETS	SHEET NO.
642		COLES	157	22
STA. 326+00.00		TO STA. 637+00.00		
FED. ROAD DIST. NO.		ILLINOIS FED. AID PROJECT		
* 99-00124-01-PV				

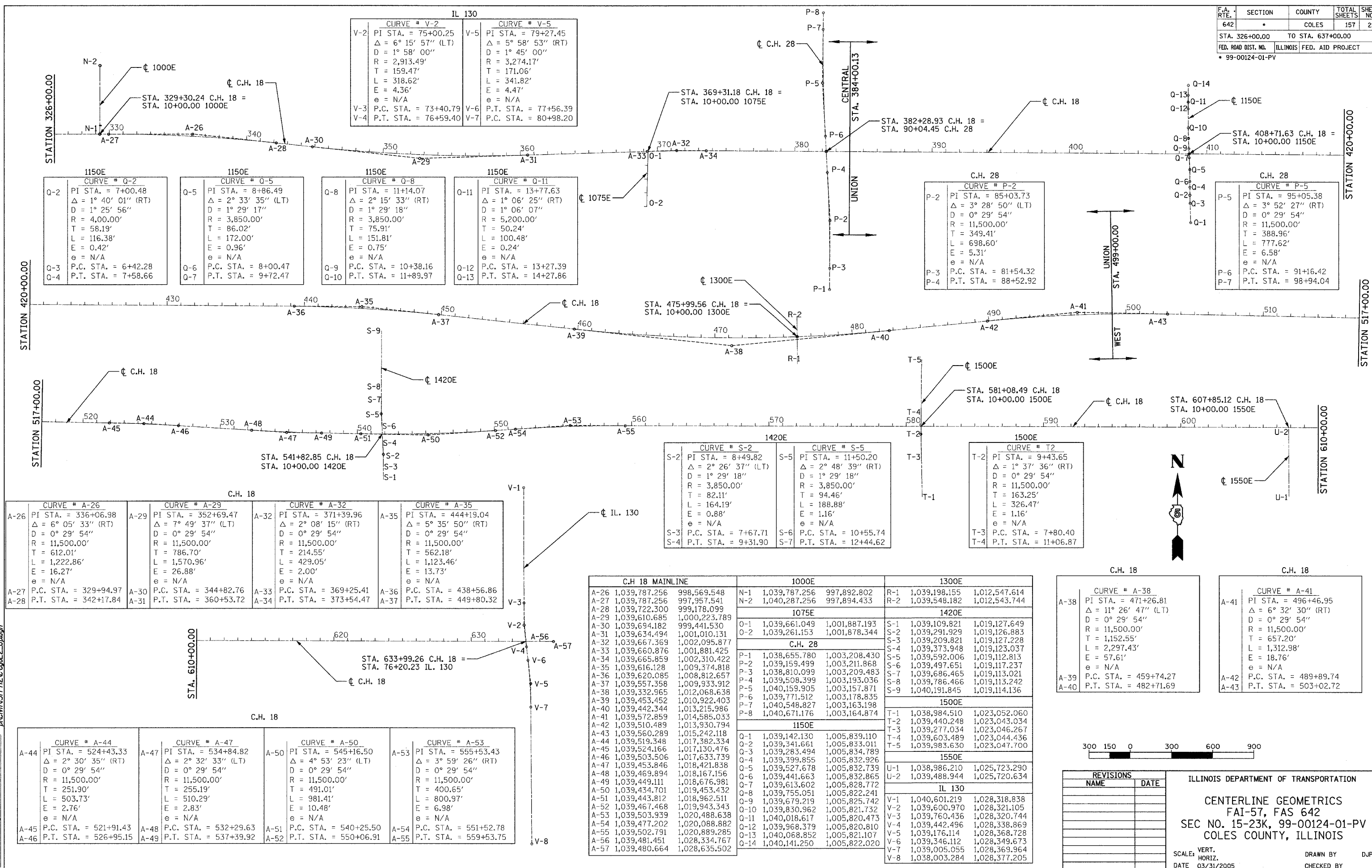

03/31/2005
 P:\CIVIL\STPH\99-00124-01-PV.dwg

LAYOUT	DJP	11/23/03
DRAWN	DJP	11/23/03
REVIEWED		

CURVE # A-26		CURVE # A-29		CURVE # A-32		CURVE # A-35	
A-26	PI STA. = 336+06.98	A-29	PI STA. = 352+69.47	A-32	PI STA. = 371+39.96	A-35	PI STA. = 444+19.04
	$\Delta = 6^\circ 05' 33''$ (RT)		$\Delta = 7^\circ 49' 37''$ (LT)		$\Delta = 2^\circ 08' 15''$ (RT)		$\Delta = 5^\circ 35' 50''$ (RT)
	D = 0° 29' 54"		D = 0° 29' 54"		D = 0° 29' 54"		D = 0° 29' 54"
	R = 11,500.00'		R = 11,500.00'		R = 11,500.00'		R = 11,500.00'
	T = 612.01'		T = 786.70'		T = 214.55'		T = 562.18'
	L = 1,222.86'		L = 1,570.96'		L = 429.05'		L = 1,123.46'
	E = 16.27'		E = 26.88'		E = 2.00'		E = 13.73'
	e = N/A		e = N/A		e = N/A		e = N/A
A-27	P.C. STA. = 329+94.97	A-30	P.C. STA. = 344+82.76	A-33	P.C. STA. = 369+25.41	A-36	P.C. STA. = 438+56.86
A-28	P.T. STA. = 342+17.84	A-31	P.T. STA. = 360+53.72	A-34	P.T. STA. = 373+54.47	A-37	P.T. STA. = 449+80.32

CURVE # A-44		CURVE # A-47		CURVE # A-50		CURVE # A-53	
A-44	PI STA. = 524+43.33	A-47	PI STA. = 534+84.82	A-50	PI STA. = 545+16.50	A-53	PI STA. = 555+53.43
	$\Delta = 2^\circ 30' 35''$ (RT)		$\Delta = 2^\circ 32' 33''$ (LT)		$\Delta = 4^\circ 53' 23''$ (LT)		$\Delta = 3^\circ 59' 26''$ (RT)
	D = 0° 29' 54"		D = 0° 29' 54"		D = 0° 29' 54"		D = 0° 29' 54"
	R = 11,500.00'		R = 11,500.00'		R = 11,500.00'		R = 11,500.00'
	T = 251.90'		T = 255.19'		T = 491.01'		T = 400.65'
	L = 503.73'		L = 510.29'		L = 981.41'		L = 800.97'
	E = 2.76'		E = 2.83'		E = 10.48'		E = 6.98'
	e = N/A		e = N/A		e = N/A		e = N/A
A-45	P.C. STA. = 521+91.43	A-48	P.C. STA. = 532+29.63	A-51	P.C. STA. = 540+25.50	A-54	P.C. STA. = 551+52.78
A-46	P.T. STA. = 526+95.15	A-49	P.T. STA. = 537+39.92	A-52	P.T. STA. = 550+06.91	A-55	P.T. STA. = 559+53.75

CURVE # A-26		CURVE # A-29		CURVE # A-32		CURVE # A-35	
A-26	PI STA. = 336+06.98	A-29	PI STA. = 352+69.47	A-32	PI STA. = 371+39.96	A-35	PI STA. = 444+19.04
	$\Delta = 6^\circ 05' 33''$ (RT)		$\Delta = 7^\circ 49' 37''$ (LT)		$\Delta = 2^\circ 08' 15''$ (RT)		$\Delta = 5^\circ 35' 50''$ (RT)
	D = 0° 29' 54"		D = 0° 29' 54"		D = 0° 29' 54"		D = 0° 29' 54"
	R = 11,500.00'		R = 11,500.00'		R = 11,500.00'		R = 11,500.00'
	T = 612.01'		T = 786.70'		T = 214.55'		T = 562.18'
	L = 1,222.86'		L = 1,570.96'		L = 429.05'		L = 1,123.46'
	E = 16.27'		E = 26.88'		E = 2.00'		E = 13.73'
	e = N/A		e = N/A		e = N/A		e = N/A
A-27	P.C. STA. = 329+94.97	A-30	P.C. STA. = 344+82.76	A-33	P.C. STA. = 369+25.41	A-36	P.C. STA. = 438+56.86
A-28	P.T. STA. = 342+17.84	A-31	P.T. STA. = 360+53.72	A-34	P.T. STA. = 373+54.47	A-37	P.T. STA. = 449+80.32

C.H. 18 MAINLINE		1000E		1300E		
A-26	1,039,787.256	998,569.548	N-1	1,039,787.256	997,892.802	
A-27	1,039,787.256	997,957.541	N-2	1,040,287.256	997,894.433	
A-28	1,039,722.300	999,178.099	1075E		1420E	
A-29	1,039,610.685	1,000,223.789	O-1	1,039,661.049	1,001,887.193	
A-30	1,039,694.182	999,441.530	O-2	1,039,261.153	1,001,878.344	
A-31	1,039,634.494	1,001,010.131	C.H. 28		S-1	1,039,109.821
A-32	1,039,667.369	1,002,095.877	P-1	1,038,655.780	1,003,208.430	
A-33	1,039,660.876	1,001,881.425	P-2	1,039,159.499	1,003,211.868	
A-34	1,039,665.859	1,002,310.422	P-3	1,038,810.099	1,003,209.483	
A-35	1,039,616.128	1,009,374.818	P-4	1,039,508.399	1,003,193.036	
A-36	1,039,620.085	1,008,812.657	P-5	1,040,159.905	1,003,157.871	
A-37	1,039,557.358	1,009,933.912	P-6	1,039,771.512	1,003,178.835	
A-38	1,039,332.965	1,012,068.638	P-7	1,040,548.827	1,003,163.198	
A-39	1,039,453.452	1,010,922.403	P-8	1,040,671.176	1,003,164.874	
A-40	1,039,442.344	1,013,215.986	1500E		T-1	1,038,984.510
A-41	1,039,572.859	1,014,585.033	T-2	1,039,440.248	1,023,043.034	
A-42	1,039,510.489	1,013,930.794	T-3	1,039,277.034	1,023,046.267	
A-43	1,039,560.289	1,015,242.118	T-4	1,039,603.489	1,023,044.436	
A-44	1,039,519.348	1,017,382.334	T-5	1,039,983.630	1,023,047.700	
A-45	1,039,524.166	1,017,130.474	1550E		U-1	1,038,986.210
A-46	1,039,503.506	1,017,633.739	U-2	1,039,488.944	1,025,720.634	
A-47	1,039,453.846	1,018,421.838	IL 130		V-1	1,040,601.219
A-48	1,039,469.894	1,018,167.156	V-2	1,039,600.970	1,028,321.105	
A-49	1,039,449.111	1,018,676.981	V-3	1,039,760.436	1,028,320.744	
A-50	1,039,434.701	1,019,453.432	V-4	1,039,442.496	1,028,338.869	
A-51	1,039,443.812	1,018,962.511	V-5	1,039,176.114	1,028,368.728	
A-52	1,039,467.468	1,019,943.343	V-6	1,039,346.112	1,028,349.673	
A-53	1,039,503.939	1,020,488.638	V-7	1,039,005.055	1,028,369.964	
A-54	1,039,477.202	1,020,088.882	V-8	1,038,003.284	1,028,377.205	
A-55	1,039,502.791	1,020,889.285				
A-56	1,039,481.451	1,028,334.767				
A-57	1,039,480.664	1,028,635.502				

CURVE # A-38		CURVE # A-41	
A-38	PI STA. = 471+26.81	A-41	PI STA. = 496+46.95
	$\Delta = 11^\circ 26' 47''$ (LT)		$\Delta = 6^\circ 32' 30''$ (RT)
	D = 0° 29' 54"		D = 0° 29' 54"
	R = 11,500.00'		R = 11,500.00'
	T = 1,152.55'		T = 657.20'
	L = 2,297.43'		L = 1,312.98'
	E = 57.61'		E = 18.76'
	e = N/A		e = N/A
A-39	P.C. STA. = 459+74.27	A-42	P.C. STA. = 489+89.74
A-40	P.T. STA. = 482+71.69	A-43	P.T. STA. = 503+02.72

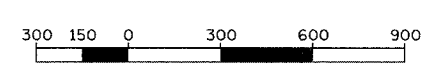

REVISIONS	
NAME	DATE

ILLINOIS DEPARTMENT OF TRANSPORTATION

CENTERLINE GEOMETRICS
 FAI-57, FAS 642
 SEC NO. 15-23K, 99-00124-01-PV
 COLES COUNTY, ILLINOIS

SCALE: VERT. HORIZ.
 DATE 03/31/2005

DRAWN BY DJP
 CHECKED BY