

F.A.S. RTE.	SECTION	COUNTY	TOTAL SHEETS	SHEET NO.
642	99-00124-01-PV	COLES	157	39
STA. 156+00		TO STA. 171+00		
FED. ROAD DIST. NO.	ILLINOIS	FED. AID PROJECT		

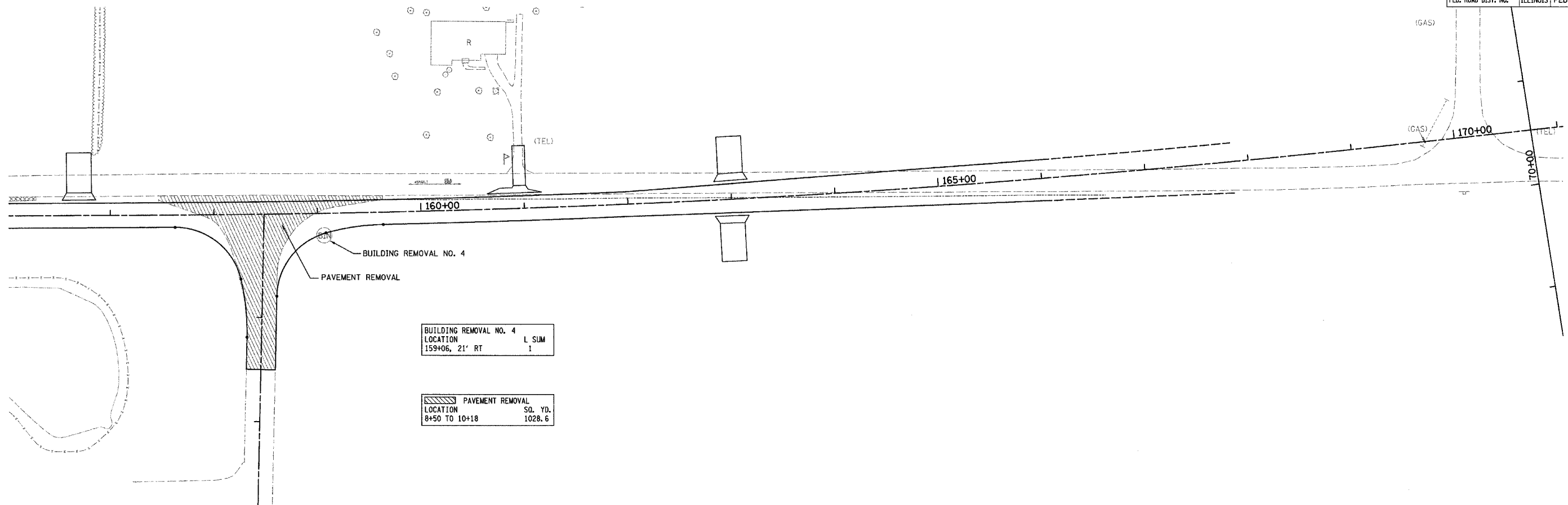

BUILDING REMOVAL NO. 4	
LOCATION	L. SUM
159+06, 21' RT	1

PAVEMENT REMOVAL	
LOCATION	SQ. YD.
8+50 TO 10+18	1028.6

REVISIONS	
NAME	DATE

ILLINOIS DEPARTMENT OF TRANSPORTATION

**REMOVAL PLAN**

SCALE: VERT.      DRAWN BY      RLH  
 HORIZ. 1" = 50'  
 DATE 08/12/2005      CHECKED BY      MED

TUG PROJ. #1387022-5  
 .. SHEET REMOVAL-W.dgn  
 08/12/2005