

F.A.S. RTE.	SECTION	COUNTY	TOTAL SHEETS	SHEET NO.
642	99-00124-01-PV	COLES	157	62
STA. 100+00		TO STA. 121+16		
FED. ROAD DIST. NO.	ILLINOIS	FED. AID PROJECT		

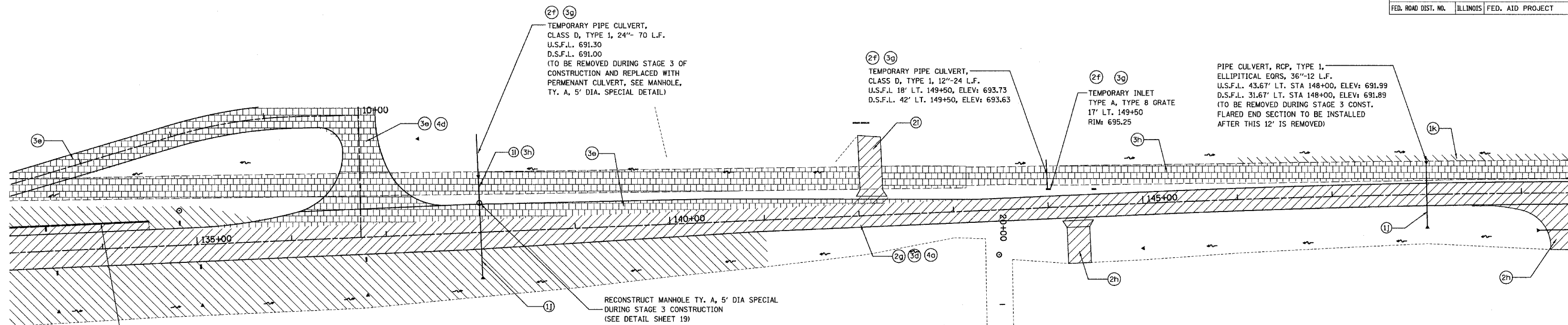

STAGE 1, STA 133+00 TO STA 166+00

- 1j) CONSTRUCT CULVERTS, EMBANKMENT, MSE WALL AND DITCHES, STA 133+00 TO STA 141+00 (CH 18)
- 1k) WIDEN EXISTING C.H. 18, STA 146+00 TO STA 159+00 LEFT
- 1l) NOTE: C.H. 18 SHALL REMAIN OPEN AT ALL TIMES EAST OF U.S. ROUTE 45.

STAGE 1 CONSTRUCTION

STAGE 2, STA 133+00 TO STA 166+00

- 2a) CLOSE C.H. 18 TO THROUGH TRAFFIC FROM U.S. ROUTE 45 TO C.RD. 700E.
- 2f) CONSTRUCT TEMPORARY INLETS BETWEEN EXISTING AND PROPOSED C.H.18 PAVEMENTS, CONSTRUCT TEMPORARY CULVERTS ACROSS EXISTING C.H. 18, CONSTRUCT TEMPORARY DITCHES BETWEEN EXISTING C.H. 18 AND PROPOSED C.H. 18 STA 144+50 TO STA 158+50 LEFT.
- 2g) C.H. 18, CONSTRUCT REMAINING CULVERTS, EARTHWORK AND ALL ROADWAY PAVING STA 133+00 TO STA 166+00, EXCEPT THE AREA LEFT OF PROPOSED C.H. 18 THAT CAN NOT BE DISTURBED IN ORDER TO MAINTAIN TRAFFIC ON EXISTING C.H. 18, INCLUDING THE RIGHT TURN LANE STATION 136+00 TO 142+00. (SEE TEMPORARY CROSS-SECTION LINE) CONSTRUCT IN STAGES AS NECESSARY TO MAINTAIN TRAFFIC
- 2h) CONSTRUCT COMMERCIAL ENTRANCES, LOGAN STREET RETURN, AND SHOULDER PAVING ADJACENT TO EAST BOUND LANE. CONSTRUCT IN STAGES AS NECESSARY TO MAINTAIN TRAFFIC.
- 2i) CONSTRUCT ENTRANCE AT STA 142+14 LEFT TO BE USED AS A TEMPORARY TRUCK ENTRANCE FOR MASTERFOODS USA

STAGE 2 CONSTRUCTION

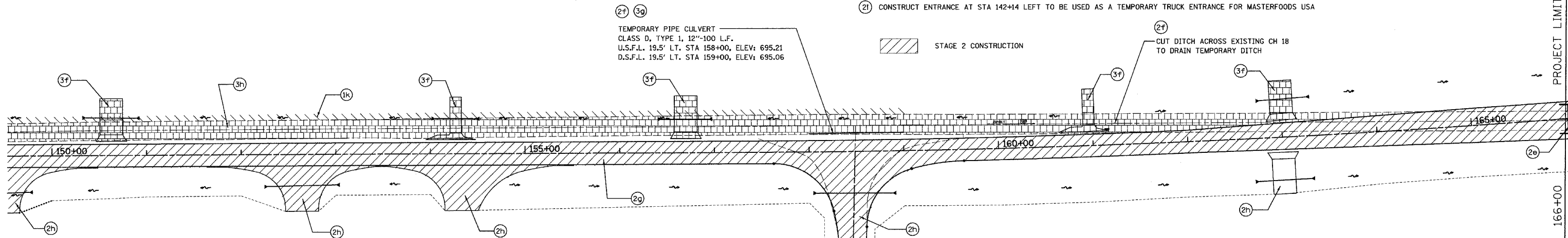

STAGE 3, STA 133+00 TO STA 166+00

- 3d) OPEN NEW C.H. 18 TO LOCAL TRAFFIC. CLOSE EXISTING C.H. 18 EAST OF STA. 130+50
- 3e) CONSTRUCT THE NEW ENTRANCE AT STA 136+73 INCLUDING THE RIGHT TURN LANE.
- 3f) CONSTRUCT ENTRANCES ADJACENT TO WEST BOUND C.H. 18. CONSTRUCT IN STAGES AS NECESSARY TO MAINTAIN TRAFFIC.
- 3g) REMOVE AND SALVAGE TEMPORARY INLETS AND CULVERTS STA 125+00 TO STA 158+50 LEFT.
- 3h) C.H. 18, REMOVE EXISTING PCC PAVEMENT STA 132+60 TO STA 143+13 LEFT. OBLITERATE REMAINING EXISTING C.H. 18 ROADWAY, STA 143+13 TO STA 161+25, COMPLETE CONSTRUCTION OF WEST BOUND SHOULDERS AND DITCHES STA 137+00 TO STA 166+00 LEFT.

STAGE 3 CONSTRUCTION

STAGE 4, STA 133+00 TO STA 166+00

- 4a) OPEN C.H. TO ALL TRAFFIC
- 4d) OPEN NEW ENTRANCE AT 136+73

STAGE 4 CONSTRUCTION

REVISIONS	
NAME	DATE

ILLINOIS DEPARTMENT OF TRANSPORTATION

STAGING PLAN

SCALE: VERT. 1" = 50'
HORIZ. 1" = 50'
DATE 04/01/2005

DRAWN BY SJF
CHECKED BY MED

C.H. 18, STA. 133+00 TO STA. 166+00

TUC PROJ. #191022-5
STAGING 50'
04/01/2005