

F.A.S. RTE.	SECTION	COUNTY	TOTAL SHEETS	SHEET NO.
642	99-00124-01-PV	COLES	157	82
STA.	TO STA.			
FED. ROAD DIST. NO.	ILLINOIS	FED. AID PROJECT		

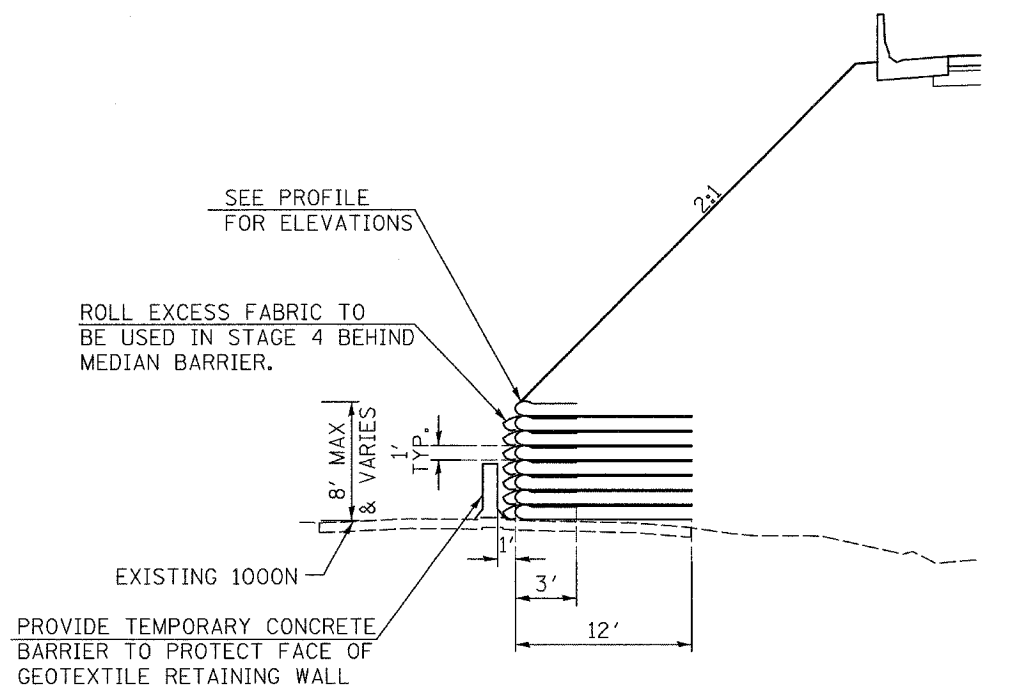

SECTION A-A
STAGE 1, 2, AND 3

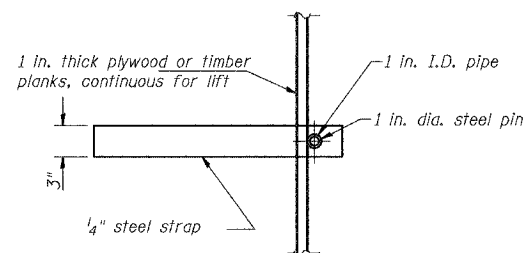

Note:
This is a suggested detail, the Contractor is responsible for the design of the form brace system to be used.

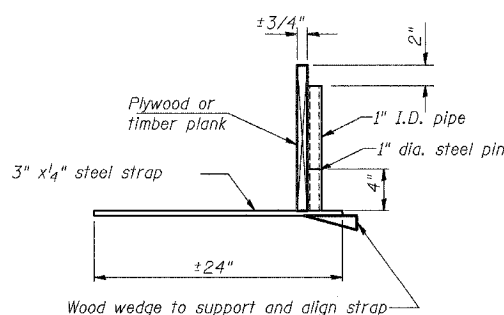

SUGGESTED GEOTEXTILE TEMPORARY
FORM BRACE SYSTEM DETAIL

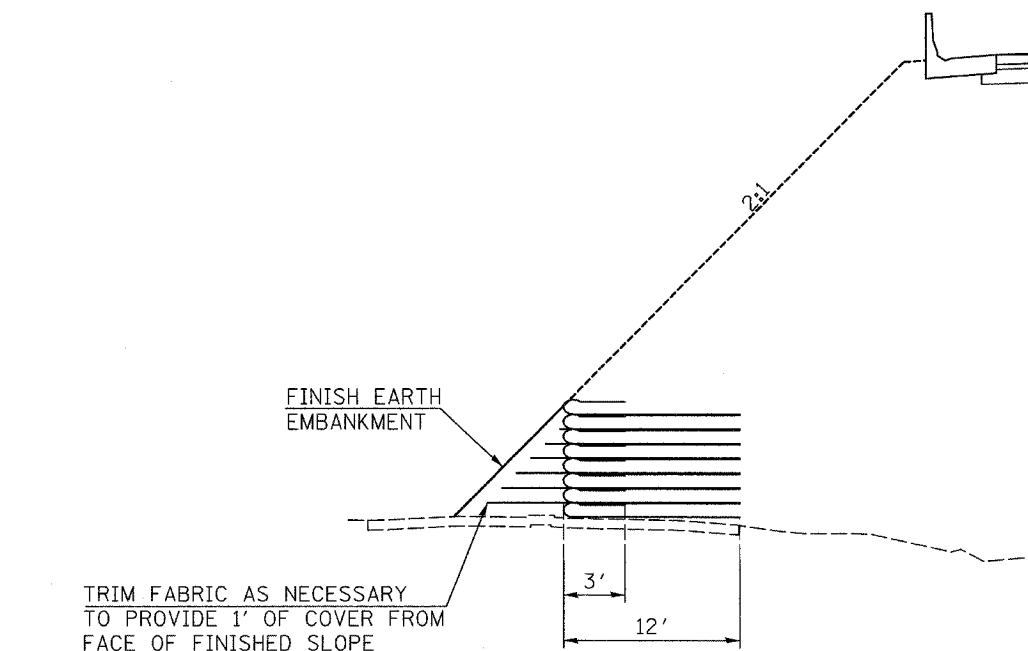

SECTION A-A
STAGE 4

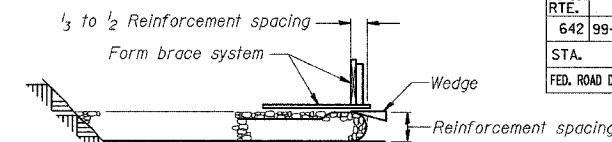

1. Place form brace system on completed reinforcement level; back from the finished fabric face a distance of 1/3 to 1/2 the reinforcement spacing.

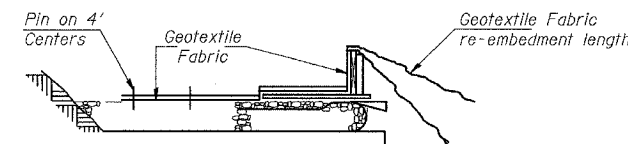

2. Position fabric so that the required re-embedment length extends over the top of the form brace and the design reinforcement width is placed with no slack against the previous level.

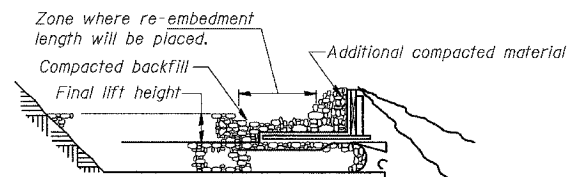

3. Compact backfill material in lifts to final lift height, create (±3 in) depression in zone where re-embedment length will be located and place additional height of compacted material against form brace.

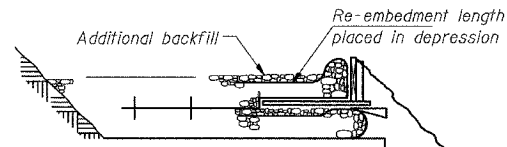

4. Fold fabric re-embedment length back over form brace into zone where depression was made in backfill and place additional compacted backfill, (±3 in) to embed fabric and bring to final lift height.

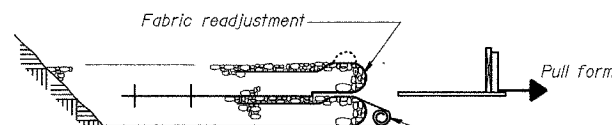

5. Pull form brace outward allowing fabric face to slightly readjust to form tight round face and level with plan reinforcement spacing. Roll unused layer of fabric to be incorporated into final earth embankment and place at base of wall behind median barrier to prevent damage to fabric.

**GEOTEXTILE WALL
CONSTRUCTION PROCEDURE**

Notes: The geotextile fabric shall have a minimum allowable tensile strength (T min.) of 0.45 kip/ft as determined by the procedure stated in the Special Provisions. The computations supporting the determination of (T_a) shall be submitted to the engineer for approval.

REVISIONS	
NAME	DATE

ILLINOIS DEPARTMENT OF TRANSPORTATION

**TEMPORARY GEOTEXTILE
RETAINING WALL**

SCALE: VERT.
HORIZ.
DATE 04/04/2005

DRAWN BY RLH
CHECKED BY MED

TUC PROJ #181022-5
SHEET 2 OF 2
04/04/2005