

Benchmark: B.M. 600A Top Cap Bolt next to M in Mueller.
1st F.H. E of Inters. 620E/1000N,
S. Side of Rd. Elev. 699.58
Existing Structure: None

Contract 91222

F.A.P. RTE.	SECTION	COUNTY	TOTAL SHEETS	SHEET NO.
642	99-00124-01-PV	COLES	157	84
STA.	TO STA.			
FED. ROAD DIST. NO.	ILLINOIS	FED. AID PROJECT		

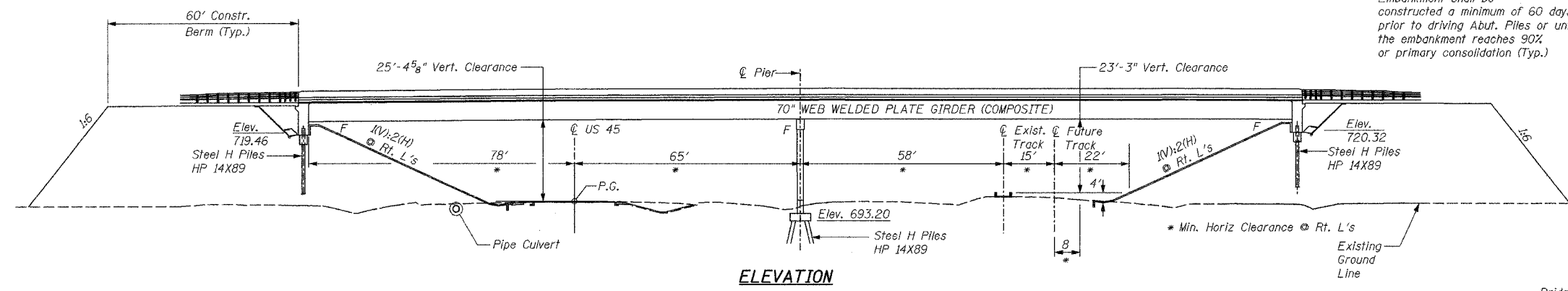

Embankment shall be constructed a minimum of 60 days prior to driving Abut. Piles or until the embankment reaches 90% or primary consolidation (Typ.)

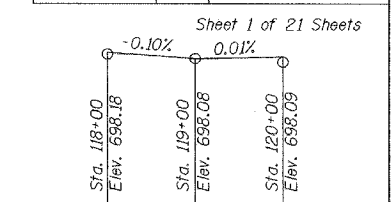

PROFILE GRADE (RTE. 45)
Along C

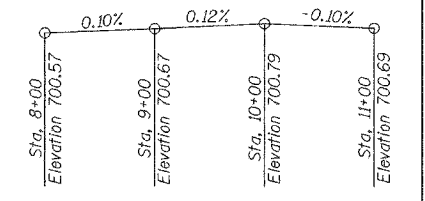

TOP OF RAIL ELEVATIONS
Along East Rail

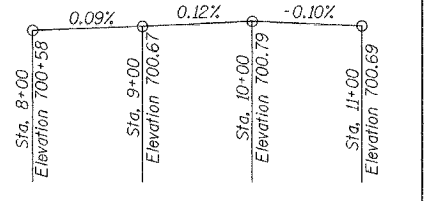

TOP OF RAIL ELEVATIONS
Along West Rail

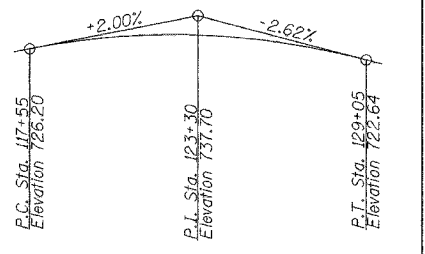

PROFILE GRADE (CH18)
Along C

MARTIN J. SILVESTER
081-004378
LICENSED
STRUCTURAL
ENGINEER
OF
CHICAGO, ILLINOIS
MARTIN J. SILVESTER
STRUCTURAL ENGINEER
LICENSE EXP. DATE 11-30-06
10-06-05

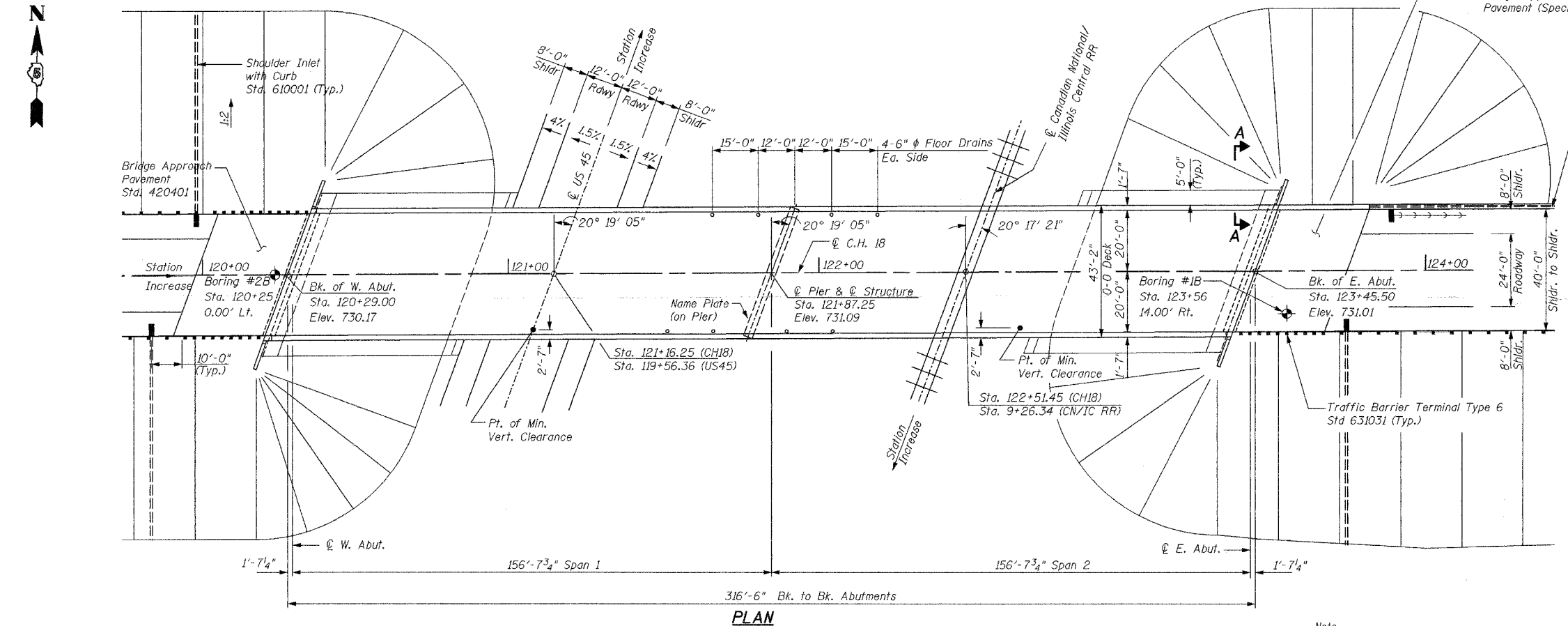

MSE Retaining Wall (SN015-3142 for details see Sheets 1 and 2 of 3) and F Shape Conc. Parapet (for details see sheet 3 of 3)

Note:
For Section A-A see Sheet 3 of 21

DESIGN STRESSES

FIELD UNITS
f_c = 3500 psi
f_y = 60000 psi (Reinf.)
F_y = 50000 psi (Structural Steel) (AASHTO M270 Grade 50)
F_y = 36000 psi (Structural Steel) (AASHTO M270 Grade 36)

SEISMIC DATA

Seismic Performance Category (SPC) = A
Bedrock Acceleration Coefficient (A) = 0.058g
Site Coefficient (S) = 1.0

LOADING HS 20-44

Allow 50 Lb/Sq. Ft. for future wearing surface.

DESIGN SPECIFICATIONS

AASHTO 2002

STATION 121+87.25
BUILT 20 BY
COLES COUNTY
F.A.S. RT. 642 SEC. 99-00124-01-PV
LOADING HS20
STR. NO. 015-3400

NAME PLATE

See Std. 515001

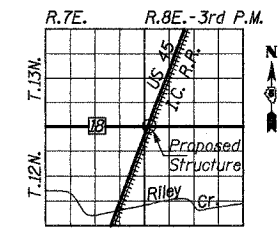

LOCATION SKETCH

REVISIONS	
NAME	DATE

ILLINOIS DEPARTMENT OF TRANSPORTATION
GENERAL PLAN
CH 18 OVER US 45 AND CN/IC RR
FAS 642 SECTION 99-00124-01-PV
COLES COUNTY
STA. 121+87.25 STR. No. 015-3400
SCALE: 1"=20'-0"
DATE: 1-21-2004
DRAWN BY LMP
CHECKED BY MJS

THE UPCHURCH GROUP
HILLSIDE, IL. (708) 449-2321
MATTOON, IL. (217) 235-3177