

F.A.P. RTE.	SECTION	COUNTY	TOTAL SHEETS	SHEET NO.
642	99-00124-01-PV	COLES	157	90
STA.	TO STA.			
FED. ROAD DIST. NO.	ILLINOIS	FED. AID PROJECT		

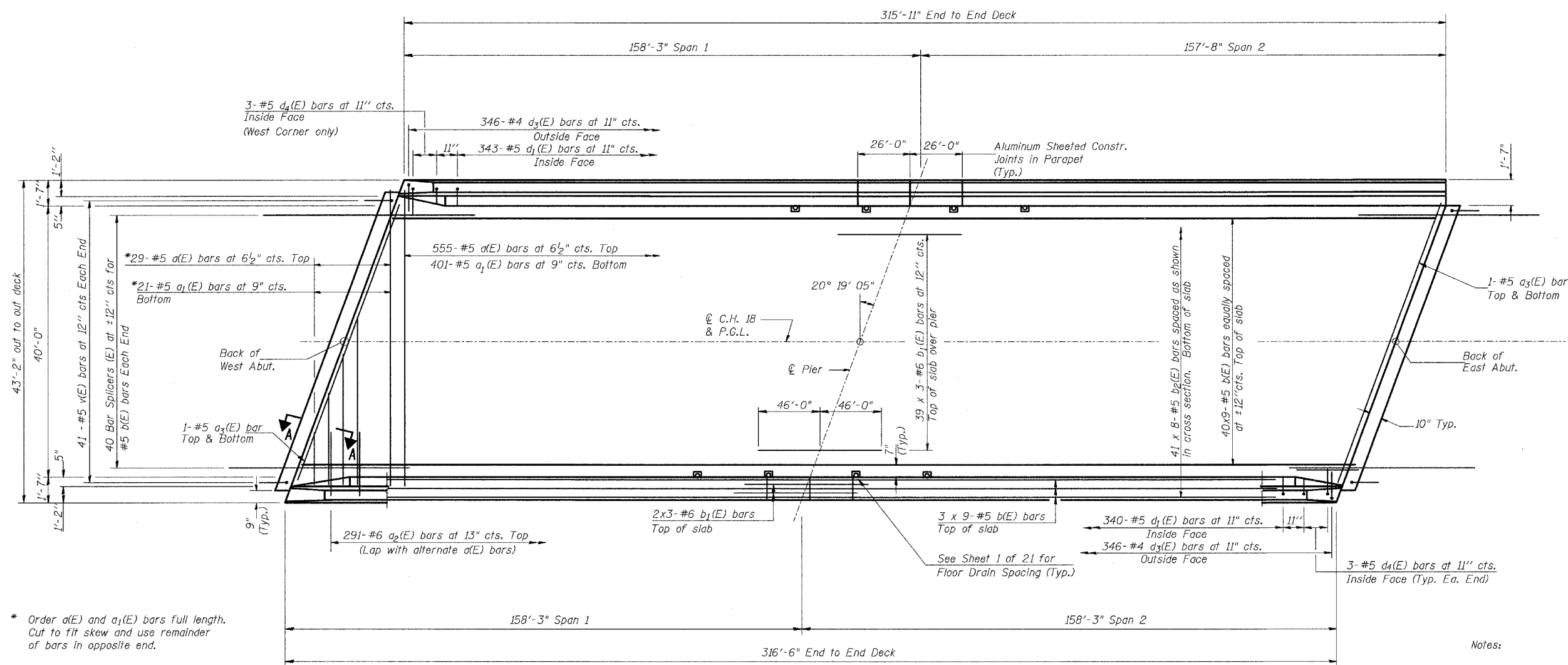

**PLAN**

\* Order a(E) and a<sub>1</sub>(E) bars full length. Cut to fit skew and use remainder of bars in opposite end.

**Notes:**

See Sheet 9 of 21 for superstructure details and Bill of Material.

Reinforcement bars designated (E) shall be epoxy coated.

Bars indicated thus 36 x 9-#5 etc. indicates 36 lines of bars with 9 lengths per line.

See Sheet 9 of 21 for parapet reinforcement.

Reinforcement bars shown on this sheet are included in Bill of Material on Sheet 9 of 21.

See Sheet 8 of 21 for details of End Diaphragm and Section A-A.

Work this sheet with Sheet 8 and 9 of 21.

See sheet 18 of 21 for Bar Splicer Details.

**MIN. BAR LAP**

#5 Bar = 1'-8"  
#6 Bar = 2'-0"

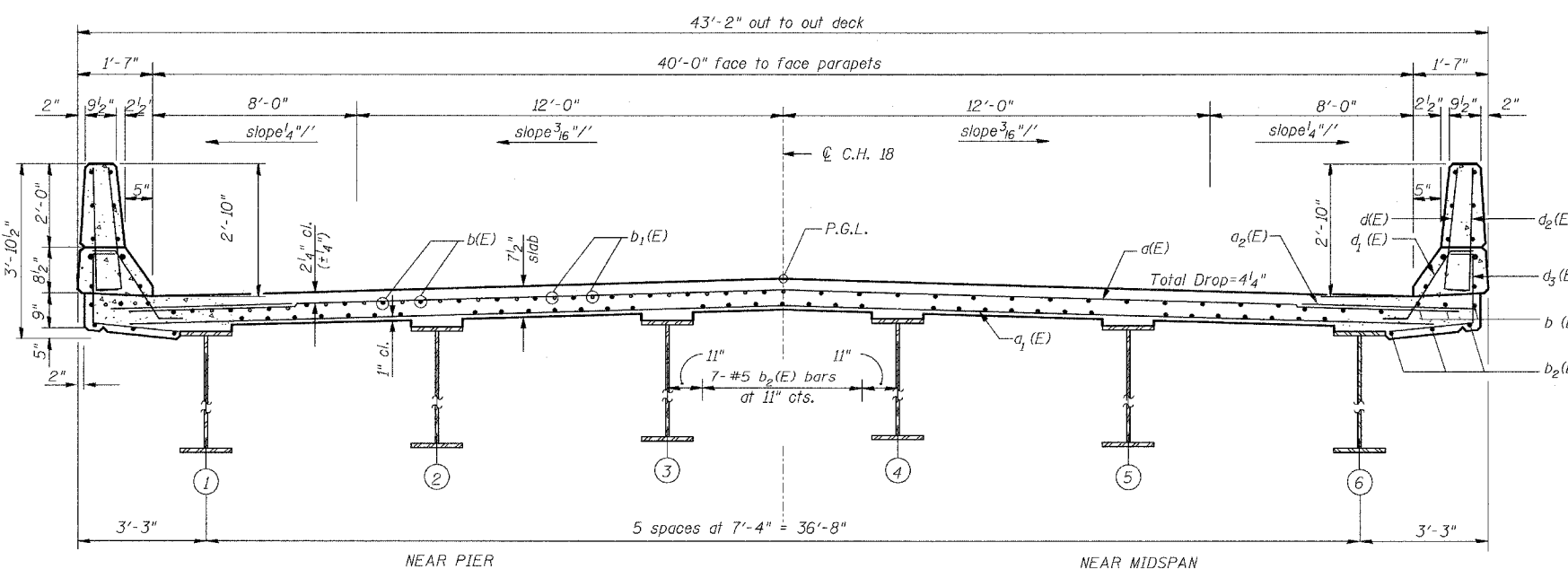

**CROSS SECTION**  
(Looking Upstation)

**THE UPCHURCH GROUP**

HILLSIDE, IL. (708) 449-2321  
MATTOON, IL. (217) 235-3177

REVISIONS	
NAME	DATE

ILLINOIS DEPARTMENT OF TRANSPORTATION  
**DECK DETAILS**  
CH 18 OVER US 45 AND CN/IC RR  
FAS 642 SECTION 99-00124-01-PV  
COLES COUNTY  
STA. 121+87.25 STR. No. 015-3400

SCALE: DRAWN BY LMP  
DATE: 1-21-2004 CHECKED BY MJS