

STATE OF ILLINOIS DEPARTMENT OF TRANSPORTATION PLANS FOR PROPOSED BRIDGE REPLACEMENT AND REHABILITATION PROGRAM INGRAM HILL ROAD BRIDGE

FUNCTIONAL CLASS: LOCAL ROAD

ADT (2002): <200

DESIGN SPEED: 30 MPH

TOWNSHIP ROAD 225
SALINE COUNTY - HARRISBURG TOWNSHIP
SECTION NO. 04-06116-00-BR
ACBROS-165(24)
C-99-538-04

SCALES

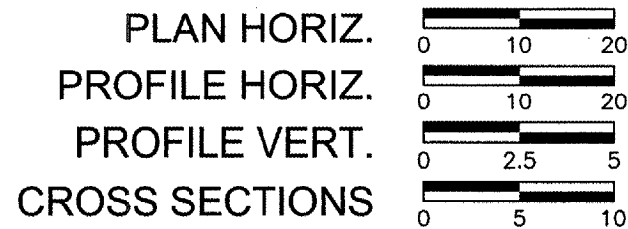

SUMMARY OF QUANTITIES

20200100	EARTH EXCAVATION	CU YD	4,500
20400100	BORROW EXCAVATION	CU YD	8,750
25001000	SEEDING, CLASS 2 (SPECIAL)	ACRE	1.5
28000250	TEMPORARY EROSION CONTROL SEEDING	POUND	150
28000300	TEMPORARY DITCH CHECKS	EACH	6
28000400	PERIMETER EROSION BARRIER	FOOT	370
28100807	STONE DUMPED RIPRAP, CLASS A4	TON	935
40200800	AGGREGATE SURFACE COURSE, TYPE B	TON	1,740
50100100	REMOVAL OF EXISTING STRUCTURES	EACH	1
50300225	CONCRETE STRUCTURES	CU YD	32.4
50400505	PRECAST PRESTRESSED CONCRETE DECK BEAMS, (27" DEPTH)	SQ FT	4,320
50800105	REINFORCEMENT BARS	POUND	3,240
50900205	STEEL RAILING, TYPE S1	FOOT	360
51201610	FURNISHING STEEL PILES HP 12X63	FOOT	1,780
51202700	DRIVING STEEL PILES	FOOT	1,780
51204315	CONCRETE ENCASEMENT	CU YD	44.6
51500100	NAME PLATES	EACH	1
63000000	STEEL PLATE BEAM GUARD RAIL, TYPE A	FOOT	1137.5
63100041	TRAFFIC BARRIER TERMINAL, TYPE 1B	EACH	4
67100100	MOBILIZATION	L SUM	1
X2010505	CLEARING, SPECIAL	L SUM	1

X081-2A

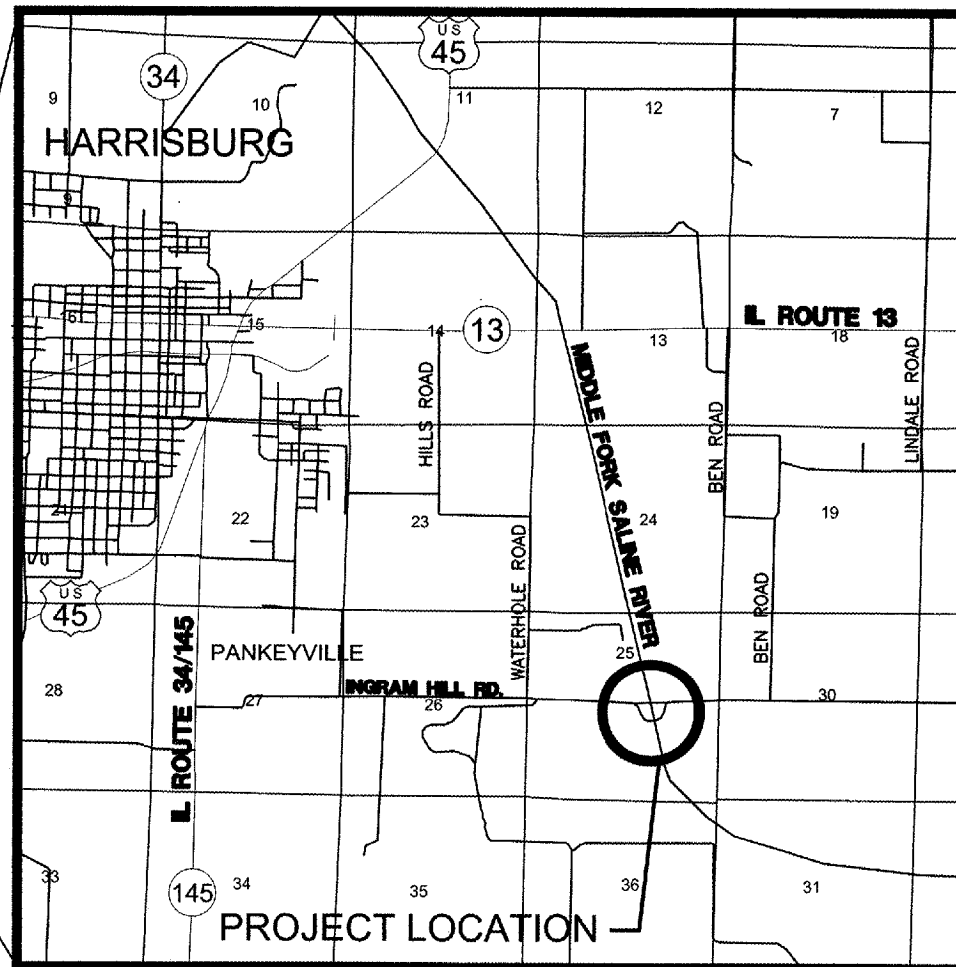
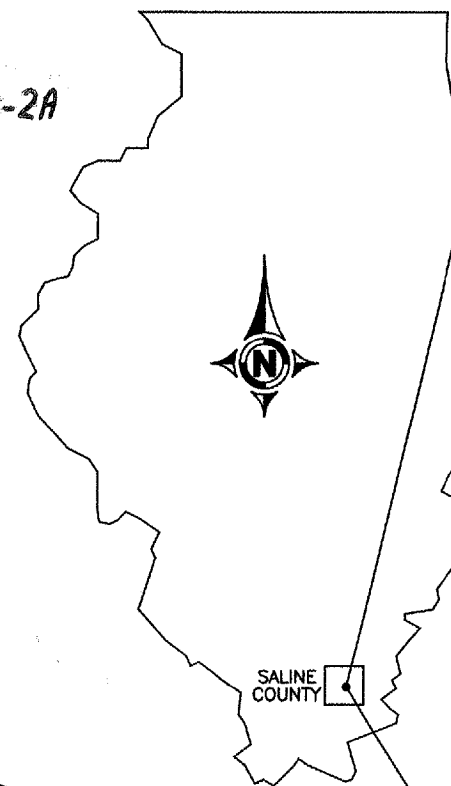

INDEX TO SHEETS

- 1 COVER
- 2 GENERAL LAYOUT SHEET
- 3-5 PLAN & PROFILE
- 6 GENERAL PLAN & ELEVATION
- 7 SUPERSTRUCTURE
- 8 DECK BEAM DETAILS
- 9 ABUTMENT DETAILS
- 10 PIER DETAILS
- 11 STEEL RAILING
- 12 NAME PLATE
- 13 PILE DETAILS
- 14-21 CROSS SECTIONS
- 22-23 EROSION CONTROL PLAN
- 24-25 BORING LOGS

STANDARDS

- 280001-02 631006-03
- 630001-05 702001-05
- 630301-03 BLR 21-6

STATE OF ILLINOIS
DEPARTMENT OF TRANSPORTATION

APPROVED 09-30 2005

[Signature]
AGENCY REPRESENTATIVE

PASSED Oct. 3 2005

[Signature]
ENGINEER OF LOCAL ROADS AND STREETS

APPROVED 10-3 2005

[Signature]
MARY C. LAMIE, P.E.
DEPUTY DIRECTOR OF HIGHWAYS
REGION FIVE ENGINEER

LOCATION MAP
Scale: 1 inch = 1 mile
Length Of Improvements = 1,400 ft (0.27 mi)



[Signature]
JIM W. BROWN, PRESIDENT
ILLINOIS REGISTERED PROFESSIONAL ENGINEERING CORPORATION
NUMBER 184-002518
EXPIRES NOV. 30, 2005



BROWN & ROBERTS, INC.
CONSULTING ENGINEERS LAND SURVEYORS

ONE WEST RIDGE ROAD HARRISBURG, IL 62946 (618) 282-8111

Contract No. 99238

BRRJ Job No. 04043