

F.A.P. RTE.	SECTION	COUNTY	TOTAL SHEETS	SHEET NO.
840	143N	WILL	121	21
STA.	TO STA.			
FED. ROAD DIST. NO.	ILLINOIS FED. AID PROJECT			
CONTRACT NO. - 60445				

PAVEMENT MARKINGS

- ① TEMPORARY PAVEMENT MARKINGS, YELLOW DOUBLE LINE (100 mm) CENTERLINE WITH TEMP. YELLOW RAISED REFLECTIVE PAVEMENT MARKERS
- ② TEMPORARY PAVEMENT MARKINGS, WHITE SKIP DASH (100 mm) LANE LINE
- ③ TEMPORARY PAVEMENT MARKINGS, SOLID WHITE LINE (150 mm) LANE LINE
- ④ TEMPORARY PAVEMENT MARKINGS, LETTERS AND SYMBOLS
- ⑤ TEMPORARY PAVEMENT MARKINGS, SOLID WHITE LINE (600 mm) STOP BAR

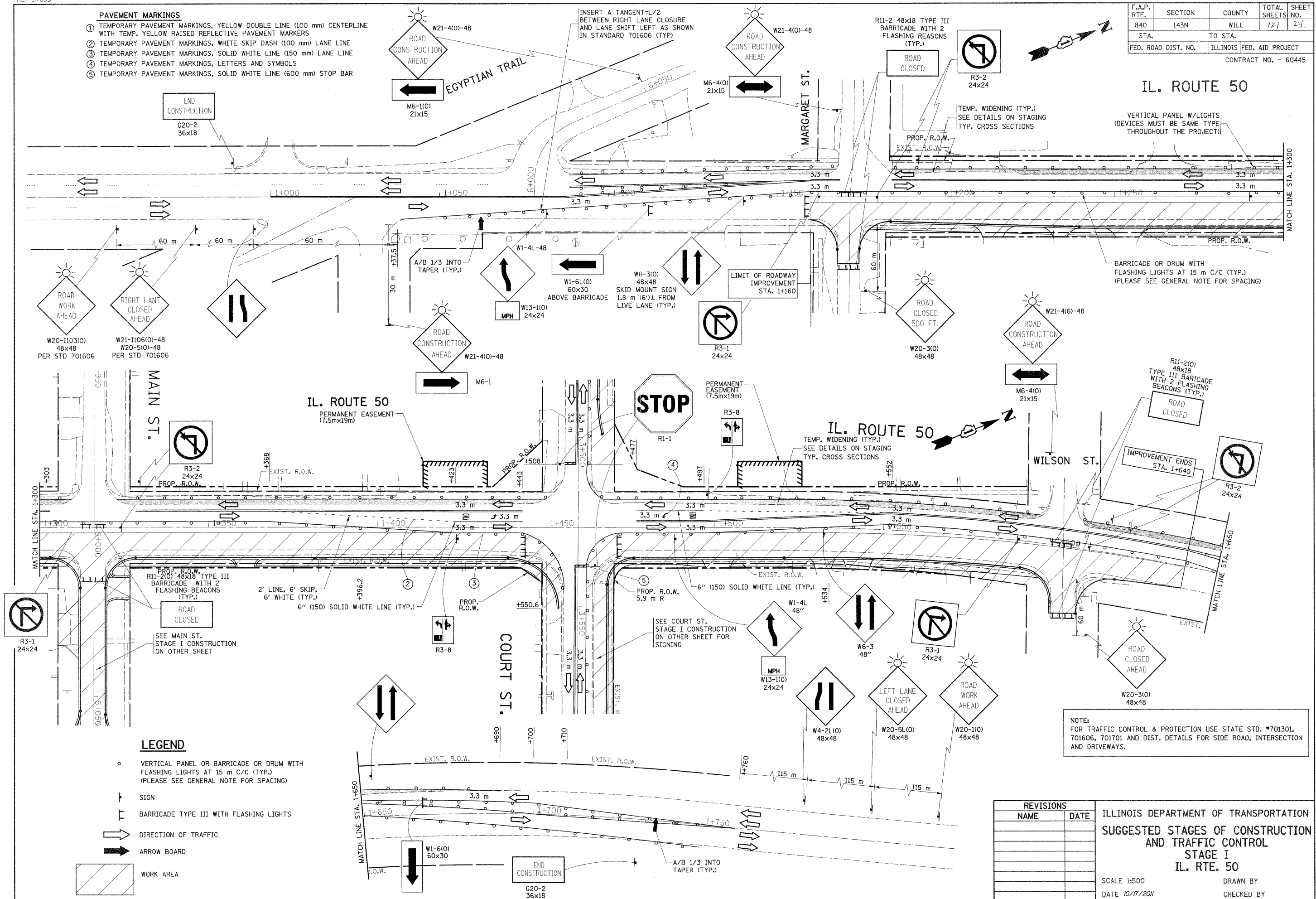

LEGEND

- VERTICAL PANEL OR BARRICADE OR DRUM WITH FLASHING LIGHTS AT 15 m C/C (TYP.) (PLEASE SEE GENERAL NOTE FOR SPACING)
- ⊥ SIGN
- ⊥ BARRICADE TYPE III WITH FLASHING LIGHTS
- DIRECTION OF TRAFFIC
- ARROW BOARD
- ▨ WORK AREA

NOTE:
 FOR TRAFFIC CONTROL & PROTECTION USE STATE STD. #701301, 701606, 701701 AND DIST. DETAILS FOR SIDE ROAD, INTERSECTION AND DRIVEWAYS.

REVISIONS	
NAME	DATE

ILLINOIS DEPARTMENT OF TRANSPORTATION
 SUGGESTED STAGES OF CONSTRUCTION
 AND TRAFFIC CONTROL
 STAGE I
 IL. RTE. 50
 SCALE 1:500
 DATE 10/17/2011
 DRAWN BY
 CHECKED BY