

F.A.P. RTE.	SECTION	COUNTY	TOTAL SHEETS	SHEET NO.
840	143N	WILL	129	30
STA. 840 TO STA. 143N		ILLINOIS FED. AID PROJECT		
FED. ROAD DIST. NO.		CONTRACT NO. - 60445		

NOTE:
 FOR TRAFFIC CONTROL & PROTECTION USE STATE STD. #701301, 701606, 701701 AND DIST. DETAILS FOR SIDE ROAD, INTERSECTION AND DRIVEWAYS.

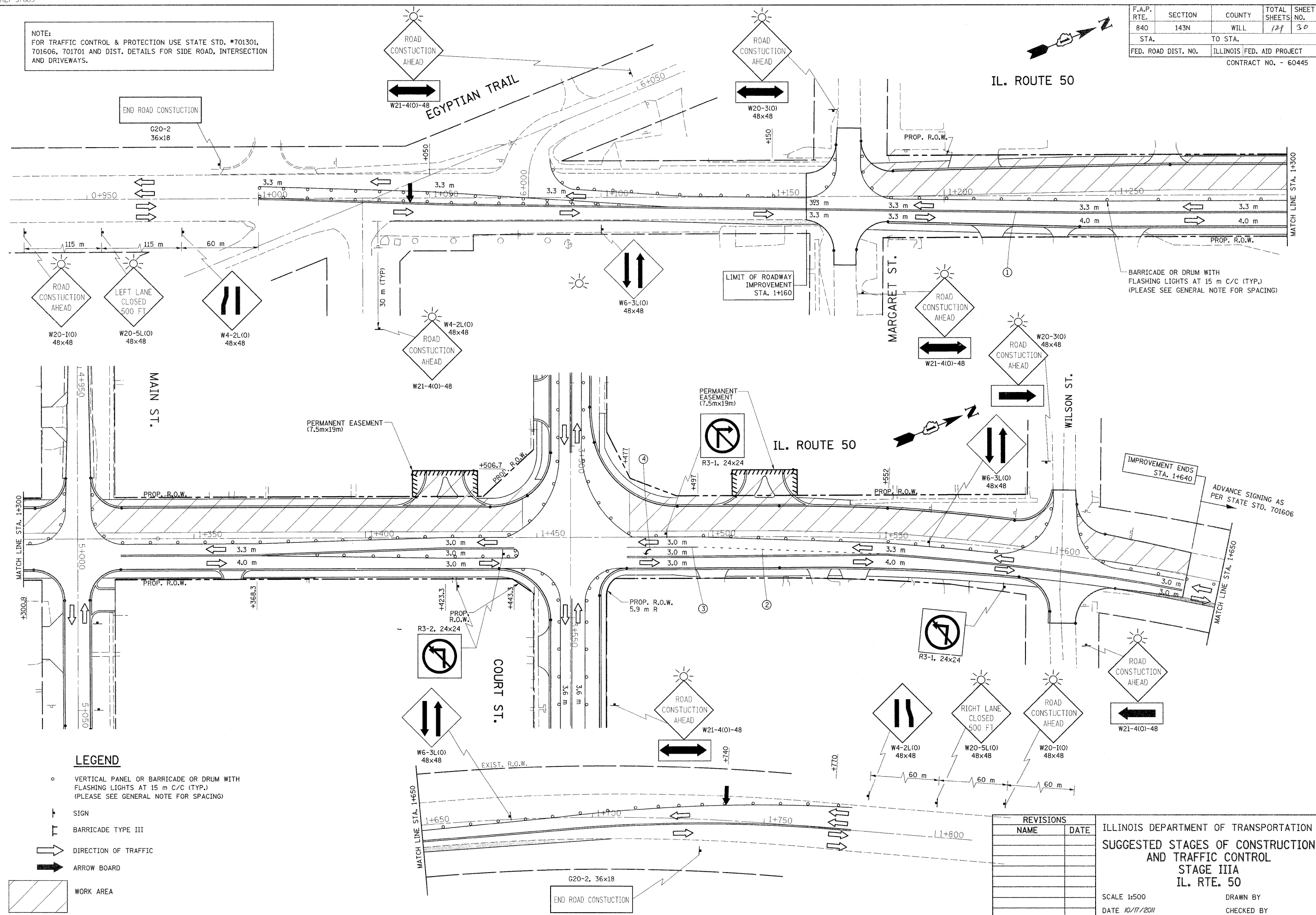

LEGEND

- VERTICAL PANEL OR BARRICADE OR DRUM WITH FLASHING LIGHTS AT 15 m C/C (TYP.) (PLEASE SEE GENERAL NOTE FOR SPACING)
- ⊥ SIGN
- ⊥ BARRICADE TYPE III
- DIRECTION OF TRAFFIC
- ARROW BOARD
- ▨ WORK AREA

REVISIONS	
NAME	DATE

ILLINOIS DEPARTMENT OF TRANSPORTATION
 SUGGESTED STAGES OF CONSTRUCTION
 AND TRAFFIC CONTROL
 STAGE IIIA
 IL. RTE. 50

SCALE 1:500
 DATE 10/17/2011
 DRAWN BY
 CHECKED BY