

F.A.P. RTE.	SECTION	COUNTY	TOTAL SHEETS	SHEET NO.
840	143N	WILL	121	36
STA. 4+900 TO STA. 5+150				
FED. ROAD DIST. NO.		ILLINOIS FED. AID PROJECT		

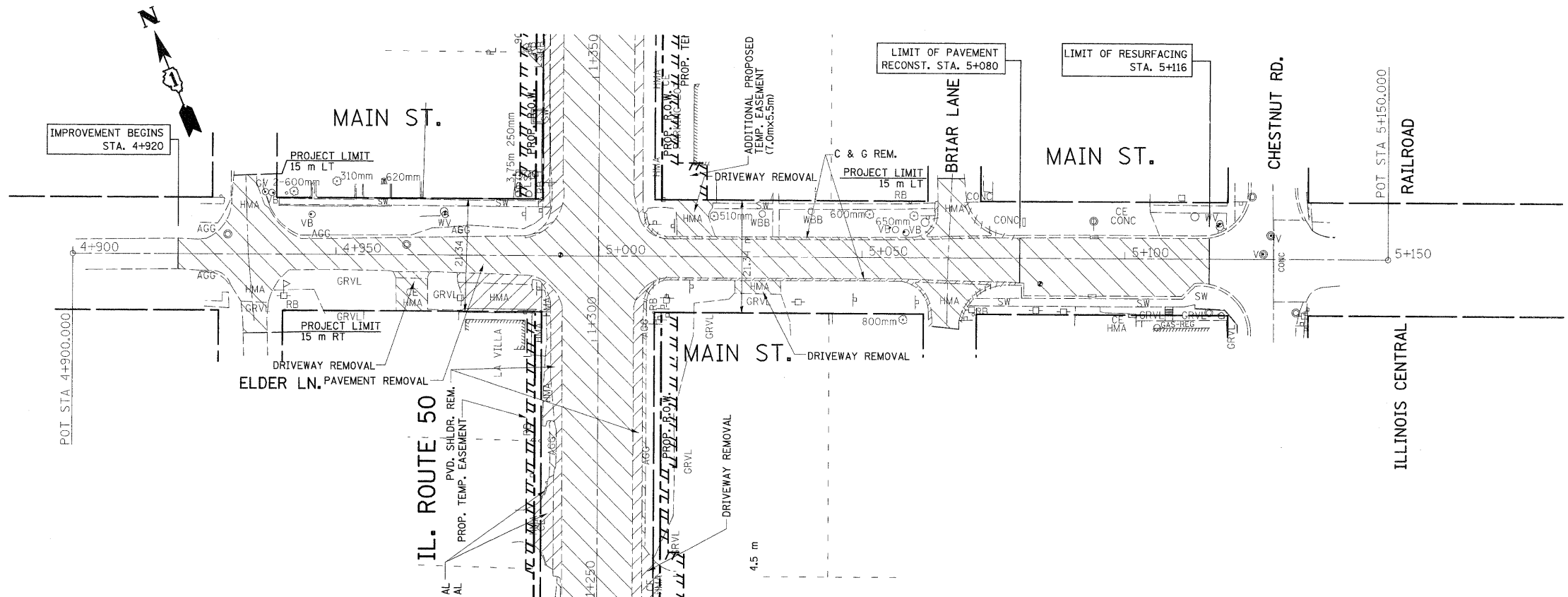

EXISTING

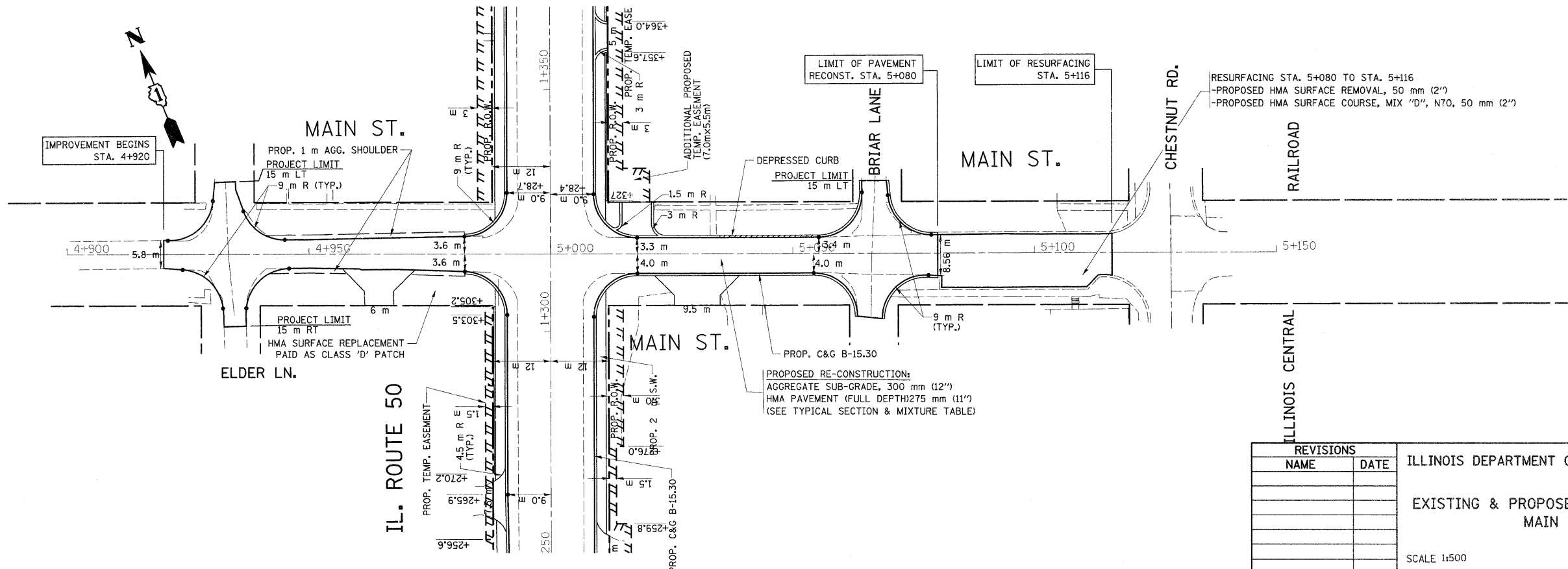

PROPOSED

REVISIONS	
NAME	DATE

ILLINOIS DEPARTMENT OF TRANSPORTATION
 EXISTING & PROPOSED ROADWAY PLAN
 MAIN ST.
 SCALE 1:500
 DATE 10/18/2011
 DRAWN BY
 CHECKED BY