

F.A.P. RTE.	SECTION	COUNTY	TOTAL SHEETS	SHEET NO.
840	143N	WILL	121	55
STA.		TO STA.		
FED. ROAD DIST. NO.		ILLINOIS FED. AID PROJECT		

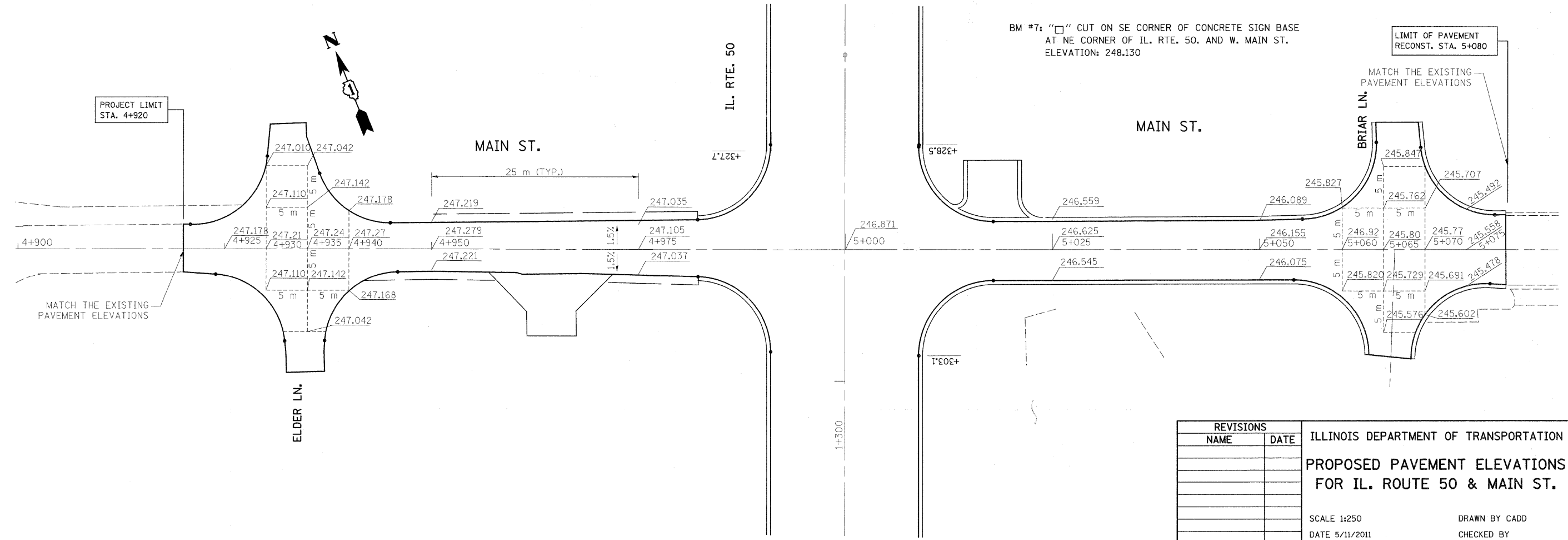
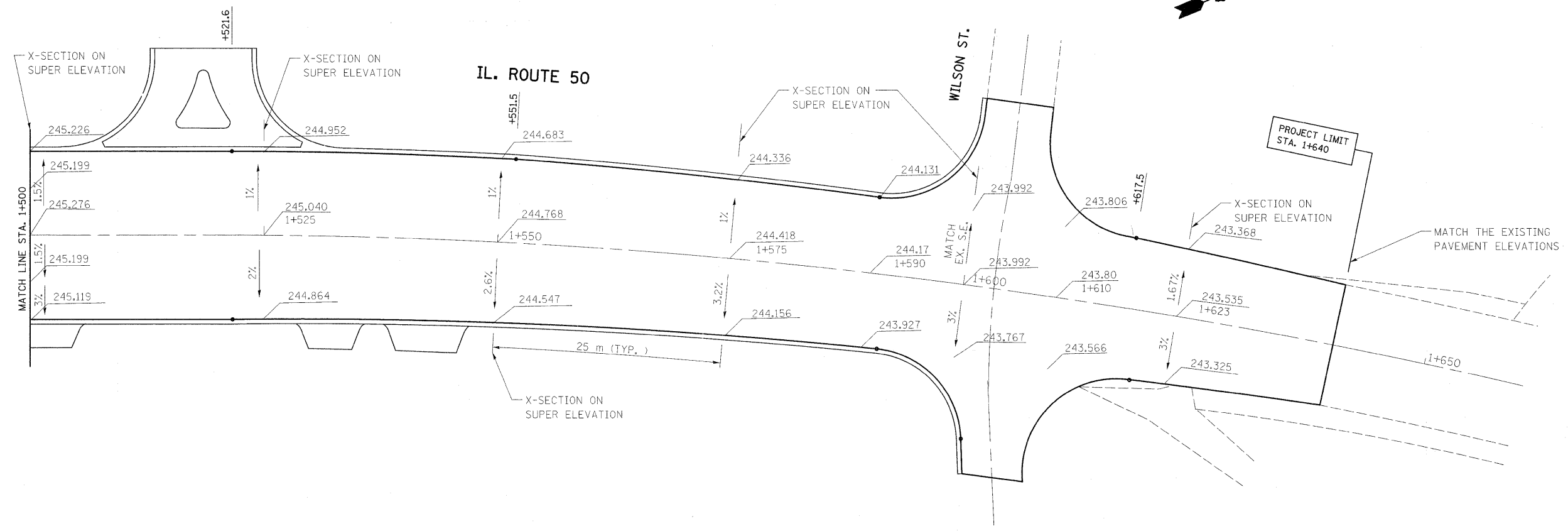
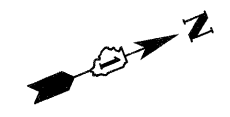

REVISIONS	
NAME	DATE

ILLINOIS DEPARTMENT OF TRANSPORTATION
PROPOSED PAVEMENT ELEVATIONS FOR IL. ROUTE 50 & MAIN ST.
 SCALE 1:250
 DATE 5/11/2011
 DRAWN BY CADD
 CHECKED BY