

DATE	
BY	
PLAN	
SURVEYED	
NOTED	
CHECKED	
NO.	

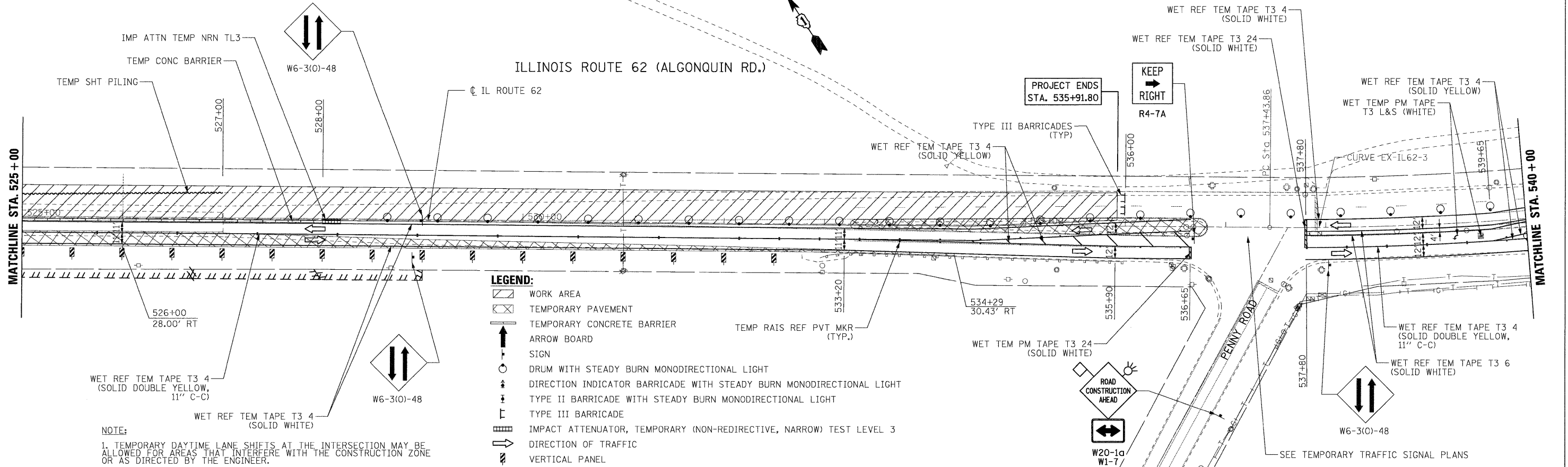

DATE	
BY	
PLAN	
SURVEYED	
NOTED	
CHECKED	
NO.	

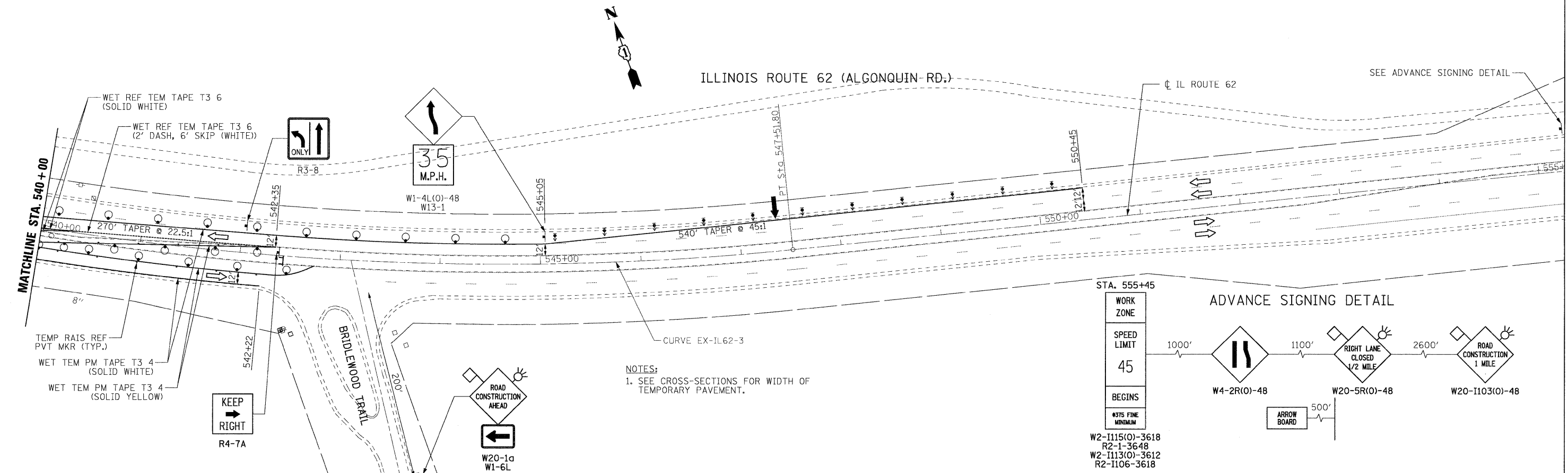

FILE NAME =
...N160135-shr-staging1_03.dgn



DESIGNED ADW
DRAWN ADW
CHECKED RJD
DATE JUNE 30, 2011

REVISED -
REVISED -
REVISED -
REVISED -

STATE OF ILLINOIS
DEPARTMENT OF TRANSPORTATION

IL RTE 62 (ALGONQUIN RD.) FROM EASTING'S WAY TO PENNY RD.
SUGGESTED STAGE OF CONSTRUCTION & TRAFFIC CONTROL - STAGE 1

SCALE: 1"=50' SHEET NO. 3 OF 6 SHEETS STA. 525+00 TO STA. 550+45

F.A.P. RTE.	SECTION	COUNTY	TOTAL SHEETS	SHEET NO.
339	116 Y-1-R-1	COOK	122	21
				CONTRACT NO. 60135
ILLINOIS FED. AID PROJECT				