

PLAN	SURVEYED	DATE
	FLOWN	
	ALIGNED	
	CHECKED	
	RT. OF WAY CHECKED	
	NOTE BOOK	
	NO.	
	CADD FILE NAME	

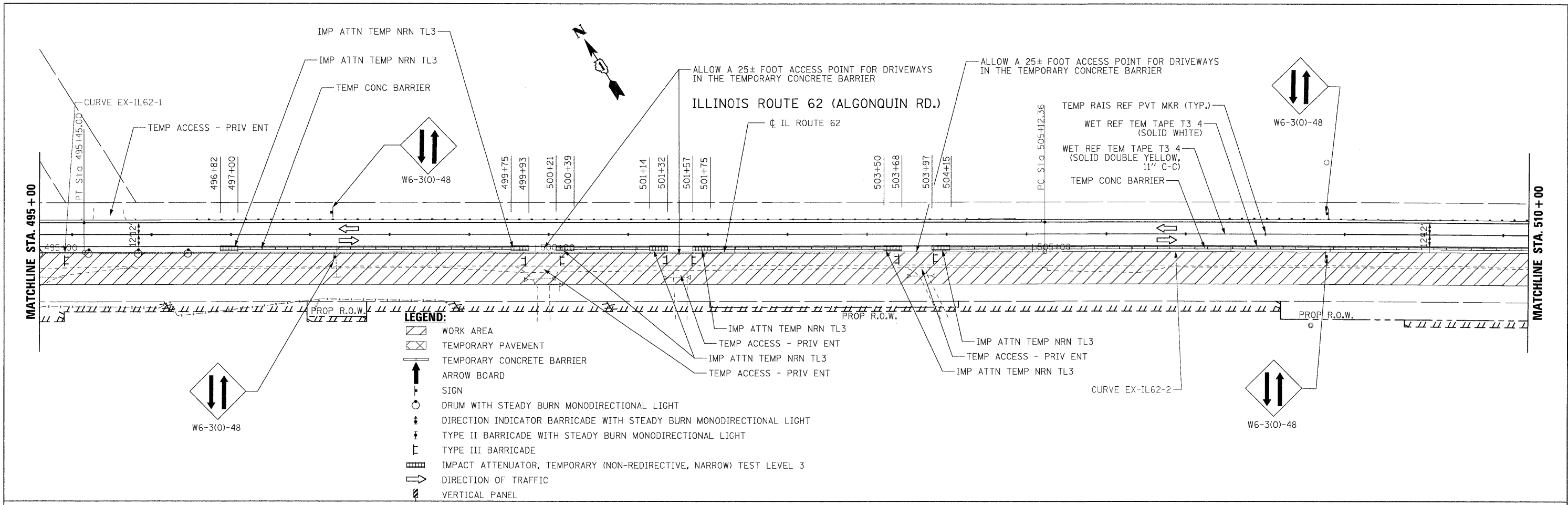

- LEGEND:**
- WORK AREA
 - TEMPORARY PAVEMENT
 - TEMPORARY CONCRETE BARRIER
 - ARROW BOARD
 - SIGN
 - DRUM WITH STEADY BURN MONODIRECTIONAL LIGHT
 - DIRECTION INDICATOR BARRICADE WITH STEADY BURN MONODIRECTIONAL LIGHT
 - TYPE II BARRICADE WITH STEADY BURN MONODIRECTIONAL LIGHT
 - TYPE III BARRICADE
 - IMPACT ATTENUATOR, TEMPORARY (NON-REDIRECTIVE, NARROW) TEST LEVEL 3
 - DIRECTION OF TRAFFIC
 - VERTICAL PANEL

PLAN	SURVEYED	DATE
	FLOWN	
	ALIGNED	
	CHECKED	
	RT. OF WAY CHECKED	
	NOTE BOOK	
	NO.	
	CADD FILE NAME	

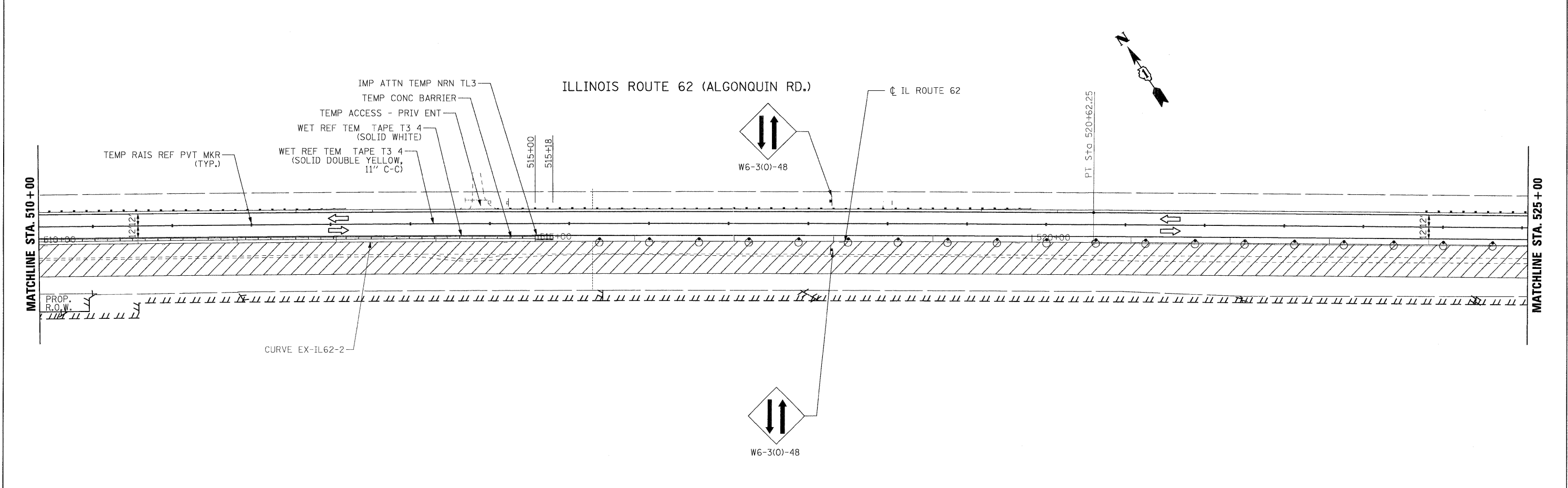

FILE NAME =
 ...\\D160135-sht-staging2.02.dgn

	DESIGNED	ADW	REVISED	-
	DRAWN	ADW	REVISED	-
	CHECKED	RJD	REVISED	-
	DATE	JUNE 30, 2011	REVISED	-

**STATE OF ILLINOIS
 DEPARTMENT OF TRANSPORTATION**

**IL RTE 62 (ALGONQUIN RD.) FROM EASTING'S WAY TO PENNY RD.
 SUGGESTED STAGE OF CONSTRUCTION & TRAFFIC CONTROL - STAGE 2**

SCALE: 1"=50' SHEET NO. 5 OF 6 SHEETS STA. 495+00 TO STA. 525+00

F.A.P. RTE.	SECTION	COUNTY	TOTAL SHEETS	SHEET NO.
339	116 Y-1-R-1	COOK	122	23
CONTRACT NO. 60135				
[ILLINOIS] FED. AID PROJECT				