

FINAL SURVEY	BY	DATE
NOTE BOOK		
NO.		

ORIGINAL SURVEY	BY	DATE
NOTE BOOK		
NO.		

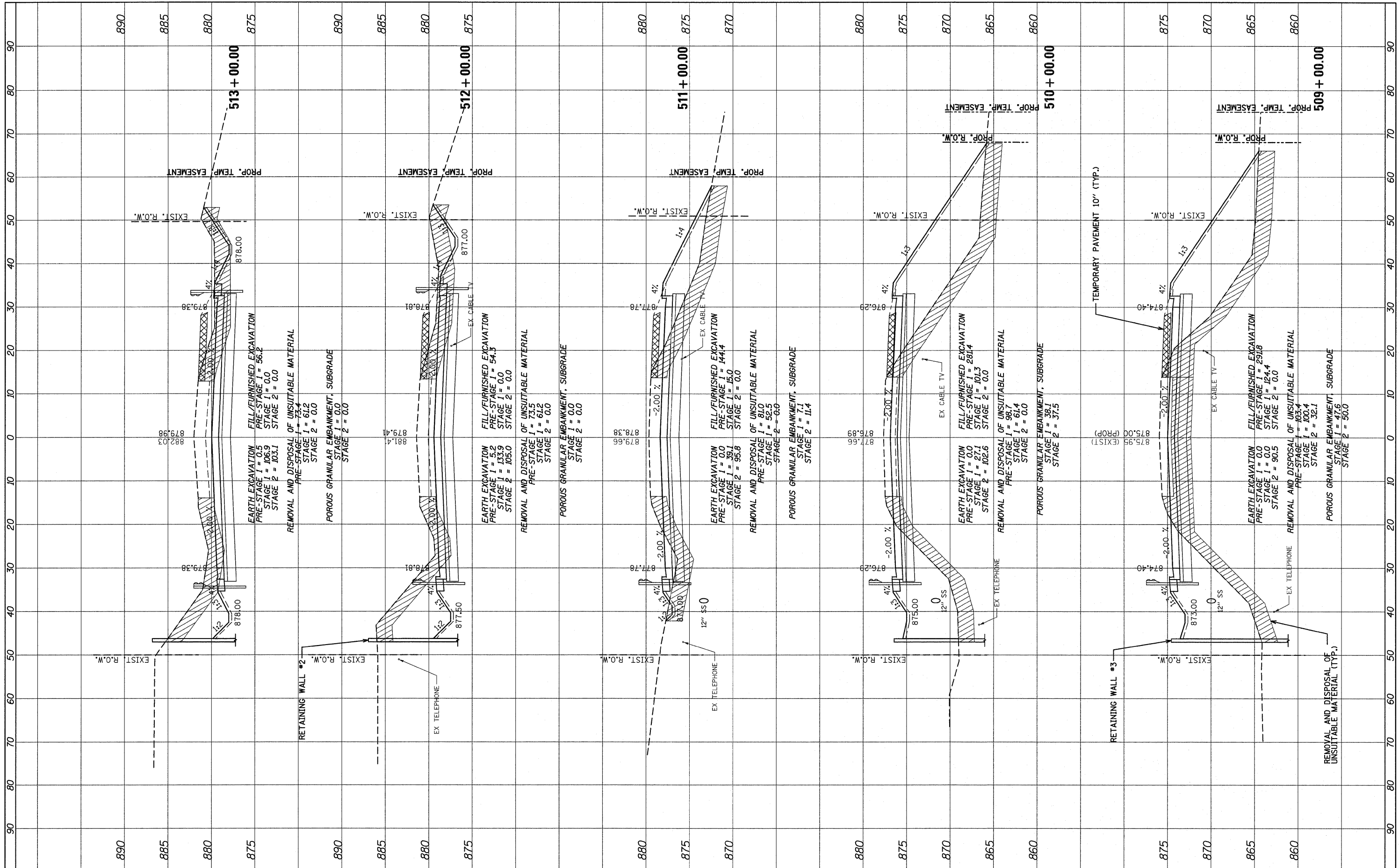

FILE NAME =
 #FND035-ah-t-xseht.dgn

USER NAME = #USER#
 PLOT SCALE = #SCALE#
 PLOT DATE = #DATE#

DESIGNED - ADW
 DRAWN - ADW
 CHECKED - RJD
 DATE - JUNE 30, 2011

REVISED - 10/21/2011 N.W.S.
 REVISED -
 REVISED -
 REVISED -

**STATE OF ILLINOIS
 DEPARTMENT OF TRANSPORTATION**

**IL RTE 62 (ALGONQUIN RD.) FROM EASTING'S WAY TO PENNY RD.
 CROSS SECTIONS**

SCALE: H=10'(H); V=5'(V) SHEET NO. 8 OF 13 SHEETS STA. 509+00.00 TO STA. 513+00.00

F.A.P. RTE. 339	SECTION 116 Y-1-R-1	COUNTY COOK	TOTAL SHEETS 122	SHEET NO. 106
CONTRACT NO. 60I35			ILLINOIS FED. AID PROJECT	