

FINAL SURVEY	BY	DATE
NOTE BOOK		
NO.		
SURVEYED		
TEMP.		
AREAS		
CHECKED		

ORIGINAL SURVEY	BY	DATE
NOTE BOOK		
NO.		
SURVEYED		
TEMP.		
AREAS		
CHECKED		

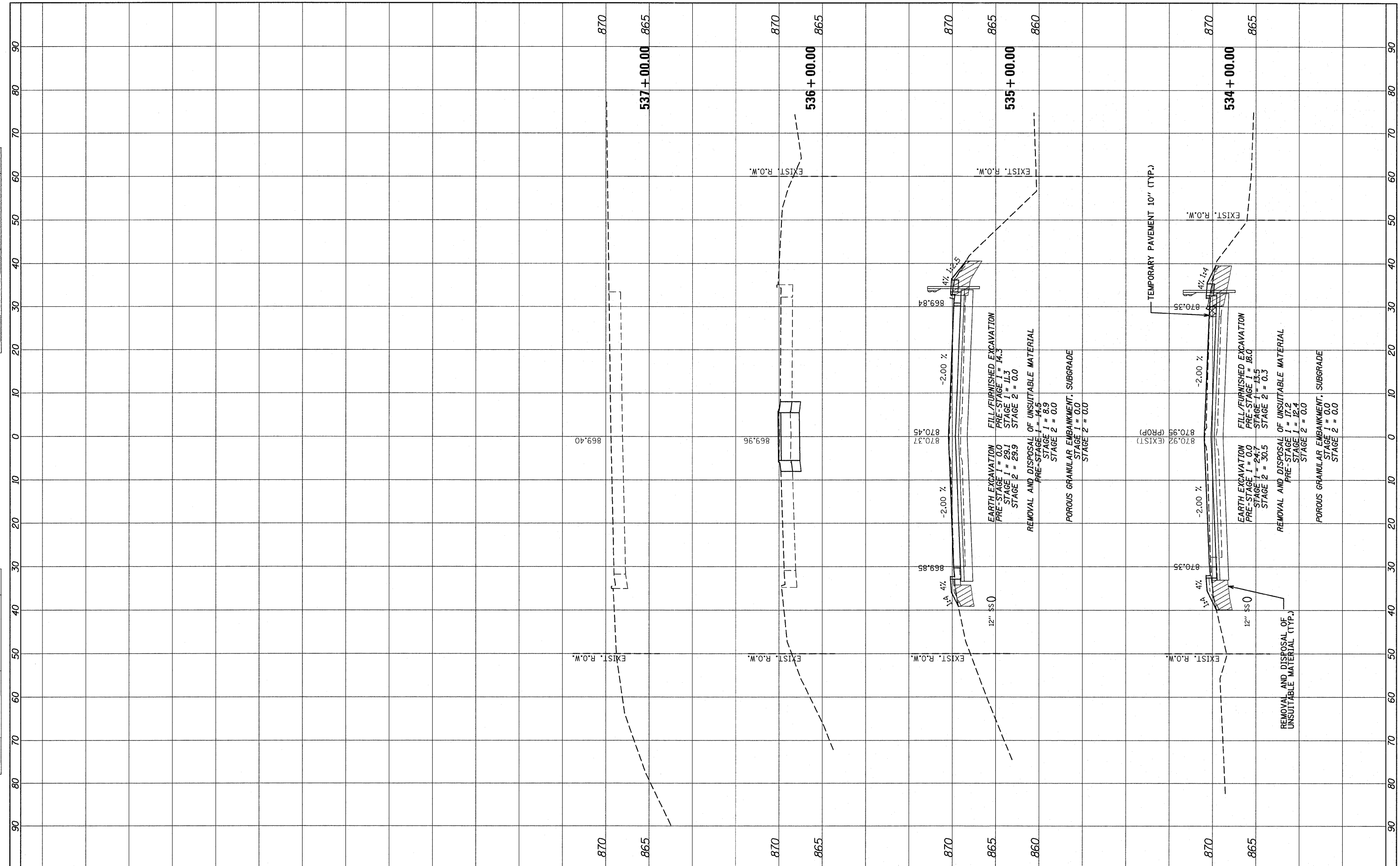

FILE NAME =  
 #P:\03\35-shr-xshd.dgn

USER NAME = #USER#	DESIGNED - ADW	REVISED - 10/21/2011 N.W.S.
PLOT SCALE = #SCALE#	DRAWN - ADW	REVISED -
PLOT DATE = #DATE#	CHECKED - RJD	REVISED -
	DATE - JUNE 30, 2011	REVISED -

**STATE OF ILLINOIS  
 DEPARTMENT OF TRANSPORTATION**

**IL RTE 62 (ALGONQUIN RD.) FROM EASTING'S WAY TO PENNY RD.  
 CROSS SECTIONS**

SCALE: H=10'(V)=5'(V) SHEET NO. 13 OF 13 SHEETS STA. 534+00.00 TO STA. 537+00.00

F.A.P. RTE.	SECTION	COUNTY	TOTAL SHEETS	SHEET NO.
339	116 Y-1-R-1	COOK	122	111
				CONTRACT NO. 60135
ILLINOIS FED. AID PROJECT				