

**LEGEND**

PAVEMENT WIDENING

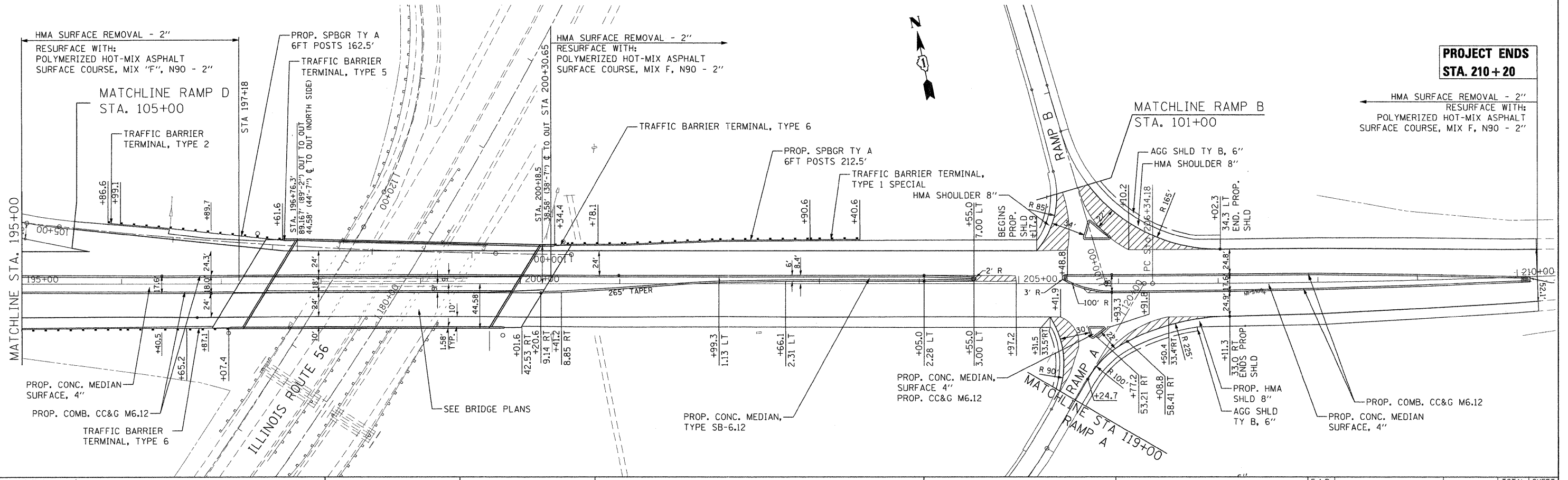

FILE NAME = P:\2010\MEI0012\_PTB156-16\_Galena\CADD\Shs\1060K76-Shs-plan01.dgn  
 USER NAME = Millennium Professional Services

200 22ND Street, Suite 216, Lombard, IL 60148  
 630.795.0110 voice, 630.839.2566 fax  
 www.mps-il.com  
**MILLENNIA PROFESSIONAL SERVICES**

DESIGNED - CJD	REVISED -
DRAWN - CJD	REVISED -
CHECKED - TVN	REVISED -
DATE - 9/22/2011	REVISED -

**STATE OF ILLINOIS**  
**DEPARTMENT OF TRANSPORTATION**

<b>GALENA BOULEVARD</b>	<b>MAINLINE PROPOSED PLAN</b>
SCALE: 1"=50'	SHEET NO. 1 OF 1 SHEETS
STA. 189+00	TO STA. 209+00

F.A.P. RTE. 573	SECTION 61HB-1-R	COUNTY KANE	TOTAL SHEETS 110	SHEET NO. 13
CONTRACT NO. 60K76				
FED. ROAD DIST. NO. 1   ILLINOIS FED. AID PROJECT				

P:\2010\MEI0012\_PTB156-16\_Galena\CADD\Shs\1060K76-Shs-plan01.dgn