

IL ROUTE 31

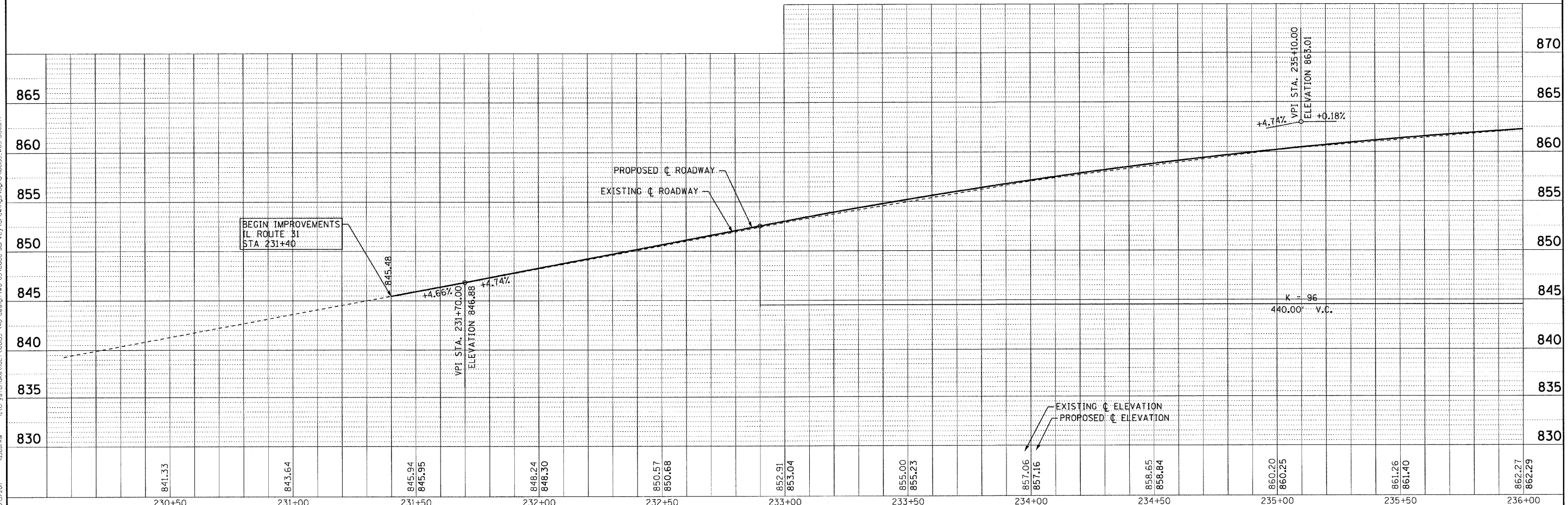

COPYRIGHT © 2010 BY BAXTER & WOODMAN, INC. PROJECT NO. 100153.W05.D1
 LICENSE NO. 184-00381 - EXPIRES 4/30/2011
 DATE PLOTTED: 7/5/2011 11:35:51 AM
 FILE: I:\projects\100153.W05.D1\design\wp-05\road-survey\coverings\drgs\100153.W05-D1.dwg



DESIGNED - DJS	REVISED - 1-28-11 PER IDOT REVIEW
DRAWN - CJC	REVISED -
CHECKED - LDH	REVISED -
DATE - 09/10/10	FILE - 100153.W05-D1.dwg

**STATE OF ILLINOIS
DEPARTMENT OF TRANSPORTATION**

**IL ROUTE 31 - AMES ROAD TO EDGEWOOD ROAD
DRAINAGE AND UTILITIES**

SCALE: H: 1"=20' V: 1"=5'

STA. 230+00 TO STA. 236+00

F.A.P. RTE.	SECTION	COUNTY	TOTAL SHEETS	SHEET NO.
336	2010-049-N	MCHENRY	50	21
FED. ROAD DIST. NO. 1 ILLINOIS			CONTRACT NO. 60L25	