

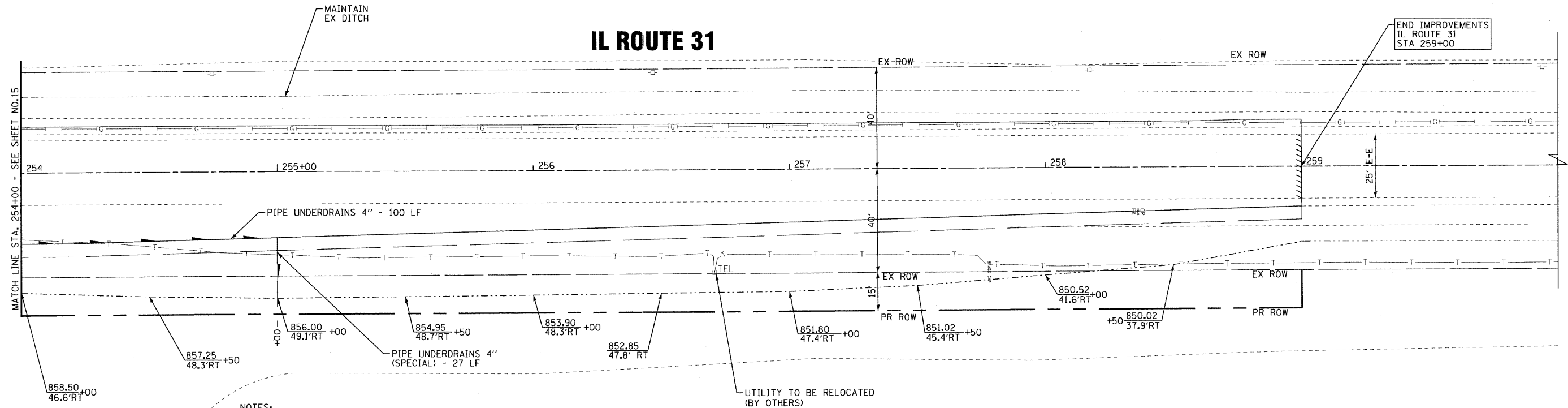

# IL ROUTE 31



**NOTES:**

INSTALL 4" PIPE UNDERDRAINS BENEATH OUTER EDGE OF PAVEMENT AT A DEPTH OF 30" BELOW THE TOP OF THE HMA PAVEMENT AT THE OUTER EDGE. USE PIPE UNDERDRAINS (SPECIAL) AS AN OUTLET TO CONNECT PIPE UNDERDRAINS TO CONCRETE HEADWALL AT STA 255+00 OR AS DETERMINED BY THE ENGINEER.

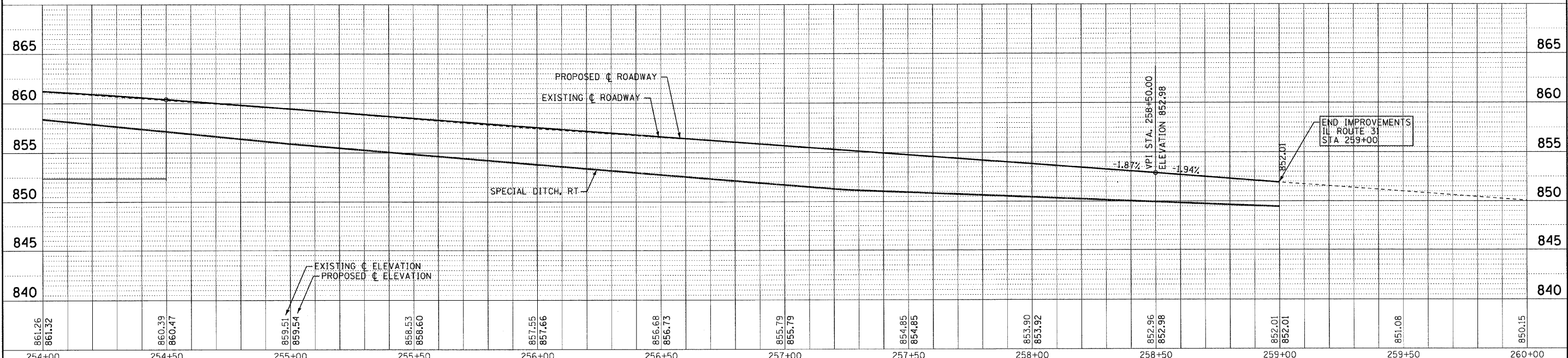

COPYRIGHT © 2002 BY BAXTER & WOODMAN, INC.  
 ALL RIGHTS RESERVED. NO PART OF THIS PUBLICATION MAY BE REPRODUCED OR TRANSMITTED IN ANY FORM OR BY ANY MEANS, ELECTRONIC OR MECHANICAL, WITHOUT PERMISSION IN WRITING FROM BAXTER & WOODMAN, INC.  
 LICENSE NO. 384 00021 EXPIRES 4/30/2011  
 7/5/2011 10:36:20 AM



DESIGNED - DJS	REVISED -1-28-11 PER IDOT REVIEW
DRAWN - CJC	REVISED -
CHECKED - LDH	REVISED -
DATE - 09/10/10	FILE - 100153_W05-DU5.shp

**STATE OF ILLINOIS  
DEPARTMENT OF TRANSPORTATION**

**IL ROUTE 31 - AMES ROAD TO EDGEWOOD ROAD  
DRAINAGE AND UTILITIES**

SCALE: H: 1"=20' V: 1"=5'

STA. 254+00 TO STA. 260+00

F.A.P. RTE. 336	SECTION 2010-049-N	COUNTY MCHENRY	TOTAL SHEETS 50	SHEET NO. 25
FED. ROAD DIST. NO. 1 ILLINOIS			CONTRACT NO. 60L25	