

PLAN	SURVEYED	DATE
	PLOTTED	BY
	GRADES CHECKED	
	STRUCTURE NOTATIONS CHECKED	
	NO.	

PROFILE	SURVEYED	DATE
	PLOTTED	BY
	GRADES CHECKED	
	STRUCTURE NOTATIONS CHECKED	
	NO.	

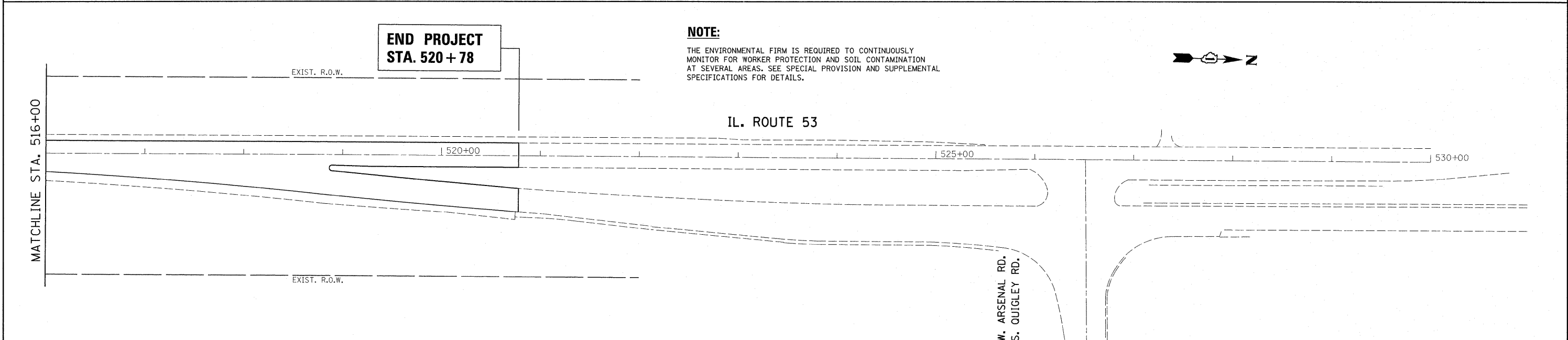
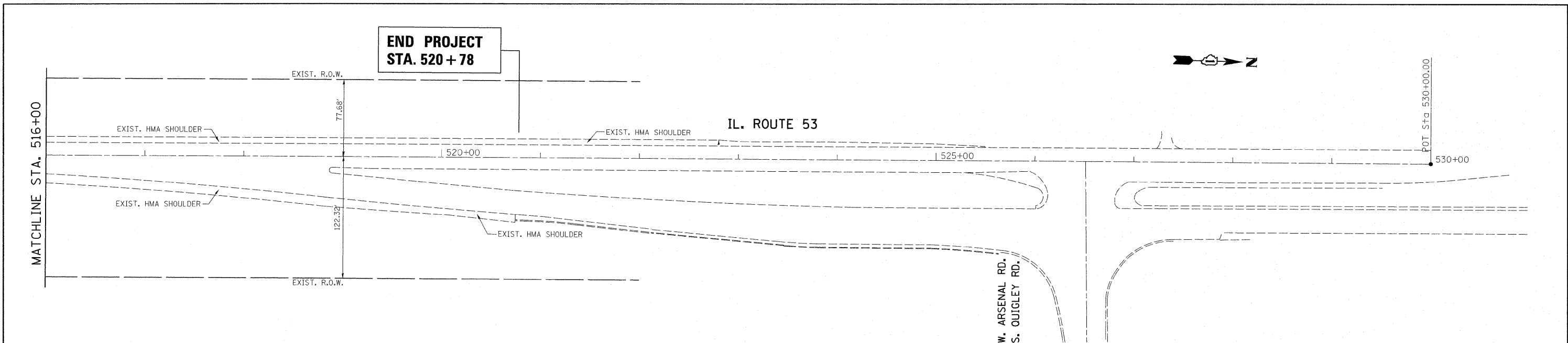

NOTE:
THE ENVIRONMENTAL FIRM IS REQUIRED TO CONTINUOUSLY MONITOR FOR WORKER PROTECTION AND SOIL CONTAMINATION AT SEVERAL AREAS. SEE SPECIAL PROVISION AND SUPPLEMENTAL SPECIFICATIONS FOR DETAILS.

RESURFACING AREA NO PROFILE INFORMATION

FILE NAME = P142009-shd-drain.dgn	USER NAME = becker.tom	DESIGNED - DRAWN -	REVISED - REVISED -	STATE OF ILLINOIS DEPARTMENT OF TRANSPORTATION	EXISTING & PROPOSED DRAINAGE AND UTILITY PLAN IL. ROUTE 53 AT RIVER ROAD	F.A.P. RTE. 846	SECTION 4-N-3	COUNTY WILL	TOTAL SHEETS 68	SHEET NO. 23
PLOT SCALE = 50.0000' / in.	PLOT DATE = 8/23/2011	CHECKED - DATE -	REVISED - REVISED -			HOR. SCALE: 1"=5' VER. SCALE: 1"=50'	SHEET NO. OF SHEETS	STA. 502+00.00 TO STA. 515+00.00	CONTRACT NO. 60L42 ILLINOIS FED. AID PROJECT	