

PAVEMENT MARKING LEGEND:

(A) PROP. THERMO. PVT. MARKING (YELLOW) - 4" SOLID CENTERLINE (2 LINES @ 11" C-C) - (TYP)	(G) PROP. THERMO. PVT. MARKING (WHITE) - 6" SOLID CROSSWALK.
(B) PROP. THERMO. PVT. MARKING (YELLOW) - 4" SKIP DASH CENTERLINE (10' LINE / 30' SKIP)-(TYP.)	(H) PROP. THERMO. PVT. MARKING (WHITE) - 8" GORE MARKING (45° @ 30' C-C) - (TYP)
(B1) PROP. THERMO. PVT. MARKING (YELLOW) - 4" SOLID NO PASSING ZONE LINE (5 1/2" C-C FROM SKIP DASH) - (TYP.)	(I) PROP. THERMO. PVT. MARKING (WHITE) - 12" SHOULDER DIAGONALS (45° @ 75' C-C) - (TYP)
(C) PROP. THERMO. PVT. MARKING (YELLOW) - 4" SOLID EDGELINE - (TYP)	(J) PROP. THERMO. PVT. MARKING (YELLOW) - 12" MEDIAN DIAGONALS (45° @ 75' C-C) - (TYP)
(D) PROP. THERMO. PVT. MARKING (WHITE) - 4" SOLID EDGELINE - (TYP)	(K) PROP. THERMO. PVT. MARKING (WHITE) - 24" STOP BAR - (TYP)
(E) PROP. THERMO. PVT. MARKING (WHITE) - 6" SOLID TURN LANE LINE - (TYP)	(L) PROP. THERMO. PVT. MARKING (WHITE) LETTERS AND SYMBOLS - (TYP)
(F) PROP. THERMO. PVT. MARKING (WHITE) - 6" SKIP-DASH LANE LINE 2' LINE / 6' SKIP	

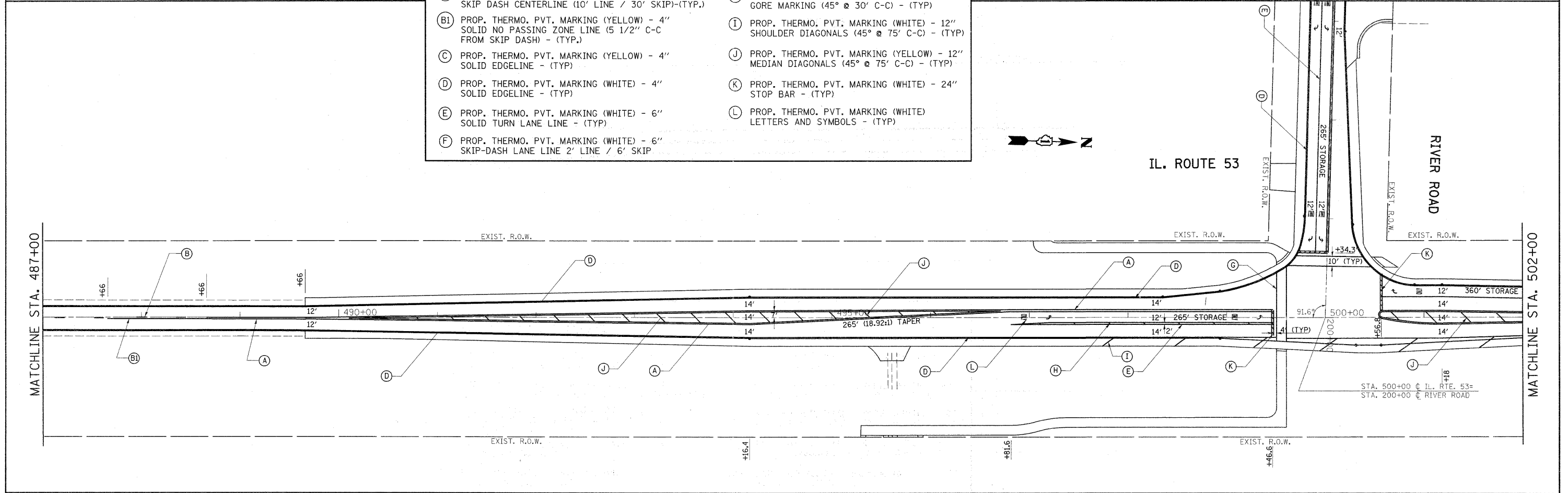

FILE NAME = P142009-shr-pmk.dgn 9-26-2011	USER NAME = lizakr-f DESIGNED - DRAWN - CHECKED - DATE -	REVISIONS REVISED - REVISED - REVISED - REVISED -	STATE OF ILLINOIS DEPARTMENT OF TRANSPORTATION	PAVEMENT MARKING PLAN IL. ROUTE 53 AT RIVER ROAD SCALE: 1"= 50' SHEET NO. OF SHEETS STA. 486+00.00 TO STA. 417+00.00	F.A.P. RTE. 846 SECTION 4-N-3 COUNTY WILL TOTAL SHEETS 68 SHEET NO. 25 CONTRACT NO. 60L42 ILLINOIS FED. AID PROJECT
--	--	---	---	---	---