

RESTORATION OF WORK AREA. RESTORATION OF THE TRAFFIC SIGNAL WORK AREA SHALL BE INCIDENTAL TO THE RELATED PAY ITEM SUCH AS FOUNDATION, CONDUIT, HANDHOLE, TRENCH AND BACKFILL, ETC., AND NO EXTRA COMPENSATION SHALL BE ALLOWED. ALL ROADWAY SURFACES SUCH AS SHOULDERS, MEDIAN, SIDEWALKS, PAVEMENT, ETC. SHALL BE REPLACED IN KIND. ALL DAMAGE TO MOWED LAWNS SHALL BE REPLACED WITH AN APPROVED SOD, AND ALL DAMAGE TO UNMOWED FIELDS SHALL BE SEEDING IN ACCORDANCE WITH STANDARD SPECIFICATIONS 252 AND 250 RESPECTIVELY.

NOTE:  
 TOPO SOUTH OF STA. 485+00 WAS TRACED FROM AERIAL IMAGE FOR REFERENCE ONLY. THE EXISTING  $\phi$  TANGENT WAS EXTENDED TO STA. 468+88.49.

# IL. ROUTE 53

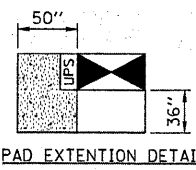
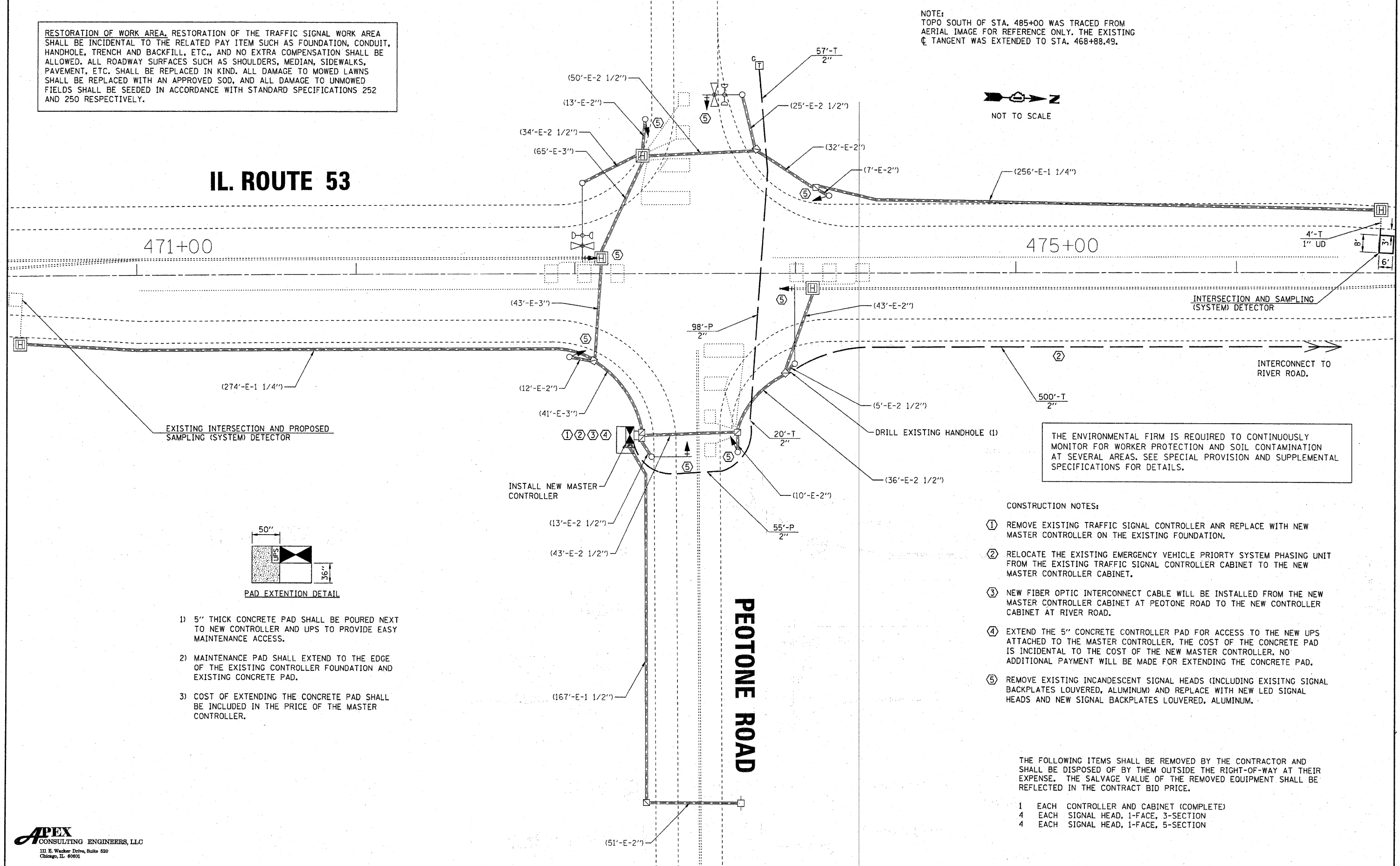
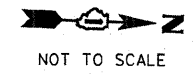

- 1) 5" THICK CONCRETE PAD SHALL BE POURED NEXT TO NEW CONTROLLER AND UPS TO PROVIDE EASY MAINTENANCE ACCESS.
- 2) MAINTENANCE PAD SHALL EXTEND TO THE EDGE OF THE EXISTING CONTROLLER FOUNDATION AND EXISTING CONCRETE PAD.
- 3) COST OF EXTENDING THE CONCRETE PAD SHALL BE INCLUDED IN THE PRICE OF THE MASTER CONTROLLER.

- CONSTRUCTION NOTES:
- ① REMOVE EXISTING TRAFFIC SIGNAL CONTROLLER ANR REPLACE WITH NEW MASTER CONTROLLER ON THE EXISTING FOUNDATION.
  - ② RELOCATE THE EXISTING EMERGENCY VEHICLE PRIORITY SYSTEM PHASING UNIT FROM THE EXISTING TRAFFIC SIGNAL CONTROLLER CABINET TO THE NEW MASTER CONTROLLER CABINET.
  - ③ NEW FIBER OPTIC INTERCONNECT CABLE WILL BE INSTALLED FROM THE NEW MASTER CONTROLLER CABINET AT PEOTONE ROAD TO THE NEW CONTROLLER CABINET AT RIVER ROAD.
  - ④ EXTEND THE 5" CONCRETE CONTROLLER PAD FOR ACCESS TO THE NEW UPS ATTACHED TO THE MASTER CONTROLLER. THE COST OF THE CONCRETE PAD IS INCIDENTAL TO THE COST OF THE NEW MASTER CONTROLLER. NO ADDITIONAL PAYMENT WILL BE MADE FOR EXTENDING THE CONCRETE PAD.
  - ⑤ REMOVE EXISTING INCANDESCENT SIGNAL HEADS (INCLUDING EXISITNG SIGNAL BACKPLATES LOUVERED, ALUMINUM) AND REPLACE WITH NEW LED SIGNAL HEADS AND NEW SIGNAL BACKPLATES LOUVERED, ALUMINUM.

THE FOLLOWING ITEMS SHALL BE REMOVED BY THE CONTRACTOR AND SHALL BE DISPOSED OF BY THEM OUTSIDE THE RIGHT-OF-WAY AT THEIR EXPENSE. THE SALVAGE VALUE OF THE REMOVED EQUIPMENT SHALL BE REFLECTED IN THE CONTRACT BID PRICE.

- 1 EACH CONTROLLER AND CABINET (COMPLETE)
- 4 EACH SIGNAL HEAD, 1-FACE, 3-SECTION
- 4 EACH SIGNAL HEAD, 1-FACE, 5-SECTION

**APEX**  
 CONSULTING ENGINEERS, LLC  
 111 E. Wacker Drive, Suite 620  
 Chicago, IL 60601

FILE NAME =	USER NAME = wingram	DESIGNED - WHI	REVISED -	<b>STATE OF ILLINOIS DEPARTMENT OF TRANSPORTATION</b>	<b>PROPOSED TRAFFIC SIGNAL MODIFICATION PLAN ILL ROUTE 53 AND PEOTONE ROAD</b>	F.A.P. RTE. 846	SECTION 4-N-3	COUNTY WILL	TOTAL SHEETS 68	SHEET NO. 39		
*FILEL*	PLOT SCALE = #SCALE*	CHECKED - DEB	REVISED -			SCALE: NONE SHEET NO. OF SHEETS STA. TO STA.		CONTRACT NO. 60L42				
	PLOT DATE = 8/9/2011	DATE - 8/2/2011	REVISED -			FED. ROAD DIST. NO. 1 ILLINOIS FED. AID PROJECT						