

PAVEMENT MARKING

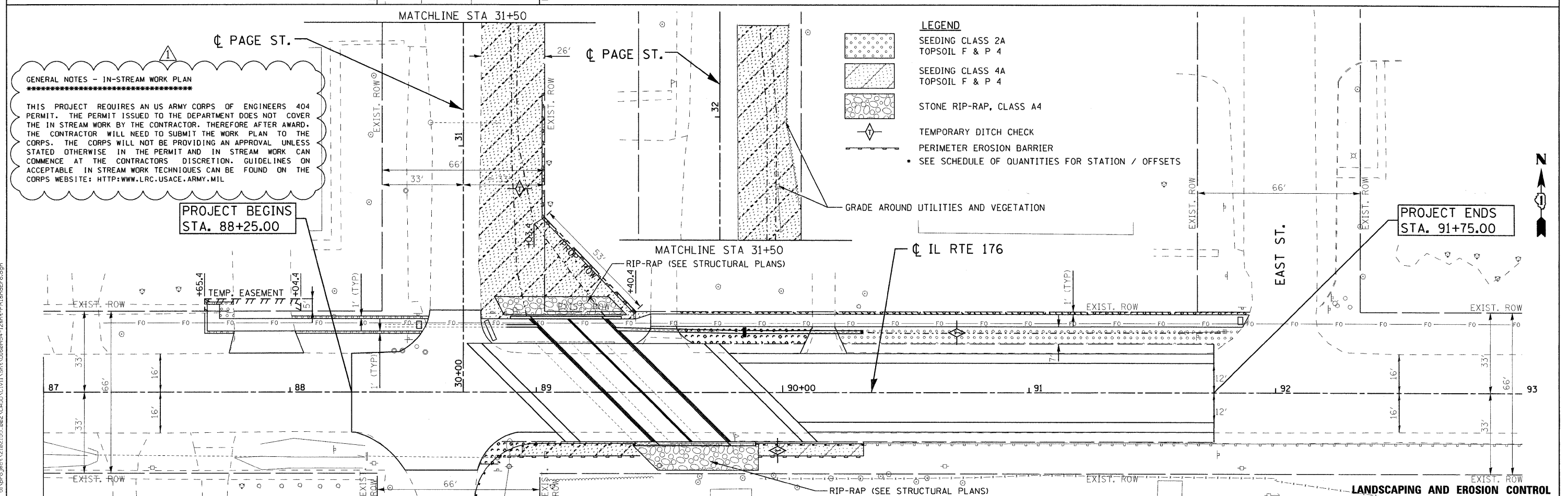

LANDSCAPING AND EROSION CONTROL

**GENERAL NOTES - IN-STREAM WORK PLAN**

THIS PROJECT REQUIRES AN US ARMY CORPS OF ENGINEERS 404 PERMIT. THE PERMIT ISSUED TO THE DEPARTMENT DOES NOT COVER THE IN STREAM WORK BY THE CONTRACTOR. THEREFORE AFTER AWARD, THE CONTRACTOR WILL NEED TO SUBMIT THE WORK PLAN TO THE CORPS. THE CORPS WILL NOT BE PROVIDING AN APPROVAL UNLESS STATED OTHERWISE IN THE PERMIT AND IN STREAM WORK CAN COMMENCE AT THE CONTRACTORS DISCRETION. GUIDELINES ON ACCEPTABLE IN STREAM WORK TECHNIQUES CAN BE FOUND ON THE CORPS WEBSITE: [HTTP://WWW.LRC.USACE.ARMY.MIL](http://www.LRC.USACE.ARMY.MIL)

	USER NAME = 2bookd	DESIGNED - DLP	REVISED - 11-07-11 REV.	<b>STATE OF ILLINOIS</b> <b>DEPARTMENT OF TRANSPORTATION</b>	<b>FAP ROUTE 533 (IL RTE 176) OVER DRAINAGE DITCH (EAST OF IL RTE 23)</b> <b>PAVEMENT MARKING, LANDSCAPING, AND EROSION CONTROL</b>	F.A.P. RTE. 533	SECTION 119-T-1	COUNTY McHENRY	TOTAL SHEETS 40	SHEET NO. 15
	PLOT SCALE = 20.00' / IN.	CHECKED - TMH	REVISOR -			SCALE: 1" = 20'	SHEET NO. OF SHEETS STA. TO STA.	IL ROUTE 176	CONTRACT NO. 60M54	
PLOT DATE = 11/7/2011	DATE = 04/07/11	REVISOR -	REVISOR -							

FILE NAME = G:\p\proj\2102155\_002\CA000\Civil\Sheet\0168M54-12\ht-rm\landEro.dgn