

**WB FACE OF PARAPET**

Location	Station	Offset	Theoretical Grade Elevations
W. End of Culvert	88+97.80	-30.00	807.33
B1	89+07.80	-30.00	807.39
B2	89+17.80	-30.00	807.43
E. End of Culvert	89+28.20	-30.00	807.46

**WB SHOULDER LINE**

Location	Station	Offset	Theoretical Grade Elevations
W. End of W. Appr. Pav't	88+77.80	-20.00	807.40
A1	88+87.80	-20.00	807.47
A2	88+97.80	-20.00	807.53
W. End of Culvert	89+07.80	-20.00	807.59
B1	89+17.80	-20.00	807.63
B2	89+27.80	-20.00	807.66
E. End of Culvert	89+38.20	-20.00	807.68
C1	89+48.20	-20.00	807.69
C2	89+58.20	-20.00	807.70
E. End of E. Appr. Pav't	89+68.20	-20.00	807.69

**WB LANE LINE**

Location	Station	Offset	Theoretical Grade Elevations
W. End of W. Appr. Pav't	88+85.80	-12.00	807.62
A1	88+95.80	-12.00	807.68
A2	89+05.80	-12.00	807.74
W. End of Culvert	89+15.80	-12.00	807.78
B1	89+25.80	-12.00	807.81
B2	89+35.80	-12.00	807.84
E. End of Culvert	89+46.20	-12.00	807.85
C1	89+56.20	-12.00	807.86
C2	89+66.20	-12.00	807.85
E. End of E. Appr. Pav't	89+76.20	-12.00	807.83

**ILLINOIS ROUTE 176**

Location	Station	Offset	Theoretical Grade Elevations
W. End of W. Appr. Pav't	88+97.80	0.00	807.87
A1	89+07.80	0.00	807.93
A2	89+17.80	0.00	807.97
W. End of Culvert	89+27.80	0.00	808.00
B1	89+37.80	0.00	808.02
B2	89+47.80	0.00	808.03
E. End of Culvert	89+58.20	0.00	808.04
C1	89+68.20	0.00	808.03
C2	89+78.20	0.00	808.01
E. End of E. Appr. Pav't	89+88.20	0.00	807.98

**EB LANE LINE**

Location	Station	Offset	Theoretical Grade Elevations
W. End of W. Appr. Pav't	89+09.80	12.00	807.75
A1	89+19.80	12.00	807.79
A2	89+29.80	12.00	807.82
W. End of Culvert	89+39.80	12.00	807.84
B1	89+49.80	12.00	807.85
B2	89+59.80	12.00	807.86
E. End of Culvert	89+70.20	12.00	807.85
C1	89+80.20	12.00	807.83
C2	89+90.20	12.00	807.80
E. End of E. Appr. Pav't	90+00.20	12.00	807.76

**EB FACE OF PARAPET**

Location	Station	Offset	Theoretical Grade Elevations
W. End of W. Appr. Pav't	89+17.80	20.00	807.63
A1	89+27.80	20.00	807.66
A2	89+37.80	20.00	807.68
W. End of Culvert	89+47.80	20.00	807.69
B1	89+57.80	20.00	807.70
B2	89+67.80	20.00	807.69
E. End of Culvert	89+78.20	20.00	807.67
C1	89+88.20	20.00	807.64
C2	89+98.20	20.00	807.61
E. End of E. Appr. Pav't	90+08.20	20.00	807.57

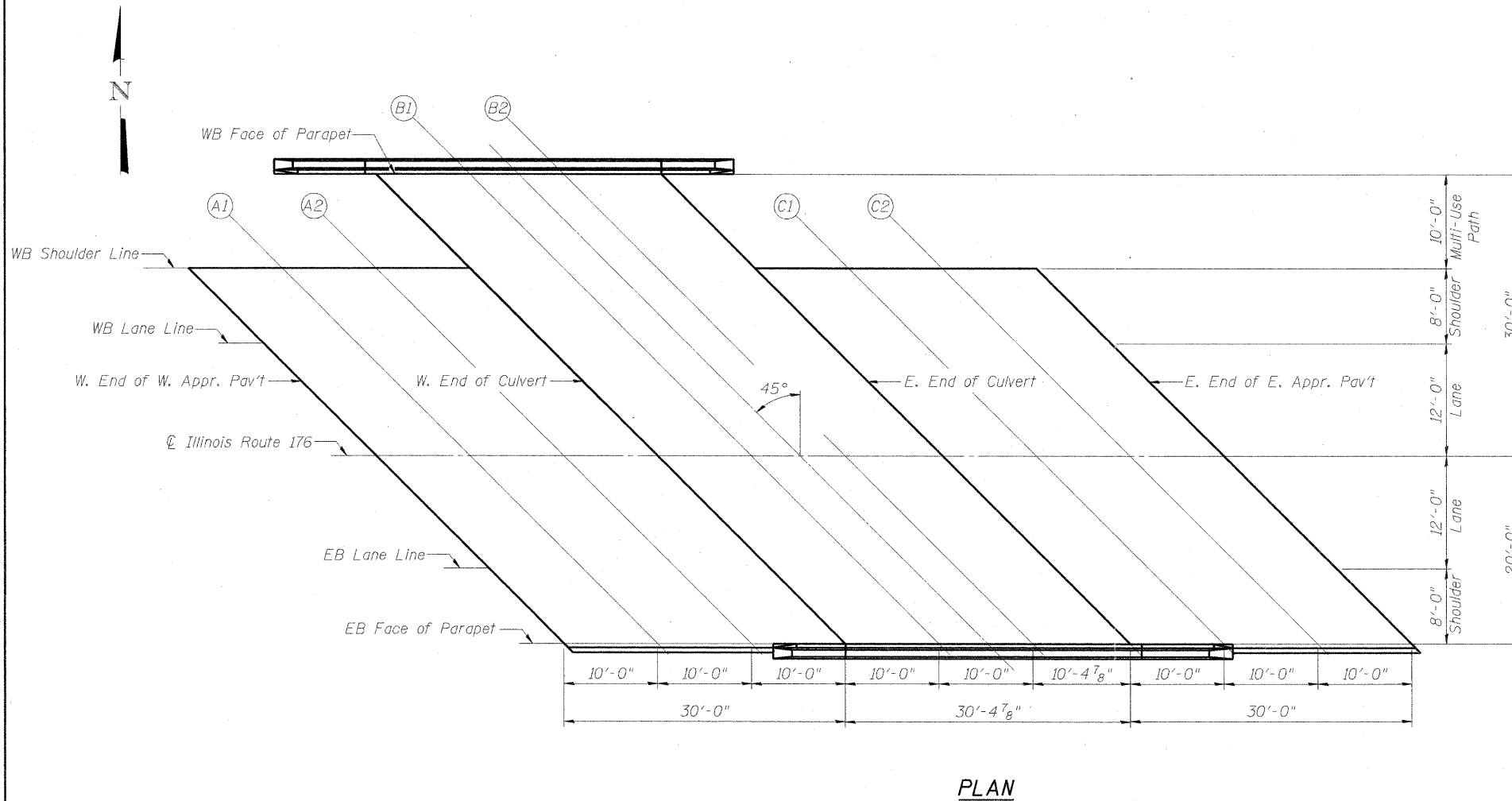

**PLAN**

FILE NAME = G:\projects\21021155\_002\CADD\Structure\Shl\WB560301-30M54-002-Top of Slab Elevations.dgn