

**STAGE I CROSS SECTION**  
(Looking North)

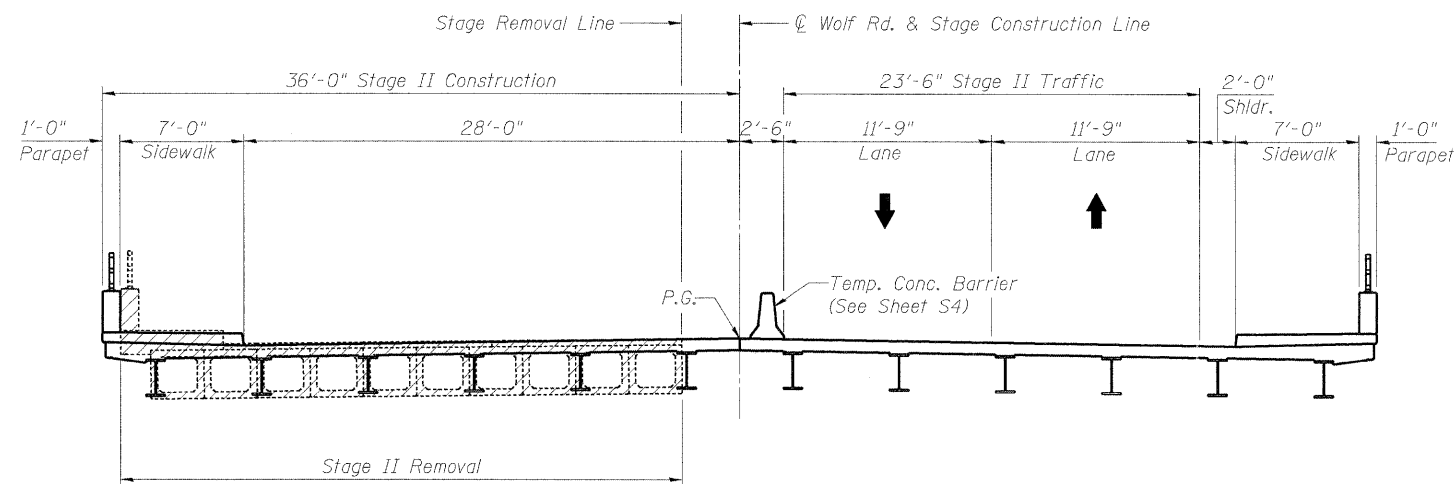

**STAGE II CROSS SECTION**  
(Looking North)

**TEMPORARY SHEET PILING**

If the Contractor chooses to alter the temporary cantilevered sheet piling design requirements shown on the plans, a design submittal including plan details and calculations will be required for review and acceptance by the Engineer.

FILE NAME = g:\project\2102195\_001\road\structure\sh1\B168650-60M2-003-Slagging.dgn



USER NAME = zpiend  
 PLOT SCALE = N/A  
 PLOT DATE = 9/12/2011

DESIGNED - BPS  
 CHECKED - BHS  
 DRAWN - BPS  
 CHECKED - BHS

REVISED -  
 REVISED -  
 REVISED -  
 REVISED -

**STATE OF ILLINOIS  
 DEPARTMENT OF TRANSPORTATION**

**STAGE CONSTRUCTION DETAILS  
 S.N. 016-0680**

SHEET NO. 53 OF 29 SHEETS

F.A.U. RTE.	SECTION	COUNTY	TOTAL SHEETS	SHEET NO.
2692	2011-205-F	COOK	17	5
CONTRACT NO. 60R35			ILLINOIS FED. AID PROJECT	

**FOR INFORMATION ONLY**