

F.A.P. RTE.	SECTION	COUNTY	TOTAL SHEETS	SHEET NO.
307	126N-1	KANE	156	1
ILLINOIS			CONTRACT NO. 62278	

STATE OF ILLINOIS
DEPARTMENT OF TRANSPORTATION
DIVISION OF HIGHWAYS
**PROPOSED
HIGHWAY PLANS**

FAP ROUTE 307 (IL 64)
SECTION 126N-1
AT IL 47
INTERSECTION IMPROVEMENTS

KANE COUNTY
C-91-326-01

FOR INDEX OF SHEETS, SEE SHEET NO. 2

TRAFFIC DATA
IL 64
EXISTING ADT = 5700 - 6200 (2009)
SPEED LIMIT = 45 MPH
IL 47
EXISTING ADT = 5600 - 7300 (2009)
SPEED LIMIT = 40 MPH

THE PROJECT IS LOCATED WITHIN THE VILLAGE OF LILY LAKE

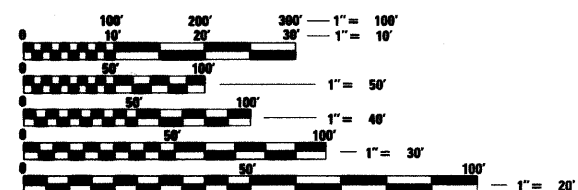

FULL SIZE PLANS HAVE BEEN PREPARED USING STANDARD ENGINEERING SCALES. REDUCED SIZED PLANS WILL NOT CONFORM TO STANDARD SCALES. IN MAKING MEASUREMENTS ON REDUCED PLANS, THE ABOVE SCALES MAY BE USED.

J.U.L.I.E.
JOINT UTILITY LOCATION INFORMATION FOR EXCAVATION
1-800-882-0123
OR 811

PROJECT ENGINEER: PETER JOHNSTON (GRAEF) 773-399-0112
PROJECT MANAGER: KEN ENG (IDOT) 847-705-4247

CONTRACT NO. 62278

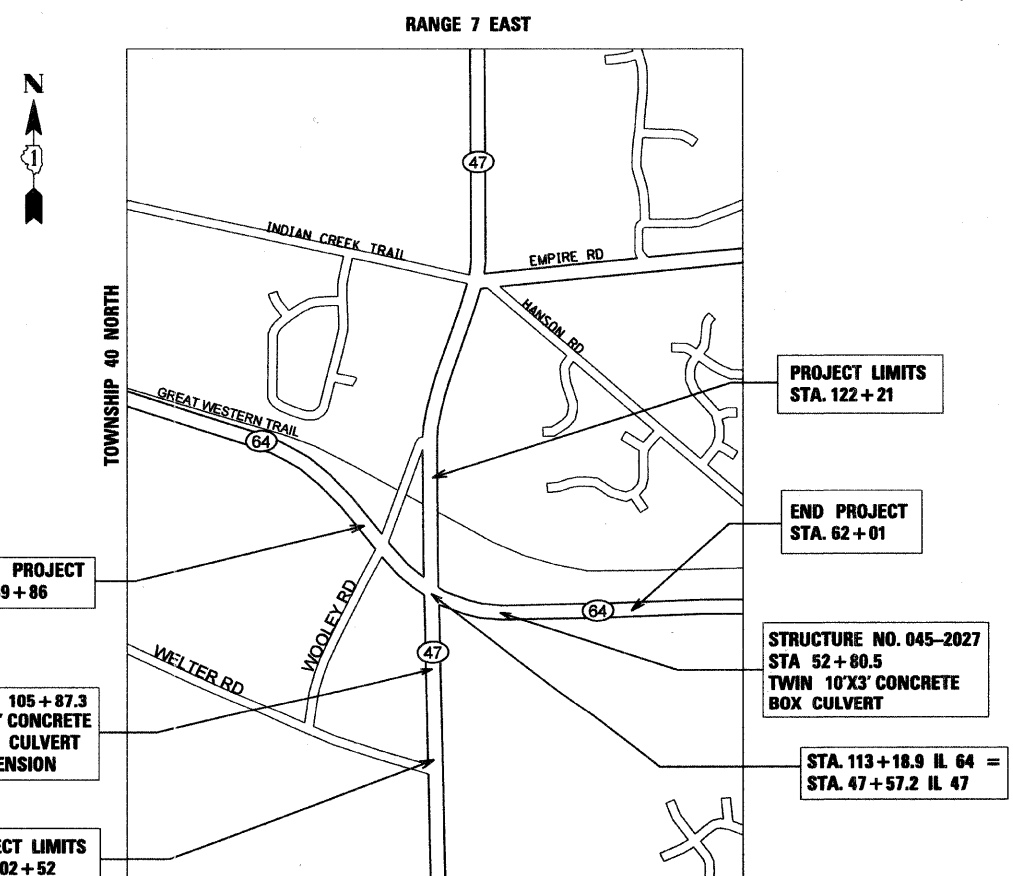

CAMPTON TOWNSHIP
GROSS & NET LENGTH OF (IL 64) = 2,224 FEET (0.42 MILES)
GROSS & NET LENGTH OF (IL 47) = 1,969 FEET (0.37 MILES)
GROSS & NET LENGTH OF PROJECT = 4,193 FEET (0.79 MILES)



Peter M. Johnston
8-17-11
DATE
LICENSE EXPIRES 11-30-2011

GRAEF 8501 W. Higgins Road, Suite 280
Chicago, Illinois 60631
(773) 399-0112

STATE OF ILLINOIS
DEPARTMENT OF TRANSPORTATION
DIVISION OF HIGHWAYS

SUBMITTED August 19, 2011

Diane M. D'Neef or
DEPUTY DIRECTOR OF HIGHWAYS, REGION ENGINEER

October 14, 2011

Scott E. Stitt, P.E. or
acting ENGINEER OF DESIGN AND ENVIRONMENT

October 14, 2011

Christine M. Reed or
DIRECTOR OF HIGHWAYS, CHIEF ENGINEER

**PRINTED BY THE AUTHORITY
OF THE STATE OF ILLINOIS**