

MOT LEGEND

- WORK ZONE
- TEMPORARY PAVEMENT, 10"
- DIRECTION OF TRAFFIC
- TYPE II BARRICADE OR DRUM WITH MONODIRECTIONAL FLASHING LIGHT AT 50' CENTERS
- TYPE III BARRICADE OR DRUM WITH MONODIRECTIONAL FLASHING LIGHTS
- SIGN
- EXISTING PAVEMENT MARKING TO REMAIN
- EXISTING PAVEMENT MARKING REMOVAL
- TEMPORARY PAVEMENT MARKING TAPE, TYPE III - 4" WHITE SOLID
- TEMPORARY PAVEMENT MARKING TAPE, TYPE III - DOUBLE 4" YELLOW SOLID
- TEMPORARY PAVEMENT MARKING TAPE, TYPE III - 24" WHITE
- STAGE CONSTRUCTION EDGE OF PAVEMENT
- TEMPORARY PAINT PAVEMENT MARKING - 4" WHITE SOLID
- TEMPORARY PAINT PAVEMENT MARKING - DOUBLE 4" YELLOW SOLID
- TEMPORARY PAINT PAVEMENT MARKING - 24" WHITE

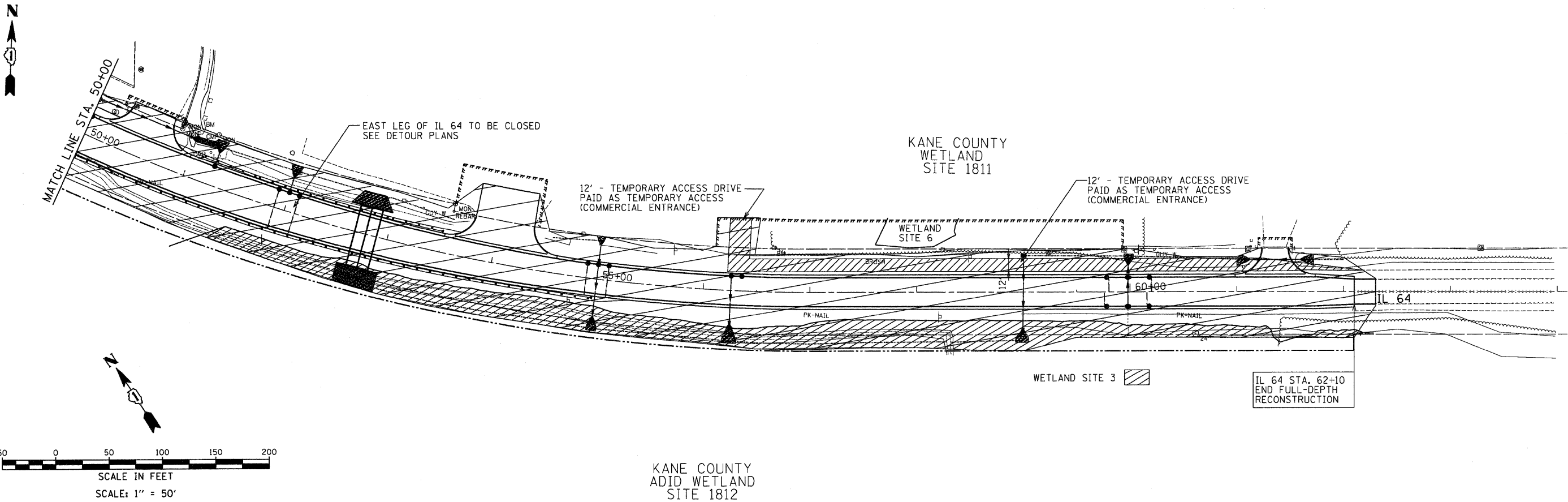

FILE NAME =	USER NAME = .USER.	DESIGNED - AR	REVISED -	STATE OF ILLINOIS DEPARTMENT OF TRANSPORTATION	IL 64 AT IL 47 INTERSECTION IMPROVEMENTS SUGGESTED MOT PLANS - STAGE 1	F.A.P. RTE. 307	SECTION 126N-1	COUNTY KANE	TOTAL SHEETS 156	SHEET NO. 38		
#FILE#		DRAWN - AR	REVISED -			SCALE: 50	SHEET NO. 1 OF 2 SHEETS	STA.	TO STA.	CONTRACT NO. 62278		
		CHECKED - RS	REVISED -			ILLINOIS FED. AID PROJECT						
		DATE - 09-01-2011	REVISED -									