

**NOTES**

1. SEE LANDSCAPE PLANS FOR DIRECTIONS RELATED TO SEEDING, SODDING, AND PLACEMENT OF RIPRAP, EROSION CONTROL BLANKET, AND TOPSOIL.
2. TEMPORARY EROSION CONTROL SEEDING SHALL BE PLACED OVER PROPOSED TOPSOIL LOCATIONS AT A RATE OF 100 POUNDS PER ACRE. SEE LANDSCAPE PLANS FOR TOPSOIL LOCATIONS.
3. EROSION CONTROL MEASURES INSTALLED IN PHASE 1 AND 2 SHALL REMAIN IN PLACE UNTIL PHASE 3 CONSTRUCTION IS COMPLETE AND WORK AREAS ARE STABILIZED.
4. USE OF STRAW BALES IS NOT PERMITTED.
5. STABILIZED CONSTRUCTION ENTRANCES/EXITS SHALL BE CONSTRUCTED WHERE SEDIMENT CAN BE TRACKED ONTO PUBLIC ROADS.
6. TEMPORARY CONCRETE WASHOUT FACILITIES SHALL BE PROVIDED TO PERMIT CONCRETE DELIVERY TRUCKS TO WASH OUT AT THE PROJECT SITE.
7. ALL MAINTENANCE OF ESC SYSTEMS SHALL BE THE RESPONSIBILITY OF THE CONTRACTOR.

**EROSION CONTROL LEGEND**

- WORK ZONE
- STONE RIPRAP, CLASS A4 W/ FILTER FABRIC
- TURF REINFORCEMENT MAT
- INLET FILTERS
- TEMPORARY DITCH CHECK
- PERIMETER EROSION BARRIER
- TEMPORARY FENCE

SEE IL 47 EROSION CONTROL STAGE 2 PLANS

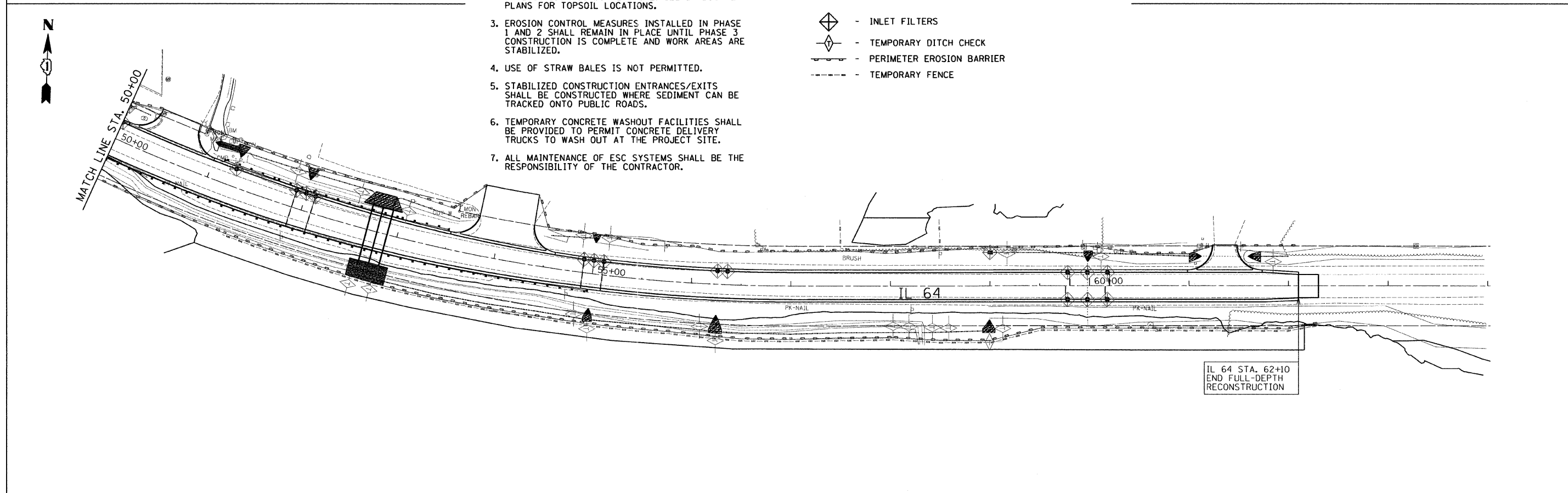

FILE NAME =	USER NAME = .USER	DESIGNED - AR	REVISED -	<b>STATE OF ILLINOIS DEPARTMENT OF TRANSPORTATION</b>	<b>IL 64 AT IL 47 INTERSECTION IMPROVEMENTS EROSION CONTROL PLANS - STAGE 2</b>	F.A.P. RTE.	SECTION	COUNTY	TOTAL SHEETS	SHEET NO.	
#FILE#	10-12-2011	DRAWN - AR	REVISED -			307	126N-1	KANE	156	49	
	PLOT SCALE = 50.0000' / IN.	CHECKED - RS	REVISED -			CONTRACT NO. 62278					
	PLOT DATE = 10/11/2011	DATE - 09-01-2011	REVISED -			ILLINOIS FED. AID PROJECT					
					SCALE: 50	SHEET NO. 1 OF 2 SHEETS		STA.	TO STA.		