

ROUTE NO.	SECTION	COUNTY	TOTAL SHEETS	SHEET NO.
FAP 307	126N-1	KANE		155
ILLINOIS				

Sheet 2 of 3

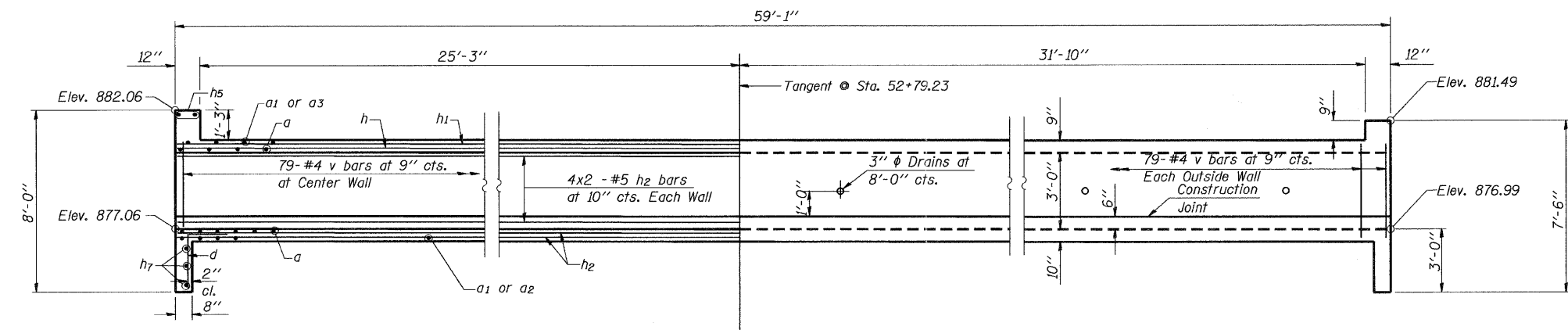

HALF LONG SECTION
Showing bars in Center Wall

(Looking East)

HALF ELEVATION
Showing bars in Outside Wall

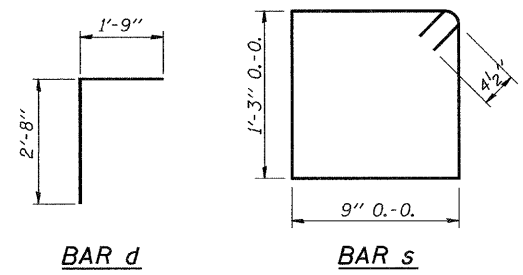

BAR d

BAR s

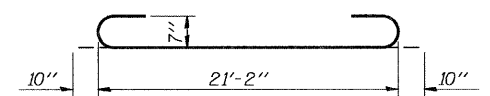

BAR a

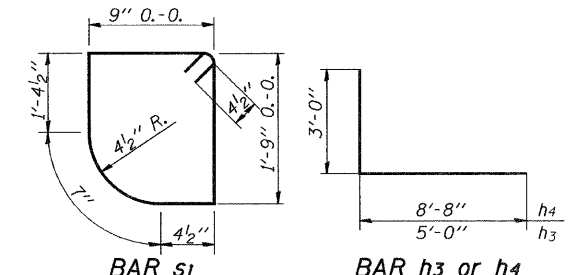

BAR s1

BAR h3 or h4

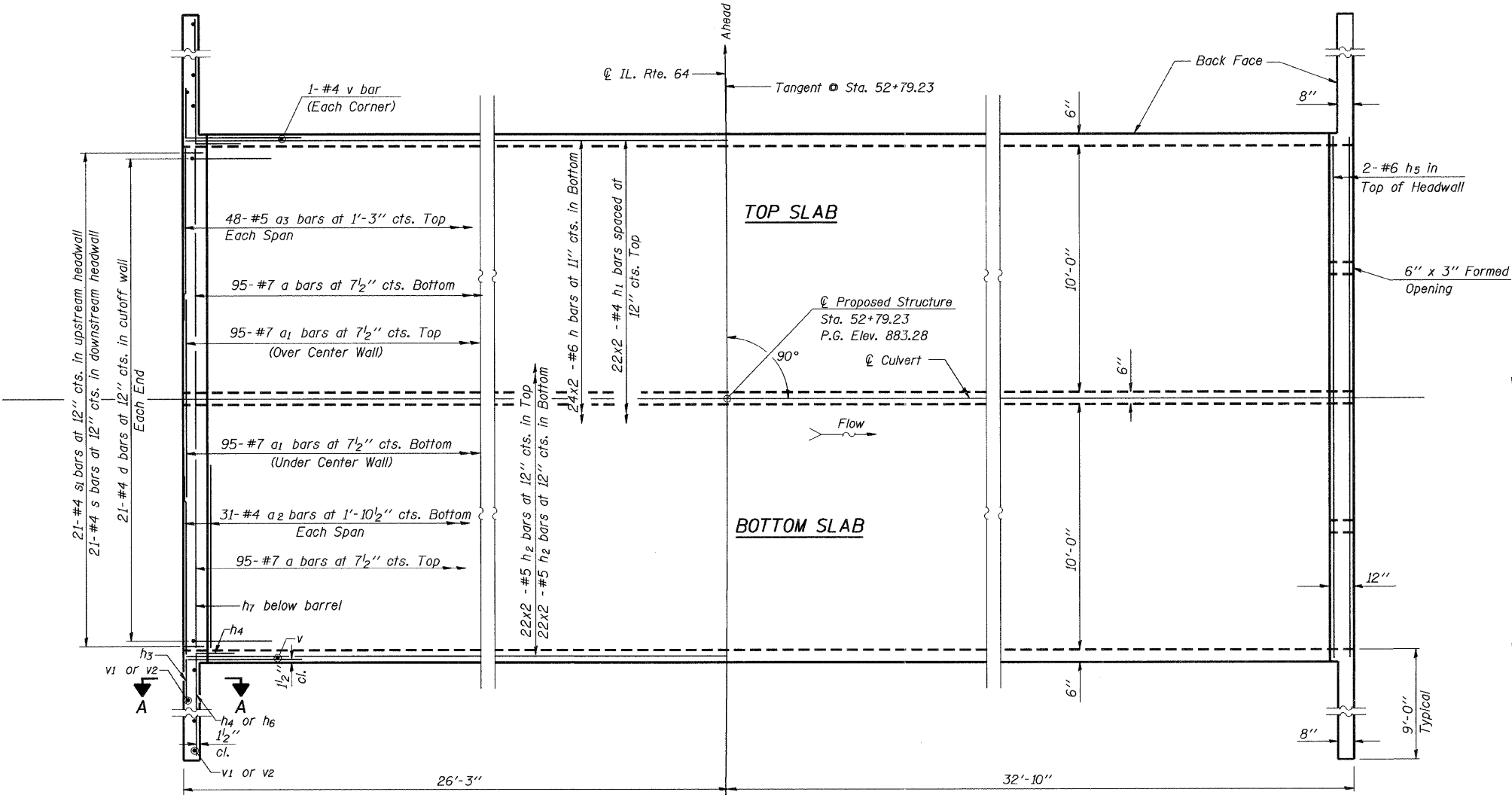

SHOWING REINFORCEMENT

SHOWING OUTLINES

PLAN

Bars indicated thus 12 x 4 #5 etc. indicates 12 lines of bars with 4 lengths per line.

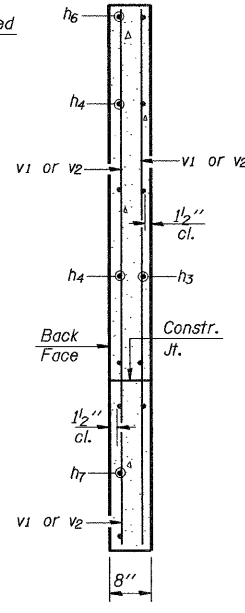

SECTION A-A

BILL OF MATERIAL

Bar	No.	Size	Length	Shape
a	190	#7	22'-10"	C
a1	190	#7	11'-10"	—
a2	62	#4	6'-1"	—
a3	96	#5	6'-6"	—
d	42	#4	4'-5"	—
h	48	#6	30'-6"	—
h1	44	#4	30'-1"	—
h2	112	#5	30'-3"	—
h3	16	#6	8'-0"	L
h4	24	#6	11'-8"	L
h5	4	#6	21'-2"	—
h6	4	#6	11'-3"	—
h7	12	#6	20'-6"	—
v	241	#4	4'-3"	—
v1	8	#4	7'-2"	—
v2	8	#4	7'-8"	—
s	21	#4	4'-9"	—
s1	21	#4	5'-7"	—
Concrete Box Culverts			Cu. Yd.	94.7
Reinforcement Bars			Pound	23,200
Name Plates			Each	1

DESIGNED	F.J.S.
CHECKED	S.F.M.
DRAWN	D.E.G. & K.T.R.
CHECKED	A.R.K. & S.F.M.

MINIMUM BAR LAP

- #4 - 1'-4"
- #5 - 1'-8"
- #6 - 2'-0" (Barrel)
- #6 - 2'-9" (Wing)
- #7 - 2'-11"

CULVERT DETAILS
F.A.P. RTE. 307-IL. RTE. 64
TRIBUTARY TO FERSON CREEK
SECTION 126N-1
KANE COUNTY
STATION 52+79.23
STRUCTURE NO. 045-2027