

IMPORTANT!

FULL SIZE PLANS HAVE BEEN PREPARED USING STANDARD ENGINEERING SCALES. REDUCED SIZED PLANS WILL NOT CONFORM TO STANDARD SCALES INDICATED IN TITLE BLOCK.

THERMOPLASTIC STRIPING CODE

- (A) PROPOSED DOUBLE SOLID YELLOW THERMOPLASTIC PAVEMENT MARKING - CENTER LINE 4", 11" O/C
- (B) PROPOSED SKIP-DASH YELLOW THERMOPLASTIC PAVEMENT MARKING - LINE 4" - 3' DASH, 9' SKIP (PATHWAY LANE LINE)
- (C) PROPOSED SOLID WHITE THERMOPLASTIC PAVEMENT MARKING - LINE 4" (PARKING STALL)
- (D) PROPOSED SOLID WHITE THERMOPLASTIC PAVEMENT MARKING - LINE 6" (EDGE)
- (E) PROPOSED SOLID WHITE THERMOPLASTIC PAVEMENT MARKING - LINE 6" (CROSSWALK)
- (F) PROPOSED SOLID WHITE THERMOPLASTIC PAVEMENT MARKING - LINE 12" (CROSSWALK)
- (G) PROPOSED SOLID WHITE THERMOPLASTIC PAVEMENT MARKING - LINE 24" (STOP BAR)
- (H) PROPOSED SOLID WHITE THERMOPLASTIC PAVEMENT MARKING - LETTERS & SYMBOLS

PAINTED STRIPING CODE

- (I) PROPOSED SOLID WHITE PAINTED PAVEMENT MARKING - LETTERS & SYMBOLS

* DENOTES INLET FILTER TO BE INSTALLED

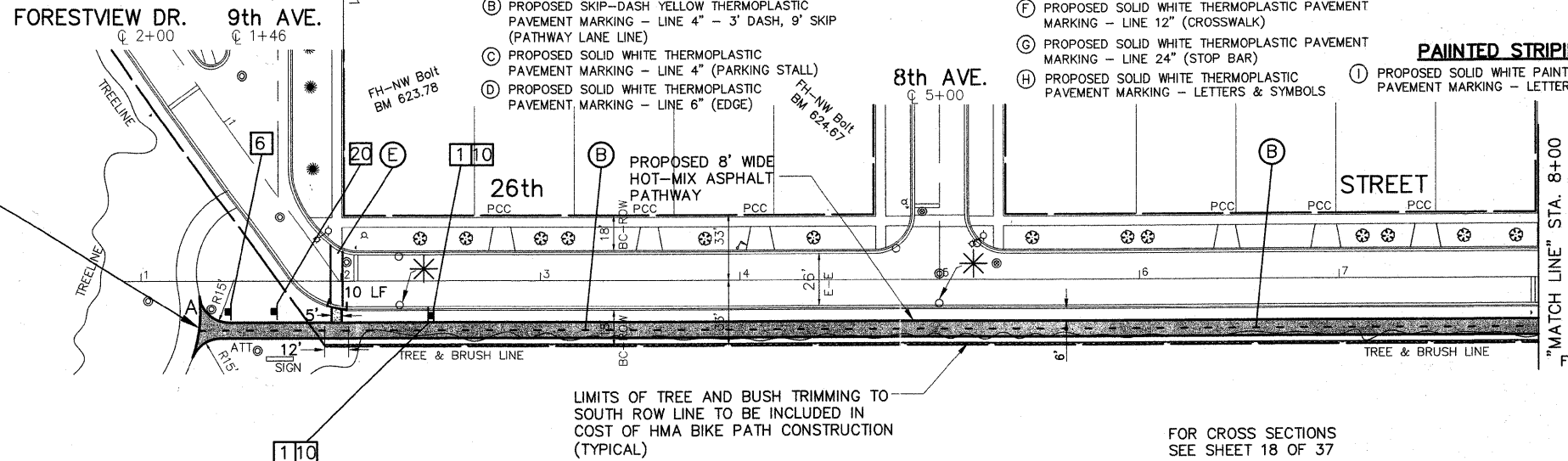

FOR CONTINUATION SEE BELOW LEFT

LIMITS OF TREE AND BUSH TRIMMING TO SOUTH ROW LINE TO BE INCLUDED IN COST OF HMA BIKE PATH CONSTRUCTION (TYPICAL)

FOR CROSS SECTIONS SEE SHEET 18 OF 37

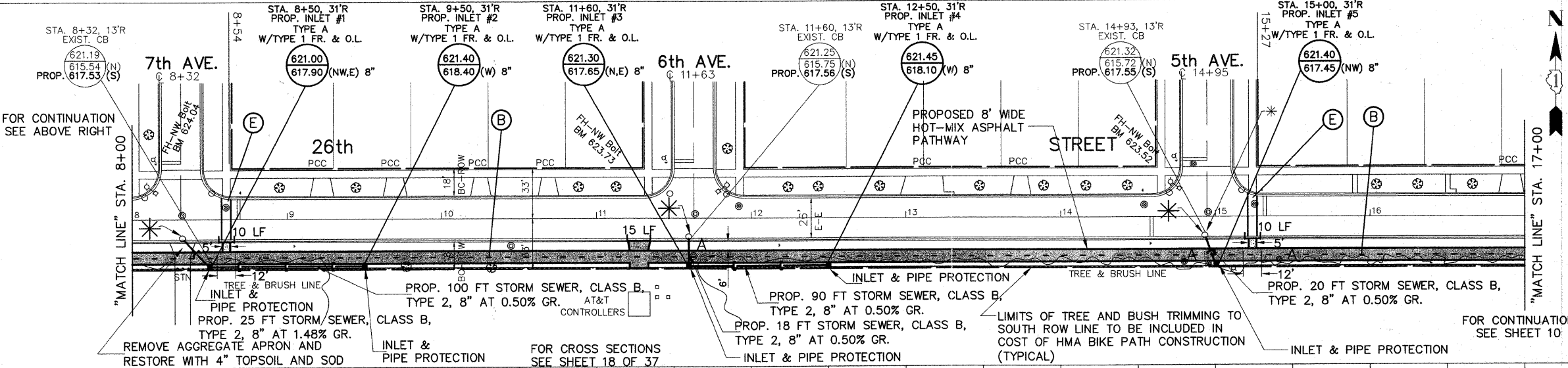
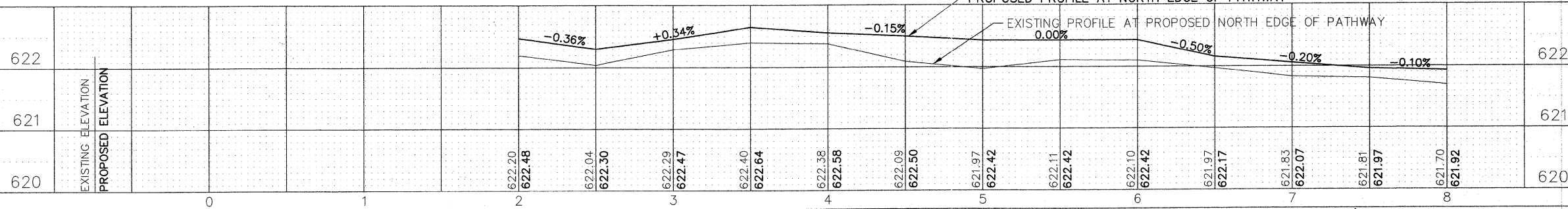

FOR CONTINUATION SEE ABOVE RIGHT

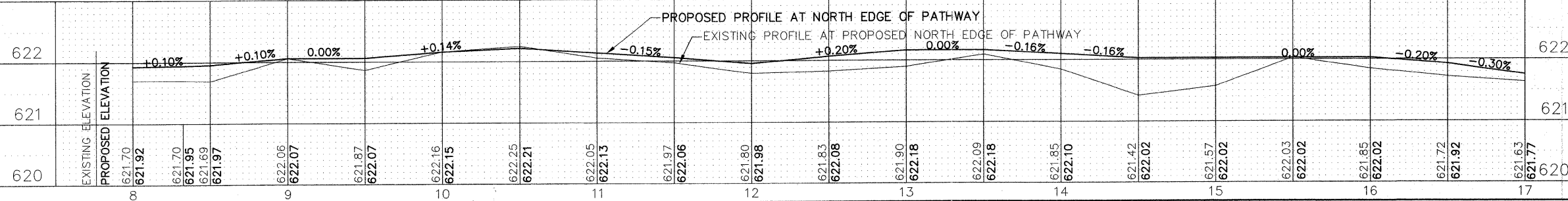

- LEGEND**
- DENOTES EARTH EXCAVATION, AND/OR SIDEWALK REMOVAL, GEOTECHNICAL FABRIC FOR GROUND STABILIZATION, AGGREGATE BASE COURSE, TYPE B, 6 INCH, HOT-MIX ASPHALT BINDER COURSE, IL-19.0, N50, 2 INCH AND HOT-MIX ASPHALT SURFACE COURSE, MIX C, N50, 1-1/2 INCH
 - DENOTES HOT-MIX ASPHALT SURFACE REMOVAL, VARIABLE DEPTH, LEVELING BINDER (MACHINE METHOD), N50, 1 INCH AVG., AREA RELECTIVE CRACK CONTROL TREATMENT, SYSTEM A AND HOT-MIX ASPHALT SURFACE COURSE, MIX C, N50, 2 INCH
 - DENOTES EARTH EXCAVATION, AND/OR PAVEMENT REMOVAL, GEOTECHNICAL FABRIC FOR GROUND STABILIZATION, SUBBASE GRANULAR MATERIAL TYPE B, 4 INCH, HOT-MIX ASPHALT BASE COURSE, 6 INCH, HOT-MIX ASPHALT BINDER COURSE, IL-19.0, N50, 2-1/4 INCH AND HOT-MIX ASPHALT SURFACE COURSE, MIX C, N50, 2 INCH
 - AREA RELECTIVE CRACK CONTROL TREATMENT, SYSTEM A, HOT-MIX ASPHALT SURFACE COURSE, MIX C, N50, 2 INCH
 - DENOTES HOT-MIX ASPHALT SURFACE REMOVAL, 2 INCH, AREA RELECTIVE CRACK CONTROL TREATMENT, SYSTEM A, HOT-MIX ASPHALT SURFACE COURSE, MIX C, N50, 2 INCH
 - DENOTES CLASS D PATCHES, TYPE II - IV, 8 INCH - AS DIRECTED AT LOCATIONS DIRECTED BY THE ENGINEER AFTER PROOF ROLLING
 - DENOTES HOT-MIX ASPHALT DRIVEWAY REMOVAL AND REPLACEMENT, 3 INCH
 - DENOTES P.C. SIDEWALK REMOVAL
 - DENOTES PORTLAND CEMENT CONCRETE SIDEWALK, 5 INCH
 - DENOTES DETECTABLE WARNING PER I.D.O.T. STANDARD 424001-05 FOR HANDICAP RAMPS
 - "A" DENOTES EXISTING VALVE VAULTS, VALVE BOXES, CATCH BASINS, VALVE VAULTS, HANDHOLES AND MANHOLES TO BE CLEANED, GROUTED, AND ADJUSTED TO GRADE WITH NEW ADJUSTING RINGS. (ALL TOP BANDS OF FALLEN, COMMON OR CONCRETE BRICK TO BE REPLACED WITH PRECAST CONCRETE ADJUSTING RINGS)
 - "S" DENOTES EXISTING FRAMES AND LIDS TO BE ADJUSTED (SPECIAL)
 - 8 FT DENOTES COMBINATION CONCRETE CURB & GUTTER REMOVAL AND REPLACEMENT PROVIDE DETECTABLE WARNINGS AND RAMPS AT ALL SIDEWALK
 - X DENOTES "TREE REMOVAL"

PROPOSED SIGN SCHEDULE

	EROSION CONTROL LEGEND		
	TEMPORARY DITCH CHECK		
	EROSION CONTROL BLANKET		
	PERIMETER EROSION BARRIER - SILT FILTER FENCE OR OTHER AS APPROVED BY THE ENGINEER		
	INLET AND PIPE PROTECTION EROSION BARRIER, STRAW BALES		
	SEDIMENT BASIN		
	DRAINAGE STRUCTURE		
	INLET FILTER		

NOTE: ALL ITEMS SHALL BE CONSTRUCTED AS SHOWN ON STANDARD 280001 AND AS DIRECTED BY THE ENGINEER. MAINTENANCE AND CLEANING OF THE EROSION CONTROL ITEMS SHALL BE INCLUDED IN THE RESPECTIVE EROSION CONTROL PAY ITEM.

FILE NAME: VILLAGE WIDE BIKE PATH - STAGE 2
 FAU RTE. 1459 (26TH STREET), FAU 2759
 (DESPLAINES AVENUE), VILLAGE COMMONS
 HANSWORTH AVENUE, 25TH STREET AND VETERANS
 PARK FROM FORESTVIEW AVENUE TO VETERAN DRIVE

USER NAME =
 DESIGNED - THK
 DRAWN - JFP-JEP
 CHECKED - THK
 DATE - 1-29-10

REVISED - THK 3-09-10
 REVISED - THK 4-06-10
 REVISED -
 REVISED -

STATE OF ILLINOIS
 DEPARTMENT OF TRANSPORTATION

PLAN & PROFILE:
 26th STREET - (BIKE PATH) 9th AVE. TO STA. 17+00
 SCALE: SHEET NO. OF SHEETS STA. TO STA.

Frank Novotny & Associates, Inc.
 625 Midway Drive • Willowbrook, IL • 60187 • Telephone: (630) 887-8640 • Fax: (630) 887-0132
 ILLINOIS PROFESSIONAL DESIGN FIRM NO. 184-000298

F.A. RTE.	SECTION	COUNTY	TOTAL SHEETS	SHEET NO.
VAR	06-00080-01-BT	COOK	37	9
CONTRACT NO. 63461				
FED. ROAD DIST. NO. ILLINOIS FED. AID PROJECT HPP-3463(006)				