

DATE	
BY	
FINAL SURVEY	
SURVEYED	
PLOTTED	
NOTE BOOK	
NO.	
AREAS CHECKED	

DATE	
BY	
ORIGINAL SURVEY	
SURVEYED	
PLOTTED	
NOTE BOOK	
NO.	
AREAS CHECKED	

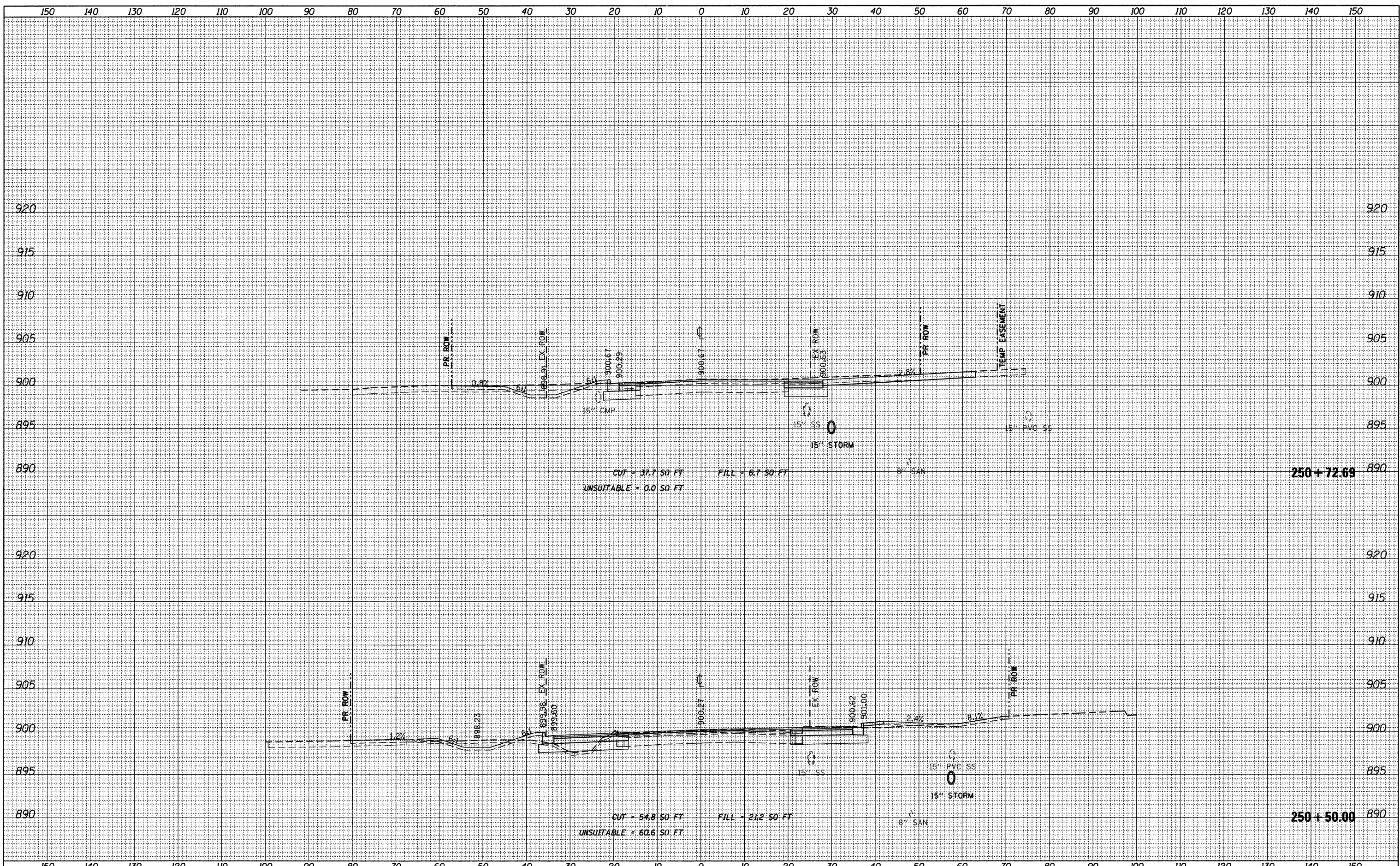

FILE NAME = F:\396-064 P\rgree Road\CADD\Sheets\ldot Form\10163519_Rickert.dgn

USER NAME = cesario
 DESIGNED *BD*
 DRAWN *JPS*
 CHECKED *BD*
 PLOT DATE = 9/14/2011

REVISIONS
 REVISED -
 REVISED -
 REVISED -
 REVISED -

**STATE OF ILLINOIS
 DEPARTMENT OF TRANSPORTATION**

RICKERT ROAD CROSS SECTIONS
 1"=10' HORIZ.
 SCALE: 1"=5' VERT. SHEET NO. 89 OF 92 SHEETS STA. 250+50.00 TO STA. 250+72.69

F.A.U. RTE.	SECTION	COUNTY	TOTAL SHEETS	SHEET NO.
126	95-00090-01-FP	MCHENRY	92	89
ILLINOIS FED. AID PROJECT			CONTRACT NO. 63519	