

COPYRIGHT © 2011 BY BAXTER & WOODMAN, INC. ALL RIGHTS RESERVED. NO PART OF THIS DRAWING IS TO BE REPRODUCED OR TRANSMITTED IN ANY FORM OR BY ANY MEANS, ELECTRONIC OR MECHANICAL, INCLUDING PHOTOCOPYING, RECORDING, OR BY ANY INFORMATION STORAGE AND RETRIEVAL SYSTEM. WITHOUT PERMISSION IN WRITING FROM BAXTER & WOODMAN, INC. PROJECT NO. 110025-TS-WILLOW-WEST. SHEET NO. 21 OF 21. DATE: 3/1/2011.

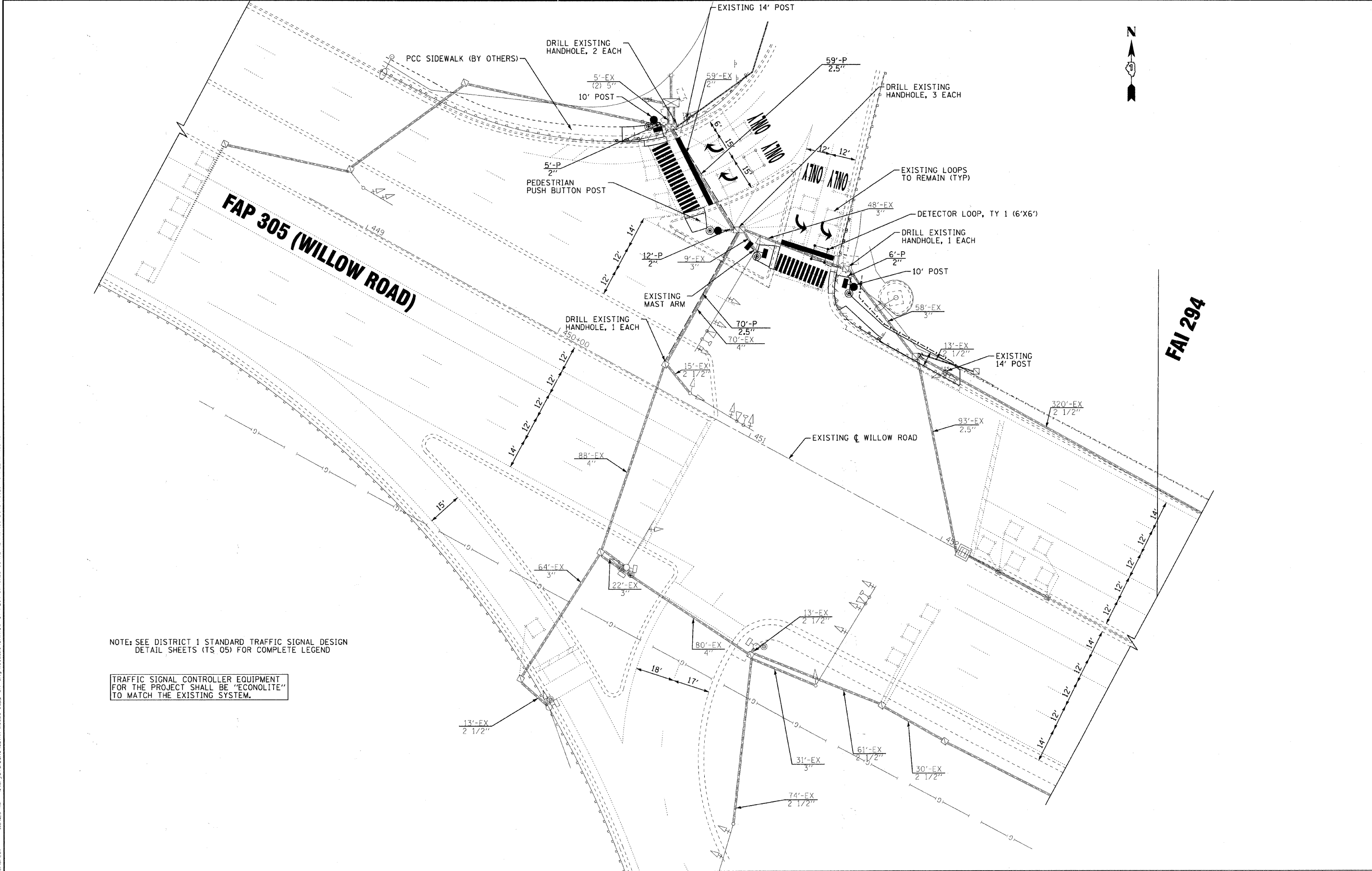

NOTE: SEE DISTRICT 1 STANDARD TRAFFIC SIGNAL DESIGN DETAIL SHEETS (TS 05) FOR COMPLETE LEGEND

TRAFFIC SIGNAL CONTROLLER EQUIPMENT FOR THE PROJECT SHALL BE "ECONOLITE" TO MATCH THE EXISTING SYSTEM.



DESIGNED - CSK	REVISED - PER IDOT COMMENTS 6-20-11
DRAWN - RKM	REVISED - PER ISTHA COMMENTS 6-20-11
CHECKED - TLH	REVISED - PER IDOT & ISTHA COMMENTS 8-30-11
DATE - 3-1-2011	FILE - 110025-TS-WILLOW-WEST.SH

VILLAGE OF GLENVIEW, ILLINOIS
F.A.P. 305 (WILLOW ROAD) SIDEWALK IMPROVEMENTS

TRAFFIC SIGNAL INSTALLATION PLAN
F.A.P. 305 WILLOW ROAD AT I-294 SB EXIT RAMP

SCALE: 1" = 20' STA. TO STA.

F.A.P. RTE. 305	SECTION 11-00177-00-SW	COUNTY COOK	TOTAL SHEETS 21	SHEET NO. 9
JOB No. C-91-448-11		CONTRACT NO. 63606		
FED. ROAD DIST. NO. 1 ILLINOIS FED. AID PROJECT TE-00018591				